

- NOTES:**
- SPECIFIED SNOW LOAD AS NOTED ON PLAN.
 - SPECIFIED SERVICE LOAD = 1 kPa
 - SEE DRAWING WB-S5451 FOR PRECAST DETAILS.
 - SEE DETAIL 3 TO SUPPORT LIGHT FIXTURES, INSTALLED UNDER SEPARATE CONTRACT.
 - PROVIDE 20mm DIA SLEEVES IN ALL DOUBLE TEE STEMS 1200mm C/C.
 - PROVIDE GALVANIZED STEEL SLEEVES FOR THROUGH BOLTS.
 - COORDINATE WITH CONTRACT ADMINISTRATOR LOCATION OF ALL THROUGH BOLTS (BO 742-2005)
 - MISCELLANEOUS STEEL AND CRANE MANUFACTURER SHALL PROVIDE INSTALLATION TEMPLATES TO THE PRECAST MANUFACTURER.

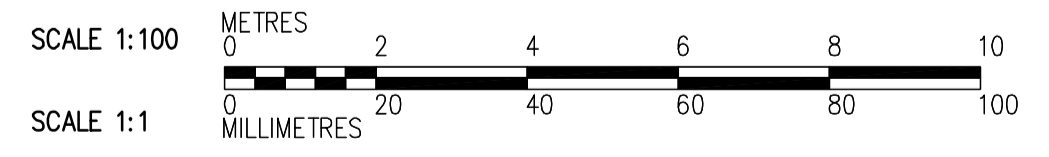
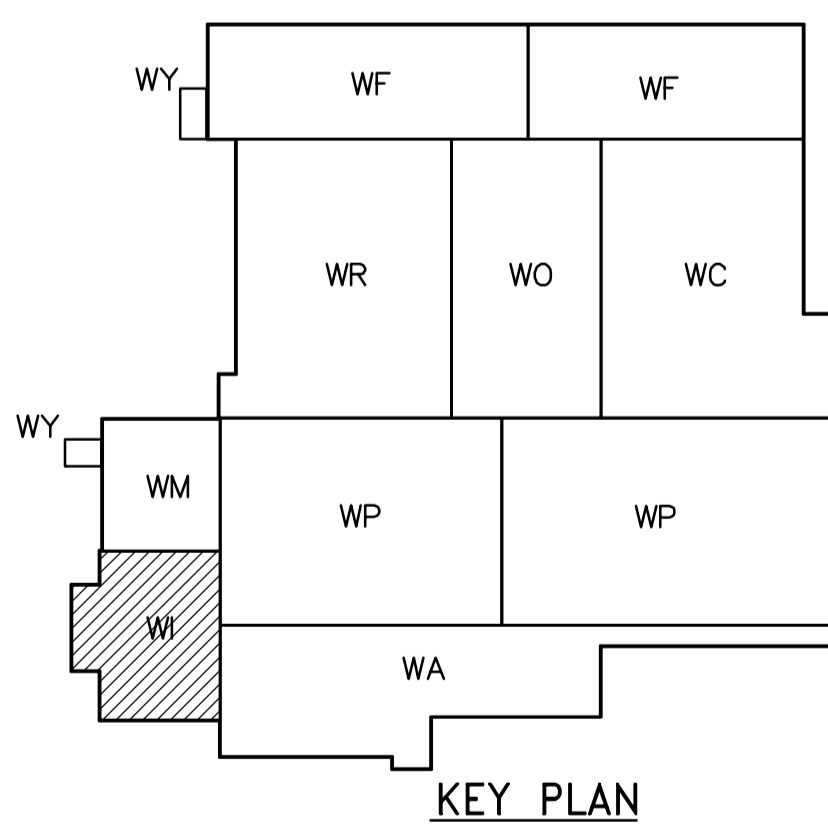

ROOF PLAN
1:100

APECA
Certificate of Authorization
CH2M HILL Canada Ltd.
No. 1441 Expiry: April 30, 2007

B.M. ELEV.			
00 ISSUED FOR TENDER	06/10/11	DK	
NO. REVISIONS	DATE	BY	DATE
	2006/08/30		2006/10/11

CH2MHILL
Frederickson Cooper ARCHITECTS

EarthTech
A 100 International Ltd. Company

DESIGNED BY	MH	CHECKED BY	AP
DRAWN BY	CR	APPROVED BY	AHL
SCALE:	1:100	RELEASED FOR CONSTRUCTION BY:	R. SOROKOWSKI

ENGINEER'S SEAL
ORIGINAL SIGNED BY
D. KRUGER
2006/10/11
CONSULTANT DRAWING NO.
WI-S5146

THE CITY OF WINNIPEG
WATER AND WASTE DEPARTMENT
ENGINEERING DIVISION

WATER TREATMENT PLANT
INLET WORKS & RAW WATER PUMPING
SUPPLY AND INSTALLATION OF PRECAST ROOF PANELS

STRUCTURAL
RAW WATER PUMP STATION AREA
ROOF PLAN

CITY FILE NUMBER
SHEET OF
CITY DRAWING NUMBER
1-06011-A-S5146-001-000