

NOTES:

1. SPECIFIED SNOW LOAD AS NOTED ON PLAN.
2. SPECIFIED SERVICE LOAD = 1 kPa
3. SEE DRAWING WB-S5451 FOR PRECAST DETAILS.
4. SEE DETAIL (3) WB-S5451 TO SUPPORT LIGHT FIXTURES, INSTALLED UNDER SEPARATE CONTRACT.
5. PROVIDE 20mm DIA SLEEVES IN ALL DOUBLE TEE STEMS 1200mm C/C.
6. PROVIDE GALVANIZED STEEL SLEEVES FOR THROUGH BOLTS.
7. COORDINATE WITH CONTRACT ADMINISTRATOR LOCATION OF ALL THROUGH BOLTS (BO 742-2005)
8. MISCELLANEOUS STEEL AND CRANE MANUFACTURER SHALL PROVIDE INSTALLATION TEMPLATES TO THE PRECAST MANUFACTURER.

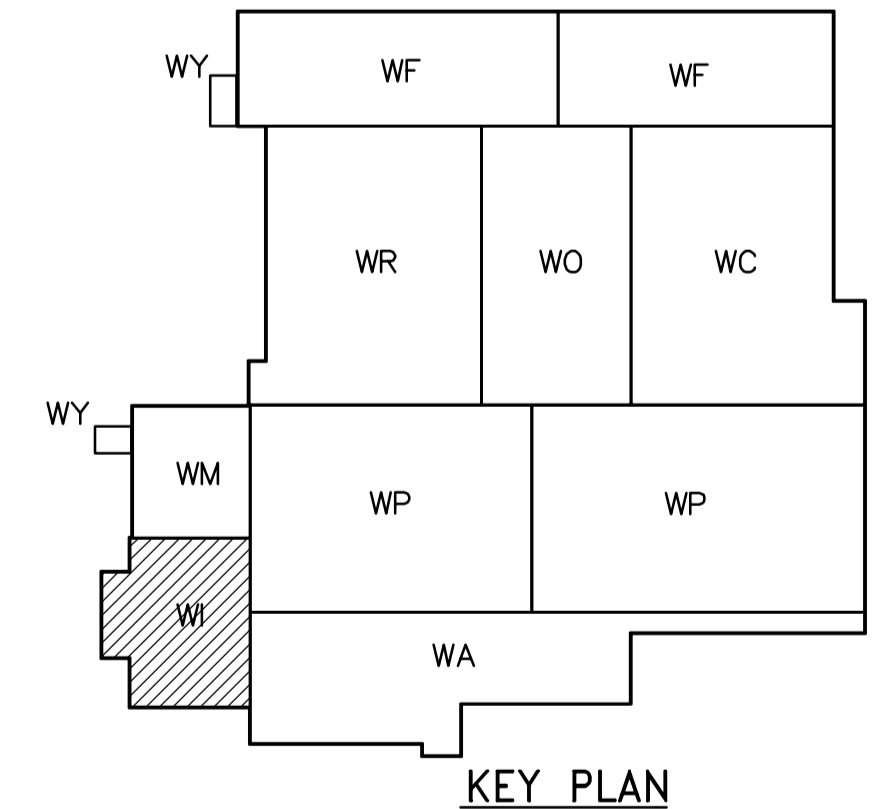

ROOF PLAN
1:100

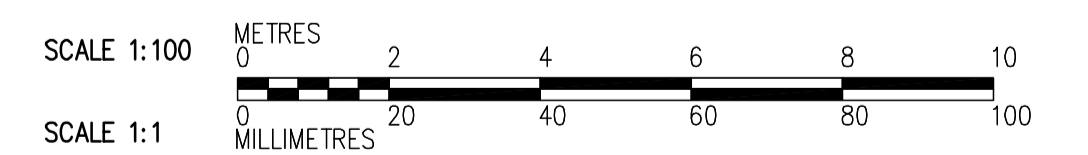

 Certificate of Authorization CH2M HILL Canada Ltd. No. 1441 Expiry: April 30, 2007	B.M. ELEV.	 Frederickson Cooper ARCHITECTS	 EarthTech	ENGINEER'S SEAL ORIGINAL SIGNED BY D. KRUGER 2006/10/11	 THE CITY OF WINNIPEG WATER AND WASTE DEPARTMENT ENGINEERING DIVISION
	01 171-2006 ADDENDUM 2 06/11/28 DK 00 ISSUED FOR TENDER 06/10/11 DK	DESIGNED BY MH CHECKED BY AP DRAWN BY CR APPROVED BY AHL	CONSULTANT DRAWING NO. WI-S5146		WATER TREATMENT PLANT INLET WORKS & RAW WATER PUMPING SUPPLY AND INSTALLATION OF PRECAST ROOF PANELS
	INO. REVISIONS DATE BY	SCALE: 1:100 RELEASED FOR CONSTRUCTION BY: R. SOROKOWSKI	STRUCTURAL RAW WATER PUMP STATION AREA ROOF PLAN		CITY FILE NUMBER SHEET OF CITY DRAWING NUMBER 1-06011-A-S5146-001-01D