

A1 SIZE 23.4" x 33.1" (594mm x 841mm)

PLOT: 05/04/11 8:30:33 PM

# RAILWAY PROFILE

TOP OF LOWER RAIL ELEVATION SHOWN IN PROFILE FOR CLARITY

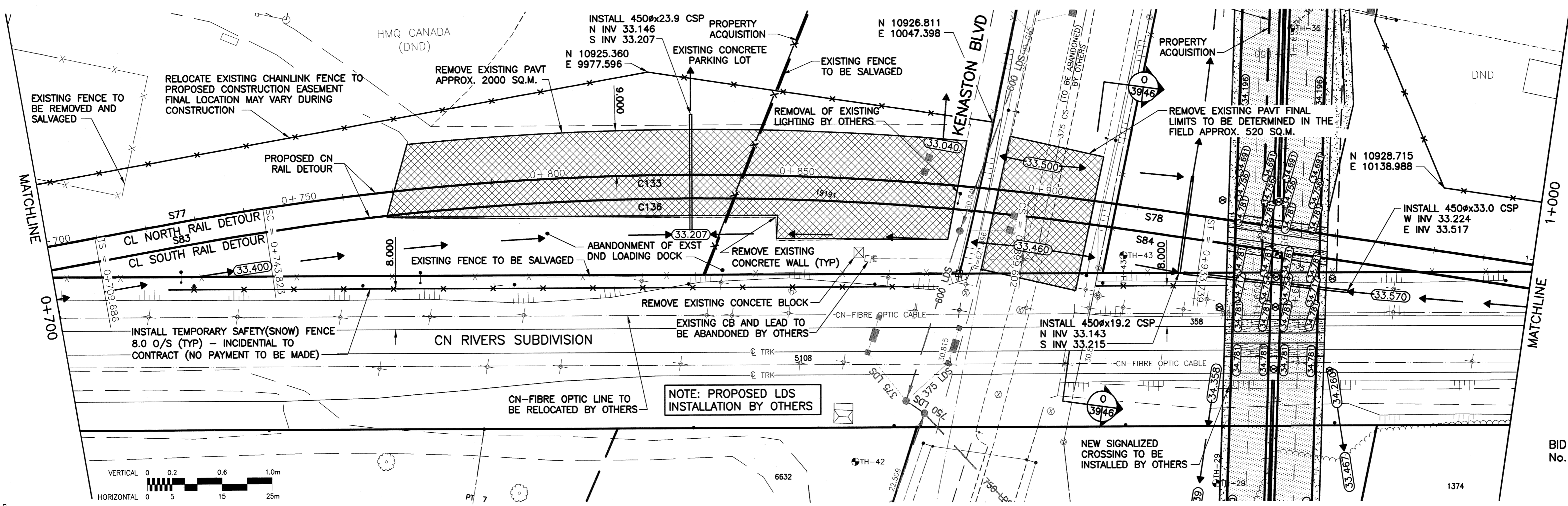
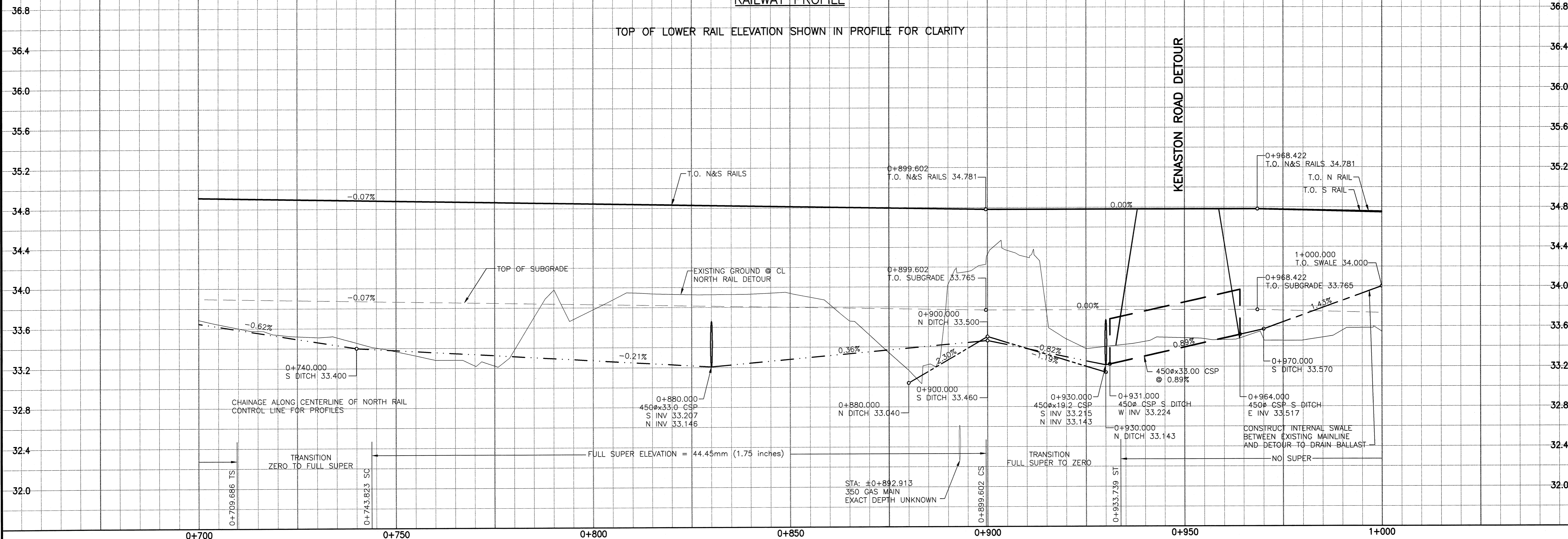

NOTE:  
 1. SEE SHEET 36 FOR KENASTON ROAD DETOUR.  
 2. SEE SHEET 40 FOR RAIL DETOUR HORIZONTAL GEOMETRY DATA TABLES.

### METRIC

WHOLE NUMBERS INDICATE MILLIMETRES  
DECIMAL NUMBERS INDICATE METRES

### WARNING

IF POWER EQUIPMENT OR EXPLOSIVES ARE TO BE USED FOR EXCAVATION ON THIS PROJECT THE CONTRACTOR MUST:  
 1) NOTIFY THE GAS COMPANY OF THE PROPOSED LOCATION OF EXCAVATION.  
 2) TAKE PRECAUTION TO AVOID DAMAGE TO GAS COMPANY INSTALLATIONS.  
 SEE PROVINCIAL REGULATION 140/92 FOR DETAILS

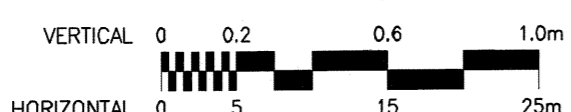

○	GAS	○	MANHOLE	●	CONCRETE PAVEMENT
□	MTS	□	CATCH BASIN/CATCH PIT	▨	CONC. SIDEWALK/MEDIAN
△	HYDRO	△	C & G INLET WITH BOX	▨	ASPHALT PAVEMENT
○	CATV	○	TREE	▨	ASPHALT APPROACH
⊕	TRAFFIC SIGNALS	⊕	TEST HOLE	▨	ASPHALT SHOULDER
—	LAND DRAINAGE SEWER	⊕	PROPERTY LINE	▨	GRAVEL SHOULDER
—	SANITARY/COMBINED SEWER	⊕	SURVEY BAR	▨	RAMP CURB
—	CATCHBASIN LEAD	⊕	GEODETIC MONUMENT	▨	REMOVAL
—	WATERMAIN	⊕	FENCE	▨	SIGN
—	SUBDRAIN	⊕	B.O. CURB/E.O. PAVEMENT	▨	POLE
—	DITCH/SWALE	⊕	ELEVATION	▨	RAIL SIGNALS/SIGNS
—	EXISTING	⊕	LEGEND - PLAN	▨	LEGEND - PLAN
—	NEW	⊕	NEW	▨	NEW

<p>LOCATION APPROVED UNDERGROUND STRUCTURES</p> <p>SUPV. U/G STRUCTURES COMMITTEE DATE</p> <p>NOTE:          LOCATION OF UNDERGROUND STRUCTURES AS SHOWN ARE BASED ON THE BEST INFORMATION AVAILABLE BUT NO GUARANTEE IS GIVEN THAT ALL EXISTING UTILITIES ARE SHOWN OR THAT THE GIVEN LOCATIONS ARE EXACT. CONFIRMATION OF EXISTENCE AND EXACT LOCATION OF ALL SERVICES MUST BE OBTAINED FROM THE INDIVIDUAL UTILITIES BEFORE PROCEEDING WITH CONSTRUCTION.</p>	<p>B.M. GBM67-002 ELEV. 233.951</p>
--	---

**UMA**  
An AECOM Company

2005 UMA ENGINEERING LTD. ALL RIGHTS RESERVED.

DESIGNED BY	RPB	CHECKED BY	JGK
DRAWN BY	DID,DL	APPROVED BY	[Signature]
ISSUED FOR CONSTRUCTION	05/04/19	AUTHORIZED BY:	[Signature]
ISSUED FOR CLIENT REVIEW	05/02/28	R. FINIGS PENG.	BRIDGE PROJECTS ENGINEER

HOR. SCALE: 1:500  
 VERTICAL: 1:20  
 DATE 05/04/19

ENGINEER'S SEAL  
 PROVINCE OF MANITOBA  
 REGISTERED PROFESSIONAL ENGINEER  
 R.P. BRUCE

**THE CITY OF WINNIPEG**  
PUBLIC WORKS DEPARTMENT  
ENGINEERING DIVISION

**Winnipeg**

**KENASTON UNDERPASS PROJECT**  
CN RIVERS SUBDIVISION RAIL DETOUR

HORIZONTAL AND VERTICAL ALIGNMENT  
STA. 0+700 TO STA. 1+000

SHEET 39 OF 61  
 CAD FILE DRAWING NUMBER 01-CT1035\_RX  
 CITY DRAWING NUMBER P-3258-99

BID OPPORTUNITY No. 84-2005

UMA Engineering Ltd.  
No. 256 Expiry: April 30, 2005

UMA FILE NAME: 4231-040-03\_01-CT1035\_RX.dwg Saved By: didoszp