

A1 SIZE 23.4" x 33.1" (594mm x 841mm)

PLOT: 05/04/19 3:43:28 PM

UMA FILE NAME: 423-040-03_01-CT1033_RX.dwg Saved By: ddozpod

SOUTHBOUND

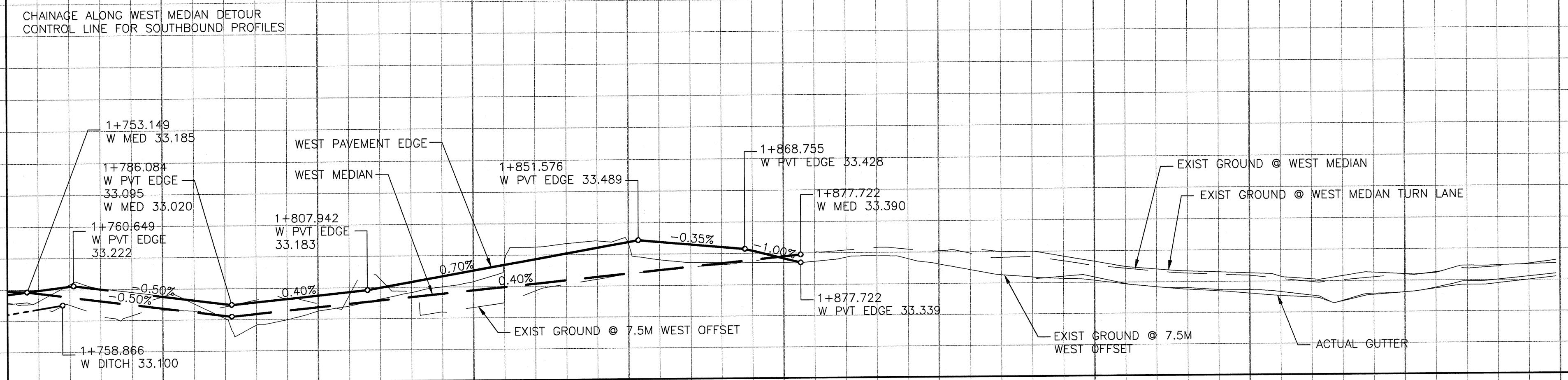

NORTHBOUND

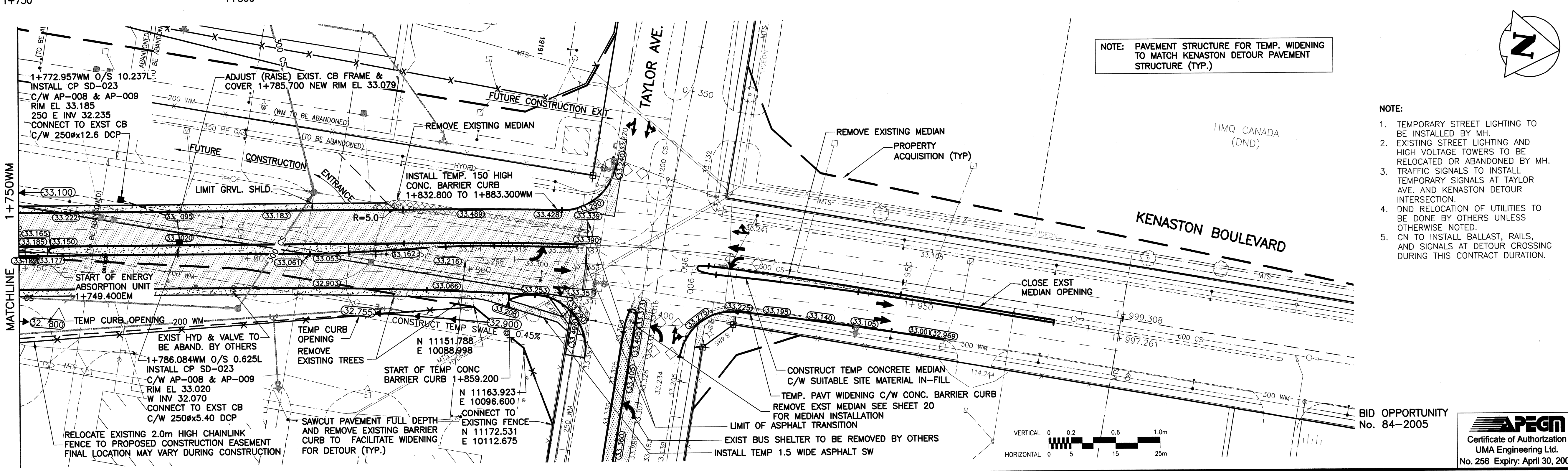
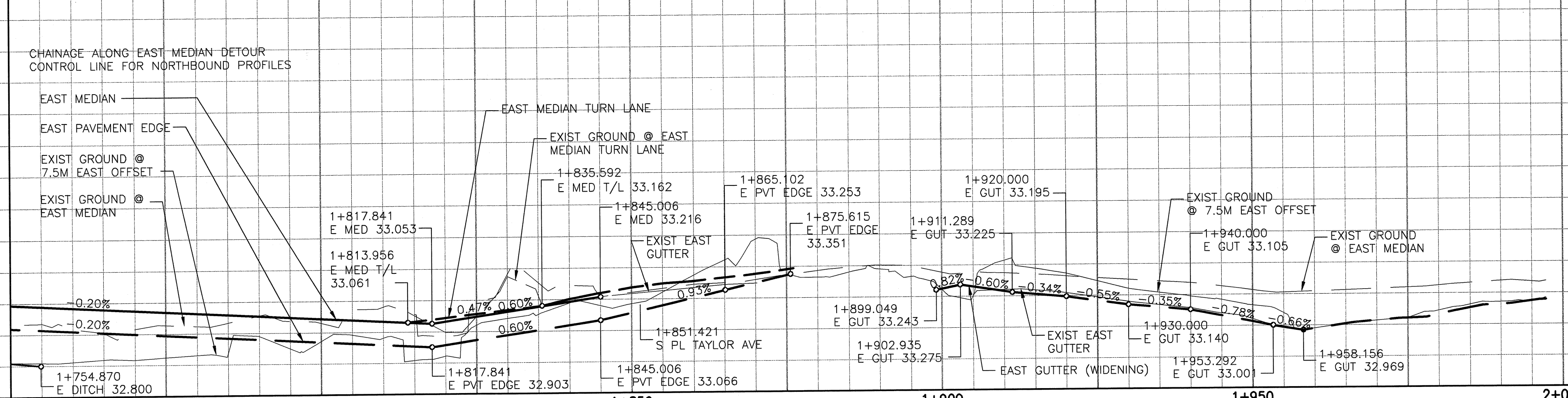

- NOTE:
- TEMPORARY STREET LIGHTING TO BE INSTALLED BY MH.
 - EXISTING STREET LIGHTING AND HIGH VOLTAGE TOWERS TO BE RELOCATED OR ABANDONED BY MH.
 - TRAFFIC SIGNALS TO INSTALL TEMPORARY SIGNALS AT TAYLOR AVE AND KENASTON DETOUR INTERSECTION.
 - DND RELOCATION OF UTILITIES TO BE DONE BY OTHERS UNLESS OTHERWISE NOTED.
 - CN TO INSTALL BALLAST, RAILS, AND SIGNALS AT DETOUR CROSSING DURING THIS CONTRACT DURATION.

METRIC
WHOLE NUMBERS INDICATE MILLIMETRES
DECIMALIZED NUMBERS INDICATE METRES

WARNING
IF POWER EQUIPMENT OR EXPLOSIVES ARE TO BE USED FOR EXCAVATION ON THIS PROJECT THE CONTRACTOR MUST:
1) NOTIFY THE GAS COMPANY OF THE PROPOSED LOCATION OF EXCAVATION.
2) TAKE PRECAUTION TO AVOID DAMAGE TO GAS COMPANY INSTALLATIONS.
SEE PROVINCIAL REGULATION 140/92 FOR DETAILS

	GAS		MANHOLE		CATCH BASIN/CATCH PIT
	MTS		C & G INLET WITH BOX		TREE
	HYDRO		TEST HOLE		PROPERTY LINE
	CATV		SURVEY BAR		GEODETIC MONUMENT
	TRAFFIC SIGNALS		FENCE		B.O. CURB/E.O. PAVEMENT
	LAND DRAINAGE SEWER		ELEVATION		RAIL SIGNALS/SIGNS
	SANITARY/COMBINED SEWER		EXISTING LEGEND - PLAN		NEW LEGEND - PLAN
	CATCHBASIN LEAD				
	WATERMAIN				
	SUBDRAIN				
	DITCH/SWALE				

	CONCRETE PAVEMENT		LOCATION APPROVED
	CONC. SIDEWALK/MEDIAN		UNDERGROUND STRUCTURES
	ASPHALT PAVEMENT		SUPP. U/G STRUCTURES
	ASPHALT APPROACH		DATE
	ASPHALT SHOULDER		NOTE:
	GRAVEL SHOULDER		LOCATION OF UNDERGROUND STRUCTURES AS SHOWN ARE BASED ON THE BEST INFORMATION AVAILABLE BUT NO GUARANTEE IS GIVEN THAT ALL EXISTING UTILITIES ARE SHOWN OR THAT THE GIVEN LOCATIONS ARE EXACT. CONFIRMATION OF EXISTENCE AND EXACT LOCATION OF ALL SERVICES MUST BE OBTAINED FROM THE INDIVIDUAL UTILITIES BEFORE PROCEEDING WITH CONSTRUCTION.

B.M. 6867-002 ELEV. 233.951		UMA An AECOM Company 2005 UMA ENGINEERING LTD. ALL RIGHTS RESERVED.	
DESIGNED BY	RPB	CHECKED BY	JGK
DRAWN BY	DID,DL	APPROVED BY	<i>Bub</i>
ISSUED FOR CONSTRUCTION	05/04/19	DATE	
ISSUED FOR CLIENT REVIEW	05/02/28	DATE	
NO. REVISIONS		DATE	05/04/19

ENGINEER'S SEAL
PROVINCE OF MANITOBA
April 1995
R. P. BRUCE
REGISTERED PROFESSIONAL ENGINEER

THE CITY OF WINNIPEG
PUBLIC WORKS DEPARTMENT
ENGINEERING DIVISION

KENASTON UNDERPASS PROJECT
KENASTON BOULEVARD ROAD DETOUR

HORIZONTAL AND VERTICAL ALIGNMENT
STA. 1+750 TO STA. 2+000

SHEET 37 OF 61
CAD FILE DRAWING NUMBER 01-CT1033_RX
CITY DRAWING NUMBER P-3258-97

BID OPPORTUNITY No. 84-2005

CONSULTANT DRAWING NO. 4231-040-03-37