

A1 SIZE 23.4" x 33.1" (594mm x 841mm)

PLOT: 05/04/14 8:27:43 AM

UMA FILE NAME: 4231-040-01-CT1027_RX.dwg Saved By: ddbaszpod

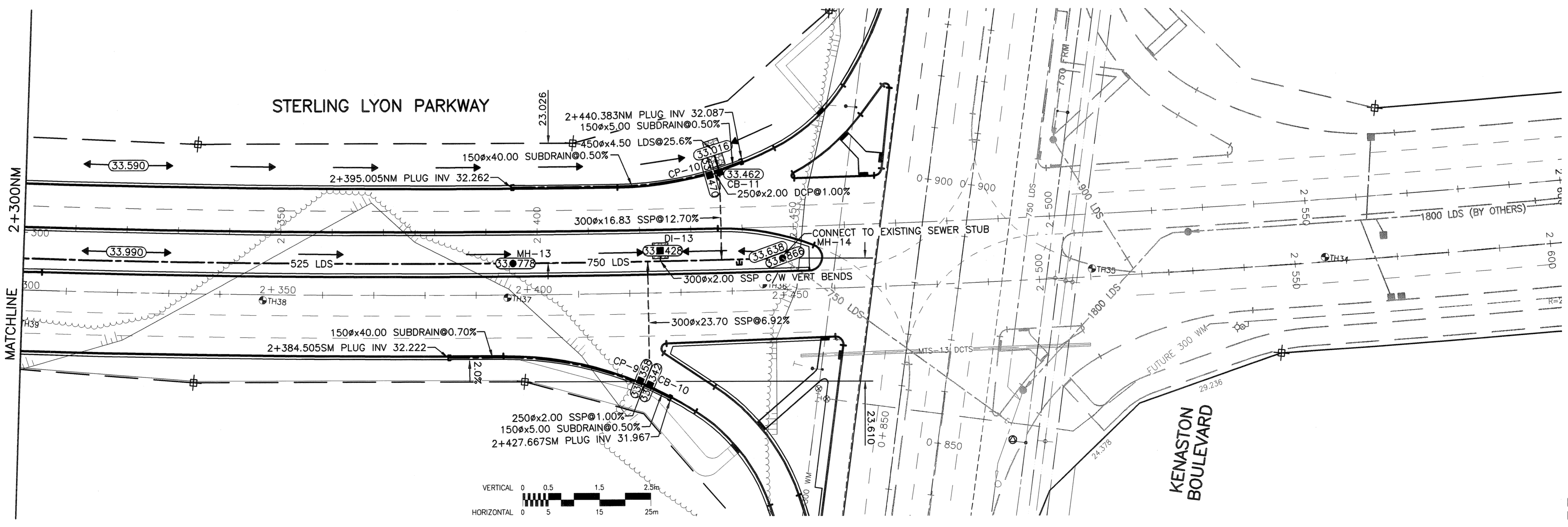
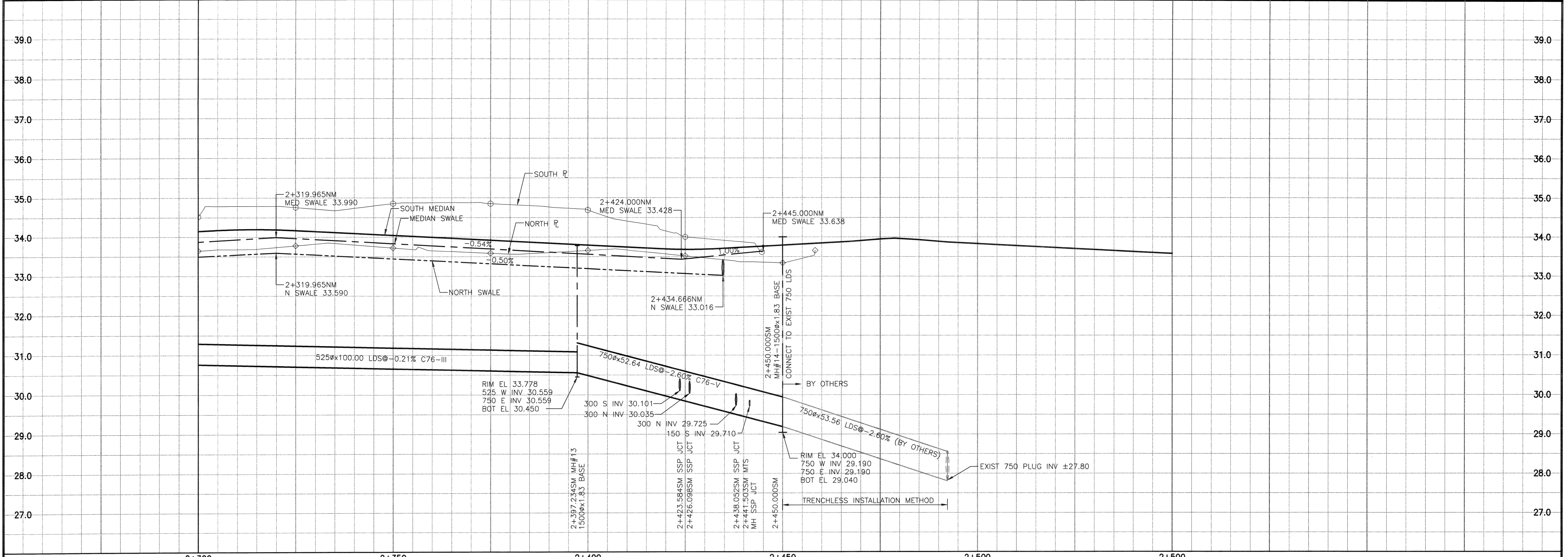

NOTES:
 1. SEE SHEET 30 FOR MH, CB, CP, AND DI STRUCTURE AND LOCATION SCHEDULE.
 2. CLASS 3 BACKFILL UNLESS NOTED OTHERWISE.

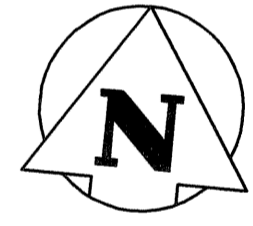

METRIC

WHOLE NUMBERS INDICATE MILLIMETRES
 DECIMALIZED NUMBERS INDICATE METRES

WARNING

IF POWER EQUIPMENT OR EXPLOSIVES ARE TO BE USED FOR EXCAVATION ON THIS PROJECT THE CONTRACTOR MUST:
 1) NOTIFY THE GAS COMPANY OF THE PROPOSED LOCATION OF EXCAVATION.
 2) TAKE PRECAUTION TO AVOID DAMAGE TO GAS COMPANY INSTALLATIONS.
 SEE PROVINCIAL REGULATION 140/92 FOR DETAILS

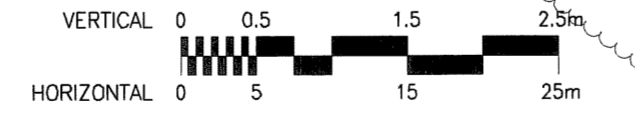

EXISTING	LEGEND - PLAN	NEW	EXISTING	LEGEND - PLAN	NEW	EXISTING	LEGEND - PLAN	NEW
○	MANHOLE	●	CONCRETE PAVEMENT	▨	LOCATION APPROVED UNDERGROUND STRUCTURES	□	CATCH BASIN/CATCH PIT	■
○	MTS	■	CONC. SIDEWALK/MEDIAN	▨	SUPPLY U/G STRUCTURES COMMITTEE	△	C & G INLET WITH BOX	▲
○	HYDRO	△	ASPHALT PAVEMENT	▨	NOTE:	○	TREE	▲
○	CATV	△	ASPHALT APPROACH	▨	LOCATION OF UNDERGROUND STRUCTURES AS SHOWN ARE BASED ON THE BEST INFORMATION AVAILABLE BUT NO GUARANTEE IS GIVEN THAT ALL EXISTING UTILITIES ARE SHOWN OR THAT THE GIVEN LOCATIONS ARE EXACT. CONFIRMATION OF EXISTENCE AND EXACT LOCATION OF ALL SERVICES MUST BE OBTAINED FROM THE INDIVIDUAL UTILITIES BEFORE PROCEEDING WITH CONSTRUCTION.	○	TEST HOLE	▲
○	TRAFFIC SIGNALS	△	ASPHALT SHOULDER	▨		○	PROPERTY LINE	▲
○	LAND DRAINAGE SEWER	△	GRAVEL SHOULDER	▨		○	SURVEY BAR	▲
○	SANITARY/COMBINED SEWER	△	RAMP CURB	▨		○	GEODETIC MONUMENT	▲
○	CATCHBASIN LEAD	△	REMOVAL	▨		○	FENCE	▲
○	WATERMAIN	△	SIGN	▨		○	B.O. CURB/E.O. PAVEMENT	▲
○	SUBDRAIN	△	POLE	▨		○	ELEVATION	▲
○	DITCH/SWALE	△	RAIL SIGNALS/SIGNS	▨		○	33.000	▲
○	EXISTING	△	NEW	▨		○	EXISTING	▲
○	LEGEND - PLAN	△	NEW	▨		○	LEGEND - PLAN	▲

LOCATION APPROVED UNDERGROUND STRUCTURES
 SUPPLY U/G STRUCTURES COMMITTEE DATE
 NOTE:
 LOCATION OF UNDERGROUND STRUCTURES AS SHOWN ARE BASED ON THE BEST INFORMATION AVAILABLE BUT NO GUARANTEE IS GIVEN THAT ALL EXISTING UTILITIES ARE SHOWN OR THAT THE GIVEN LOCATIONS ARE EXACT. CONFIRMATION OF EXISTENCE AND EXACT LOCATION OF ALL SERVICES MUST BE OBTAINED FROM THE INDIVIDUAL UTILITIES BEFORE PROCEEDING WITH CONSTRUCTION.

NO.	REVISIONS	DATE	BY
0	ISSUED FOR CONSTRUCTION	05/04/19	DL
A	ISSUED FOR CLIENT REVIEW	05/02/28	DD

UMA
 An AECOM Company
 2005 UMA ENGINEERING LTD. ALL RIGHTS RESERVED.

DESIGNED BY: WRJ
 CHECKED BY: RRM
 DRAWN BY: DID
 APPROVED BY: RRM
 AUTHORIZED BY: R. FINGAS
 BRIDGE PROJECTS ENGINEER

HOR. SCALE: 1:500
 VERTICAL: 1:50
 DATE: 05/04/19

ENGINEER'S SEAL
 PROVINCE OF MANITOBA
 REGISTERED PROFESSIONAL ENGINEER
 A. NAGY
 April 19, 2005

THE CITY OF WINNIPEG
 PUBLIC WORKS DEPARTMENT
 ENGINEERING DIVISION

Winnipeg

KENASTON UNDERPASS PROJECT
 STERLING LYON PARKWAY WEST OF KENASTON BOULEVARD

LAND DRAINAGE SYSTEM
 STA. 2+300 TO KENASTON BLVD.

BID OPPORTUNITY No. 84-2005
 Certificate of Authorization UMA Engineering Ltd. No. 256 Expiry: April 30, 2005

SHEET 28 OF 61
 CAD FILE DRAWING NUMBER 01-CT1027_RX
 CITY DRAWING NUMBER P-3258-88