

A1 SIZE 23.4" x 33.1" (594mm x 841mm)

PLOT: 05/04/13 3:20:36 PM

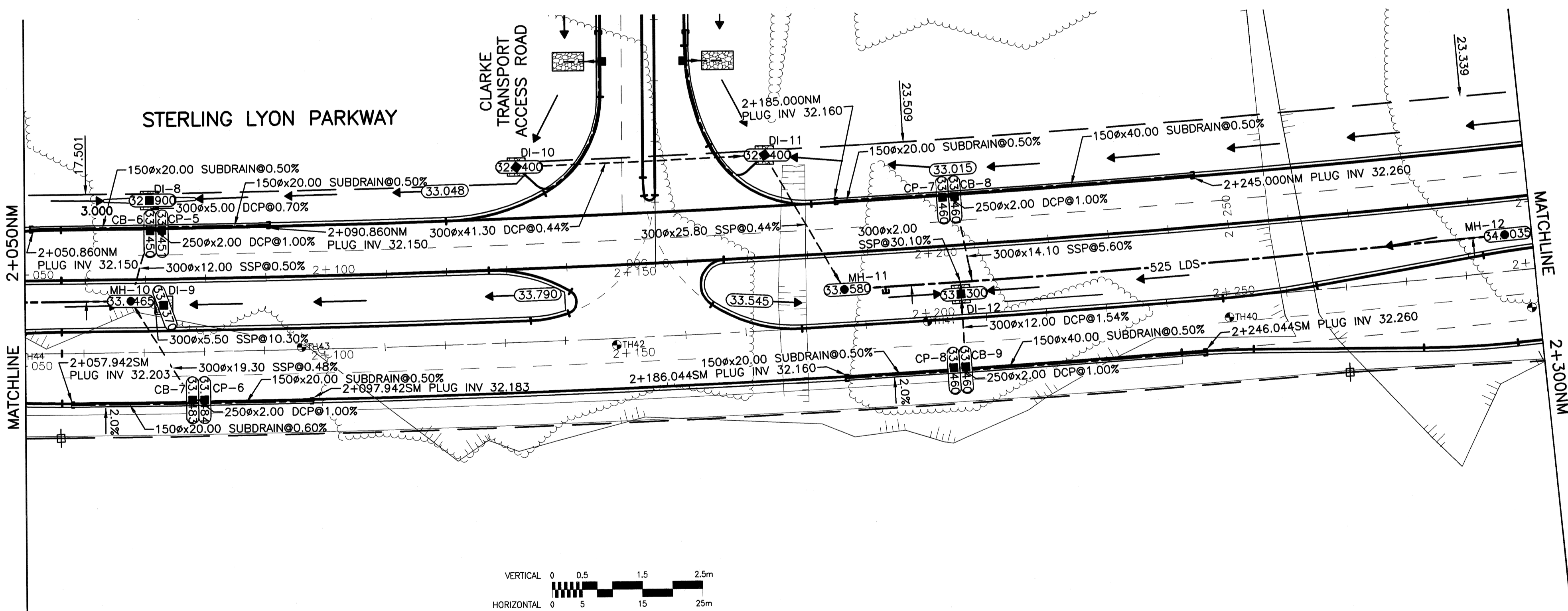

- NOTES:**
1. SEE SHEET 30 FOR MH, CB, CP, AND DI STRUCTURE AND LOCATION SCHEDULE.
 2. CLASS 3 BACKFILL UNLESS NOTED OTHERWISE.
 3. SEE SHEET 17 FOR CLARKE TRANSPORT ACCESS LAND DRAINAGE SYSTEM INFORMATION.

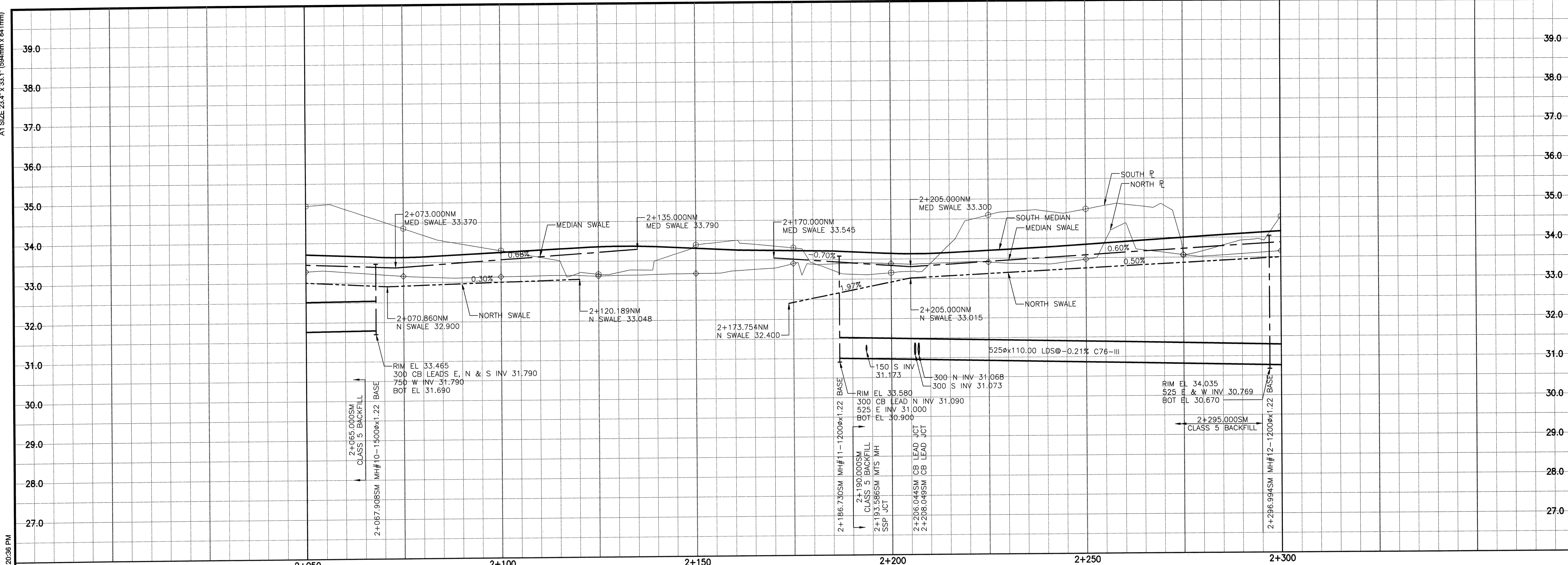
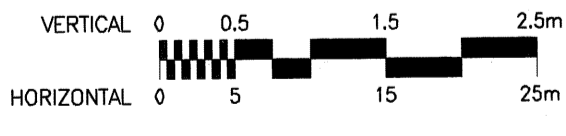
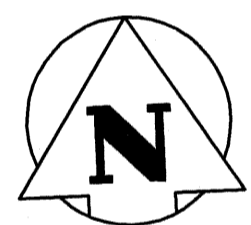

METRIC

WHOLE NUMBERS INDICATE MILLIMETRES
DECIMALIZED NUMBERS INDICATE METRES

WARNING

- IF POWER EQUIPMENT OR EXPLOSIVES ARE TO BE USED FOR EXCAVATION ON THIS PROJECT THE CONTRACTOR MUST:
- 1) NOTIFY THE GAS COMPANY OF THE PROPOSED LOCATION OF EXCAVATION.
 - 2) TAKE PRECAUTION TO AVOID DAMAGE TO GAS COMPANY INSTALLATIONS.
- SEE PROVINCIAL REGULATION 140/92 FOR DETAILS

UMA FILE NAME: 4231-040-01_01-CT-1026_RX.dwg Saved By: dtdozpod

EXISTING	LEGEND	PLAN	NEW	EXISTING	LEGEND	PLAN	NEW	EXISTING	LEGEND	PLAN	NEW
○	GAS		●	MANHOLE		●	CONCRETE PAVEMENT				
□	MTS		□	CATCH BASIN/CATCH PIT		■	CONC. SIDEWALK/MEDIAN				
△	HYDRO		△	C & G INLET WITH BOX		▨	ASPHALT PAVEMENT				
○	CATV		○	TREE		▨	ASPHALT APPROACH				
TH10	TRAFFIC SIGNALS		TH10	TEST HOLE		▨	ASPHALT SHOULDER				
---	LAND DRAINAGE SEWER		---	PROPERTY LINE		▨	RAMP CURB				
---	SANITARY/COMBINED SEWER		---	SURVEY BAR		▨	REMOVAL				
---	CATCHBASIN LEAD		○	GEODETIC MONUMENT		▨	SIGN				
---	WATERMAIN		---	FENCE		▨	POLE				
---	SUBDRAIN		---	B.O. CURB/E.O. PAVEMENT		▨	RAIL SIGNALS/SIGNS				
---	DITCH/SWALE		---	ELEVATION		○					

LOCATION APPROVED UNDERGROUND STRUCTURES

SUPV. U/G STRUCTURES COMMITTEE DATE

NOTE:
LOCATION OF UNDERGROUND STRUCTURES AS SHOWN ARE BASED ON THE BEST INFORMATION AVAILABLE BUT NO GUARANTEE IS GIVEN THAT ALL EXISTING UTILITIES ARE SHOWN OR THAT THE GIVEN LOCATIONS ARE EXACT. CONFIRMATION OF EXISTENCE AND EXACT LOCATION OF ALL SERVICES MUST BE OBTAINED FROM THE INDIVIDUAL UTILITIES BEFORE PROCEEDING WITH CONSTRUCTION.

NO.	REVISIONS	DATE	BY
0	ISSUED FOR CONSTRUCTION	05/04/19	DL
A	ISSUED FOR CLIENT REVIEW	05/02/28	DD

B.M. GBM67-001
ELEV. 234.148

UMA
An AECOM Company
2005 UMA ENGINEERING LTD. ALL RIGHTS RESERVED.

DESIGNED BY	WRJ	CHECKED BY	RFB
DRAWN BY	DID	APPROVED BY	RFB
AUTHORIZED BY	R. FINGAS	DATE	05/04/19

HOR. SCALE: 1:500
VERTICAL: 1:50

CONSULTANT DRAWING NO. 4231-040-01-27

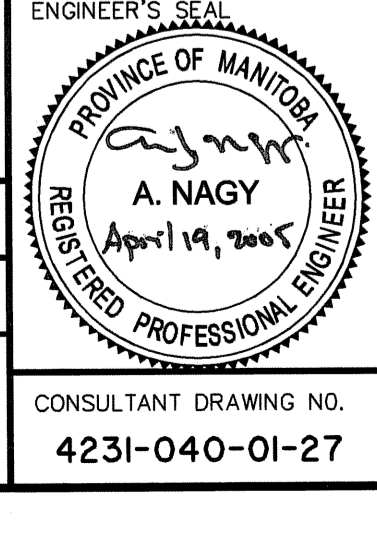

THE CITY OF WINNIPEG
PUBLIC WORKS DEPARTMENT
ENGINEERING DIVISION

Winnipeg

KENASTON UNDERPASS PROJECT
STERLING LYON PARKWAY WEST OF KENASTON BOULEVARD

LAND DRAINAGE SYSTEM
STA. 2+050 TO STA. 2+300

SHEET 27 OF 61
CAD FILE DRAWING NUMBER 01-CT-1026_RX
CITY DRAWING NUMBER P-3258-87

BID OPPORTUNITY No. 84-2005
Certificate of Authorization UMA Engineering Ltd. No. 256 Expiry: April 30, 2005