

A1 SIZE 23.4" x 33.1" (594mm x 841mm)

PLOT: 05/04/13 2:52:03 PM

UMA FILE NAME: 4231-040-01_01-CT1020_RX.dwg Saved By: ddespoid

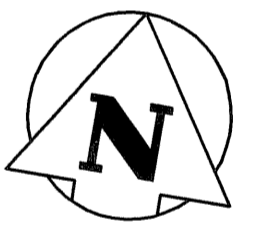
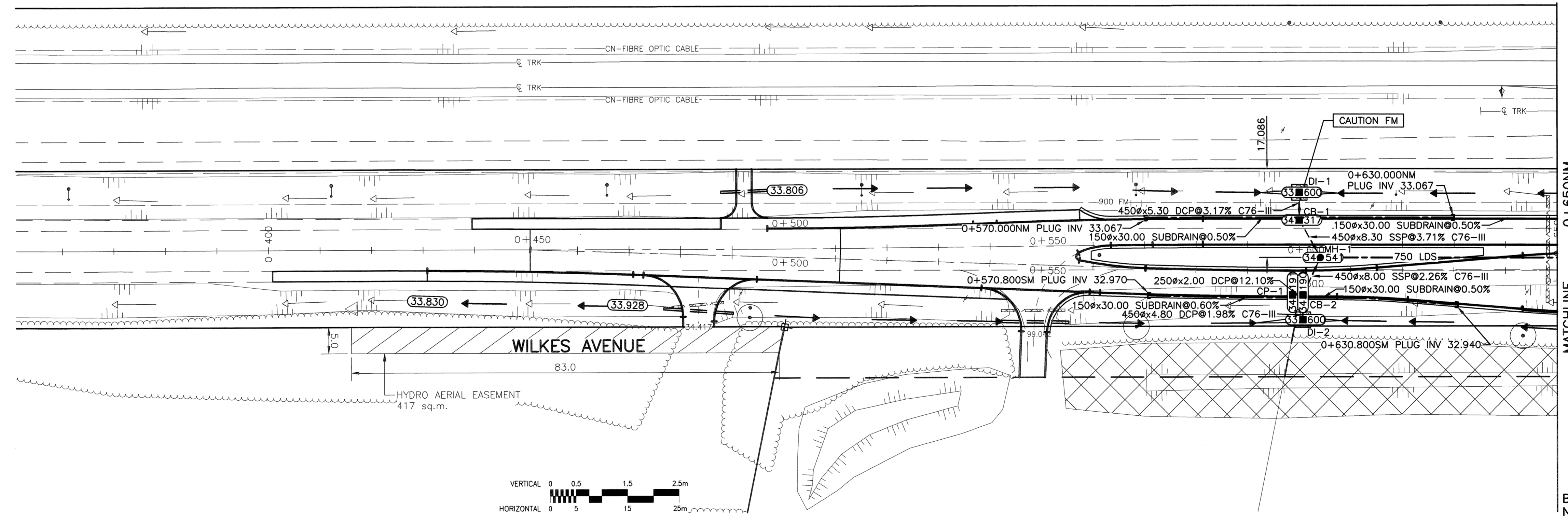
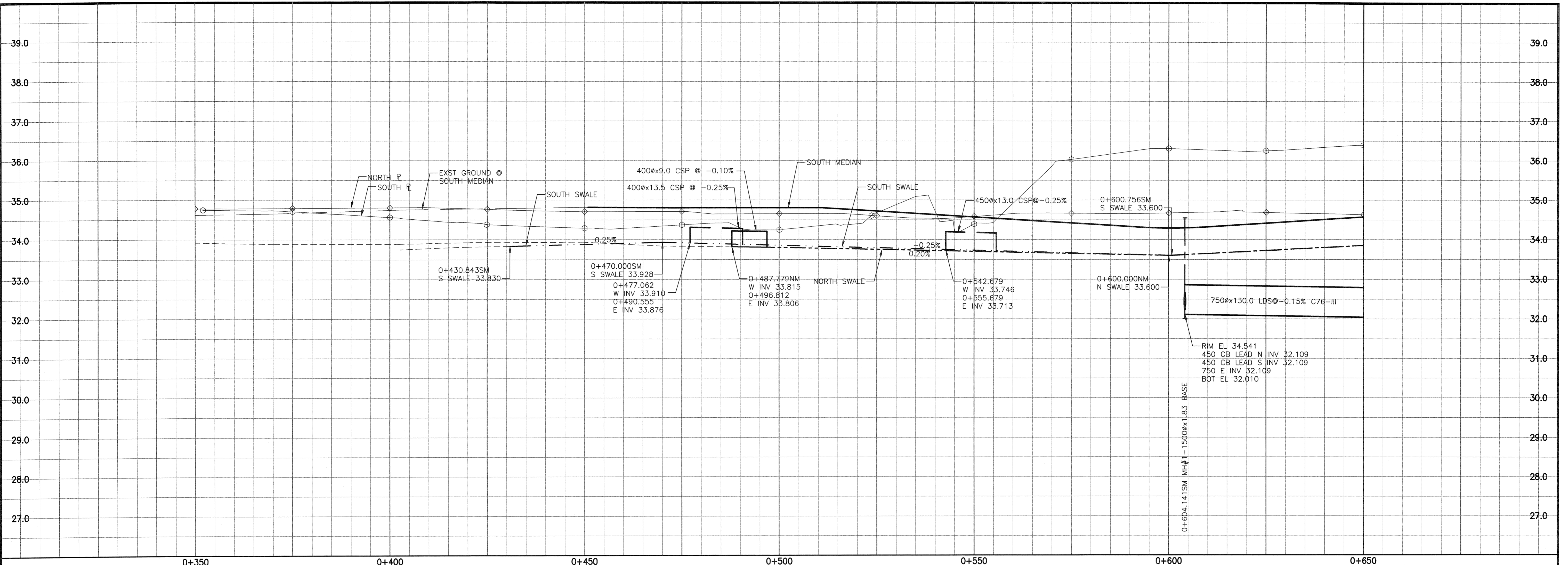

NOTES:
 1. SEE SHEET 29 FOR MH, CB, CP, AND DI STRUCTURE AND LOCATION SCHEDULE.
 2. CLASS 3 BACKFILL UNLESS NOTED OTHERWISE.

METRIC

WHOLE NUMBERS INDICATE MILLIMETRES
 DECIMALIZED NUMBERS INDICATE METRES

WARNING

IF POWER EQUIPMENT OR EXPLOSIVES ARE TO BE USED FOR EXCAVATION ON THIS PROJECT THE CONTRACTOR MUST:
 1) NOTIFY THE GAS COMPANY OF THE PROPOSED LOCATION OF EXCAVATION.
 2) TAKE PRECAUTION TO AVOID DAMAGE TO GAS COMPANY INSTALLATIONS.
 SEE PROVINCIAL REGULATION 140/92 FOR DETAILS

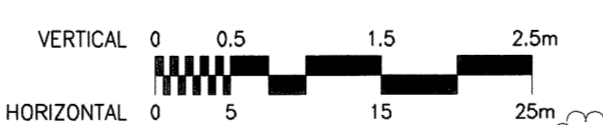

EXISTING	LEGEND - PLAN	NEW	EXISTING	LEGEND - PLAN	NEW	EXISTING	LEGEND - PLAN	NEW
○	GAS	○	MANHOLE	●	CONCRETE PAVEMENT	▨	CONC. SIDEWALK/MEDIAN	▨
□	MTS	□	CATCH BASIN/CATCH PIT	■	ASPHALT PAVEMENT	▨	ASPHALT APPROACH	▨
△	HYDRO	△	C & G INLET WITH BOX	▲	ASPHALT SHOULDER	▨	ASPHALT SHOULDER	▨
⊙	CATV	⊙	TREE	⊙	GRAVEL SHOULDER	▨	RAMP CURB	▨
⊙	TRAFFIC SIGNALS	⊙	TEST HOLE	⊙	REMOVAL	▨	SIGN	▨
⊙	LAND DRAINAGE SEWER	⊙	PROPERTY LINE	⊙	POLE	▨	RAIL SIGNALS/SIGNS	▨
⊙	SANITARY/COMBINED SEWER	⊙	SURVEY BAR	⊙	RAIL SIGNALS/SIGNS	▨		
⊙	CATCHBASIN LEAD	⊙	GEODETIC MONUMENT	⊙				
⊙	WATERMAIN	⊙	FENCE	⊙				
⊙	SUBDRAIN	⊙	B.O. CURB/E.O. PAVEMENT	⊙				
⊙	DITCH/SWALE	⊙	ELEVATION	⊙				
⊙		33.000		33.000				

LOCATION APPROVED UNDERGROUND STRUCTURES

SUPV. U/G STRUCTURES COMMITTEE DATE

NOTE:
 LOCATION OF UNDERGROUND STRUCTURES AS SHOWN ARE BASED ON THE BEST INFORMATION AVAILABLE BUT NO GUARANTEE IS GIVEN THAT ALL EXISTING UTILITIES ARE SHOWN OR THAT THE GIVEN LOCATIONS ARE EXACT. CONFIRMATION OF EXISTENCE AND EXACT LOCATION OF ALL SERVICES MUST BE OBTAINED FROM THE INDIVIDUAL UTILITIES BEFORE PROCEEDING WITH CONSTRUCTION.

B.M. 09M67-001
 ELEV. 234.148

DESIGNED BY	WRJ	CHECKED BY	RFB
DRAWN BY	DID	APPROVED BY	Paul
DATE	05/04/19	DATE	05/04/19

0 ISSUED FOR CONSTRUCTION 05/04/19 DL
 A ISSUED FOR CLIENT REVIEW 05/02/28 DD
 NO. REVISIONS DATE BY

UMA
 An AECOM Company
 2005 UMA ENGINEERING LTD. ALL RIGHTS RESERVED.

ENGINEER'S SEAL
 PROVINCE OF MANITOBA
 REGISTERED PROFESSIONAL ENGINEER
 A. NAGY
 April 19, 2005

CONSULTANT DRAWING NO.
 4231-040-01-21

THE CITY OF WINNIPEG
 PUBLIC WORKS DEPARTMENT
 ENGINEERING DIVISION

Winnipeg

KENASTON UNDERPASS PROJECT
 STERLING LYON PARKWAY WEST

LAND DRAINAGE SYSTEM
 STA. 0+350 TO STA. 0+650

SHEET 21 OF 61
 CAD FILE DRAWING NUMBER 01-CT1020_RX
 CITY DRAWING NUMBER P-3258-81

BID OPPORTUNITY No. 84-2005
 Certificate of Authorization UMA Engineering Ltd. No. 256 Expiry: April 30, 2005