

A1 SIZE 23.4" x 33.1" (594mm x 841mm) PLOT: 05/04/13 2:49:25 PM UMA FILE NAME: 4231-040-01-CT1037_RX.dwg Saved By: ddespood

WESTBOUND TO SOUTHBOUND

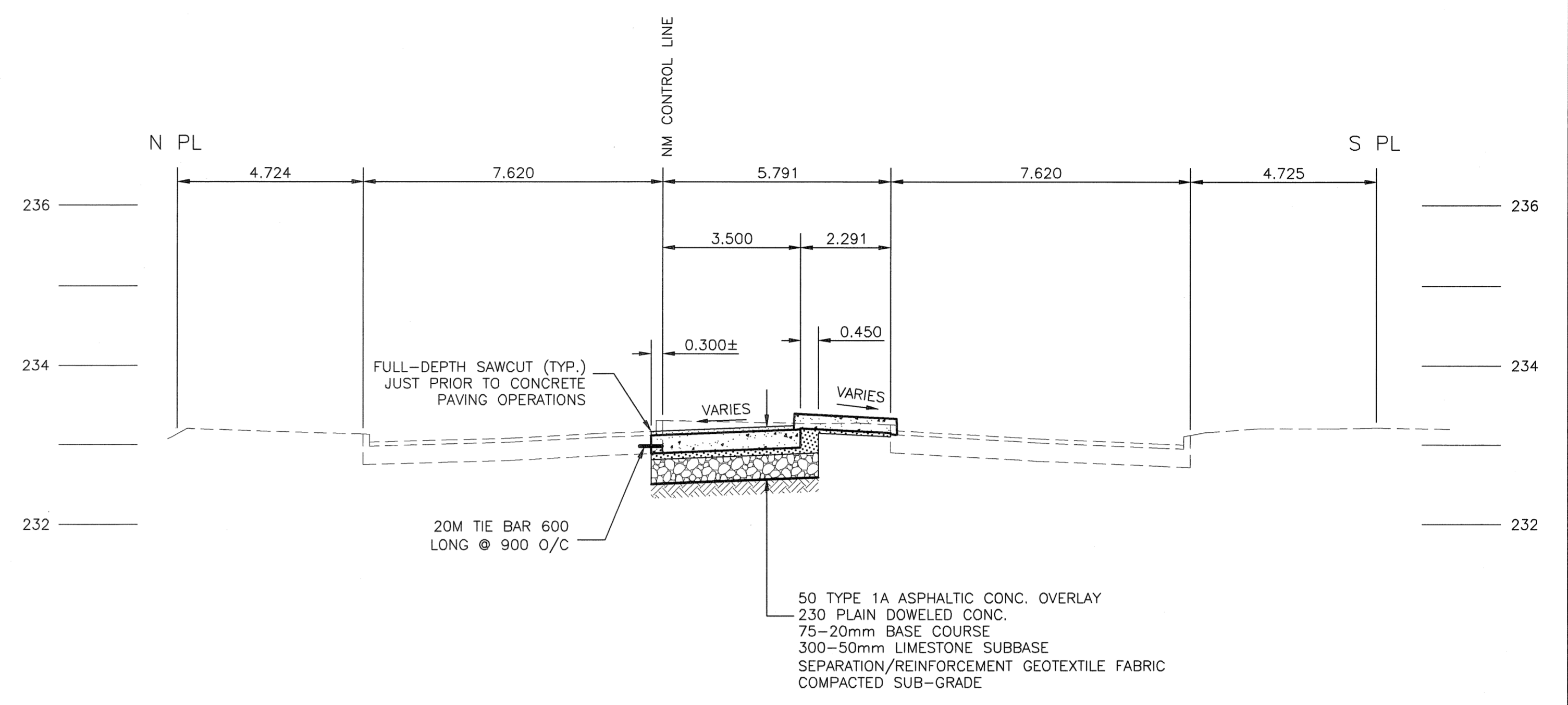

TAYLOR AVENUE SECTION @ STA. 0+450NM
SCALE: HOR 1:100 VER 1:50

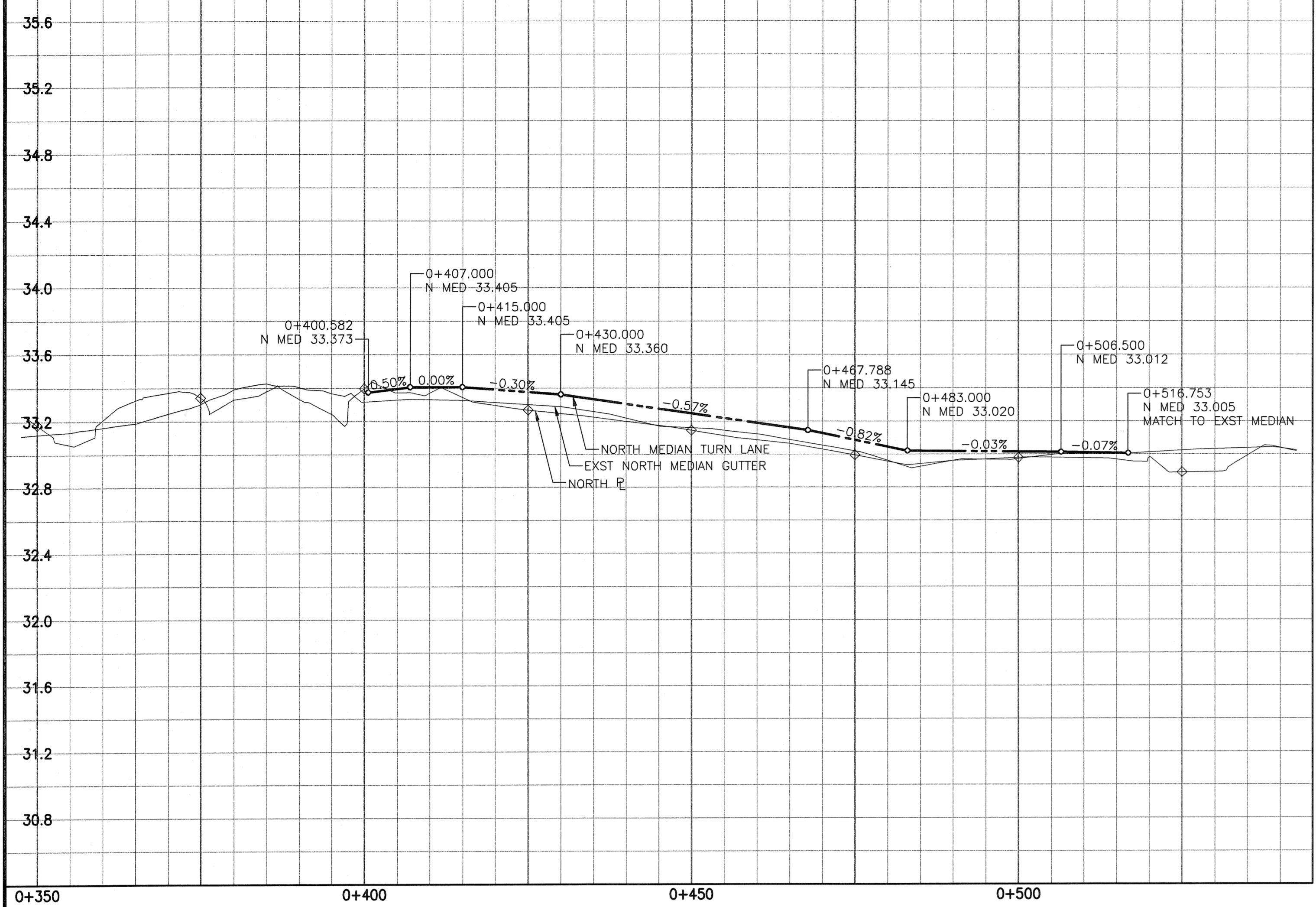
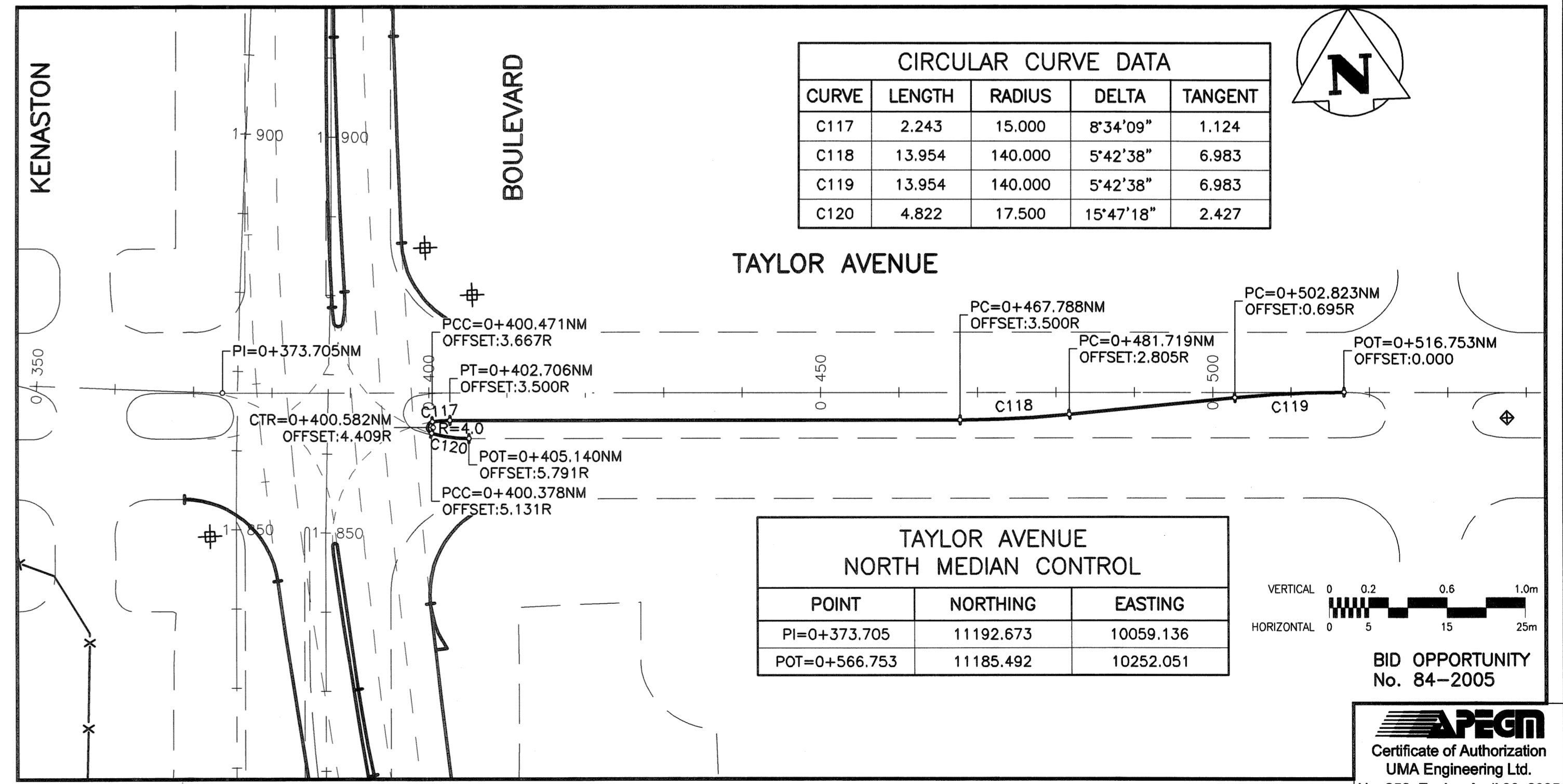
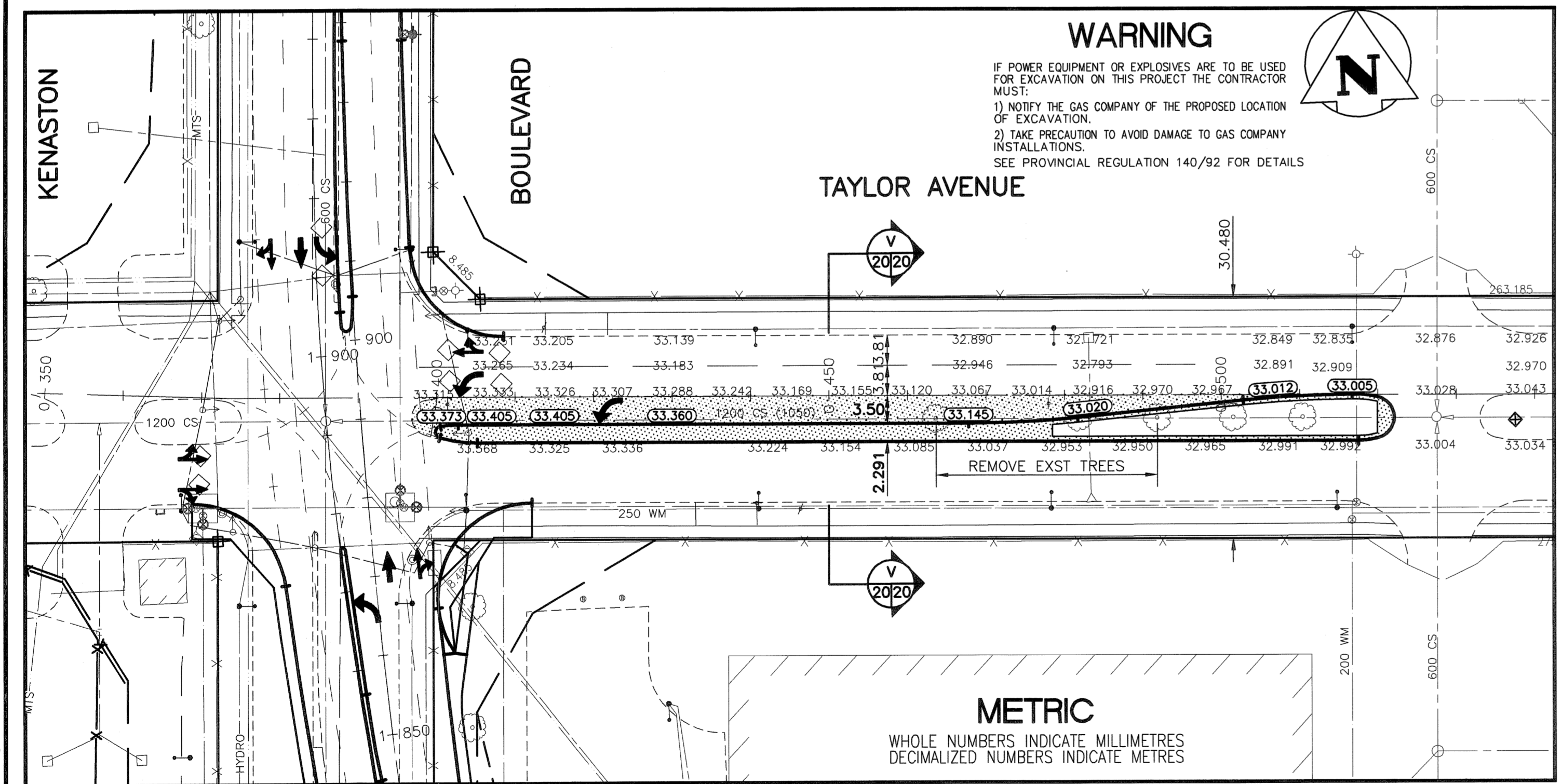

EXISTING	LEGEND - PLAN	NEW	EXISTING	LEGEND - PLAN	NEW	EXISTING	LEGEND - PLAN	NEW
○	MANHOLE	●	CONCRETE PAVEMENT	▨	LOCATION APPROVED UNDERGROUND STRUCTURES	□	CATCH BASIN/CATCH PIT	■
○	CATCH BASIN/CATCH PIT	■	CONC. SIDEWALK/MEDIAN	▨	SUPV. U/G STRUCTURES COMMITTEE	△	C & G INLET WITH BOX	▲
○	HYDRO	△	ASPHALT PAVEMENT	▨	NOTE:	△	TEST HOLE	▲
○	CATV	△	ASPHALT APPROACH	▨	LOCATION OF UNDERGROUND STRUCTURES AS SHOWN ARE BASED ON THE BEST INFORMATION AVAILABLE BUT NO GUARANTEE IS GIVEN THAT ALL EXISTING UTILITIES ARE SHOWN OR THAT THE GIVEN LOCATIONS ARE EXACT. CONFIRMATION OF EXISTENCE AND EXACT LOCATION OF ALL SERVICES MUST BE OBTAINED FROM THE INDIVIDUAL UTILITIES BEFORE PROCEEDING WITH CONSTRUCTION.	△	PROPERTY LINE	▲
○	TRAFFIC SIGNALS	△	ASPHALT SHOULDER	▨		△	GEODETIC MONUMENT	▲
○	LAND DRAINAGE SEWER	△	GRAVEL SHOULDER	▨		△	FENCE	▲
○	SANITARY/COMBINED SEWER	△	RAMP CURB	▨		△	B.O. CURB/E.O. PAVEMENT	▲
○	CATCHBASIN LEAD	△	REMOVAL	▨		△	ELEVATION	▲
○	WATERMAIN	△	SIGN	▨		△	33.000	33.000
○	SUBDRAIN	△	POLE	▨		△		
○	DITCH/SWALE	△	RAIL SIGNALS/SIGNS	▨		△		
○	EXISTING	△	NEW	▨		△		

<p>UMA An AECOM Company 2005 UMA ENGINEERING LTD. ALL RIGHTS RESERVED.</p>		<p>BRUCE W. BIGLOW REGISTERED PROFESSIONAL ENGINEER</p>		<p>THE CITY OF WINNIPEG PUBLIC WORKS DEPARTMENT Winnipeg ENGINEERING DIVISION</p>	
DESIGNED BY: WRJ	CHECKED BY: [Signature]	<p>KENASTON UNDERPASS PROJECT TAYLOR AVENUE EAST OF KENASTON BOULEVARD</p>		<p>SHEET 20 OF 61 CAD FILE DRAWING NUMBER 01-CT1037_RX</p>	
DRAWN BY: DID	APPROVED BY: [Signature]	<p>HOR & VERT ALIGNMENT, GEOMETRY & SECTION TAYLOR AVENUE W BND TO S BND TURN LANE</p>		<p>CITY DRAWING NUMBER P-3258-80</p>	
ISSUED FOR CONSTRUCTION: 05/04/19 DL	HOR. SCALE: 1:500	<p>CONSULTANT DRAWING NO. 4231-040-01-20</p>		<p>DATE 05/04/19</p>	
ISSUED FOR CLIENT REVIEW: 05/02/28 DL	VERTICAL: 1:20	<p>R. FINCAS P. ENG. BRIDGE PROJECTS ENGINEER</p>		<p>NO. REVISIONS DATE BY</p>	