

A1 SIZE 23.4" x 33.1" (594mm x 841mm)

PLOT: 05/04/12 12:49:38 PM

UMA FILE NAME: 4231-040-01_01-CT1017_RX.dwg Saved By: ddszpod

SOUTHBOUND

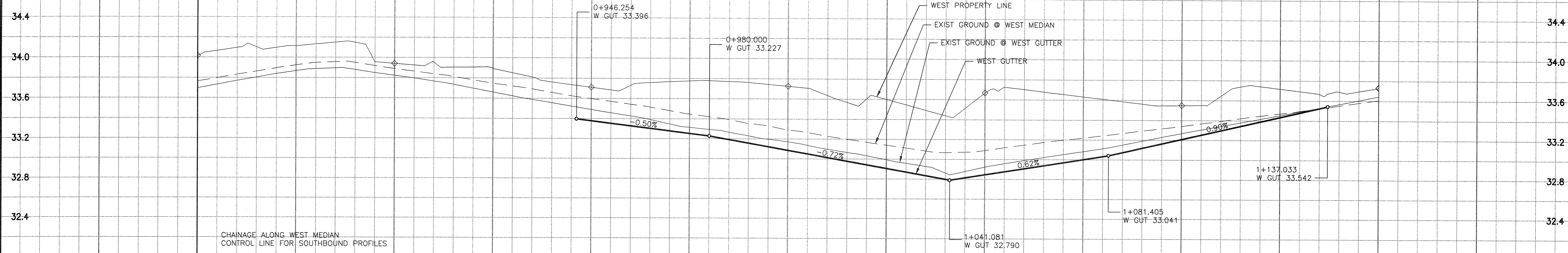

NORTHBOUND

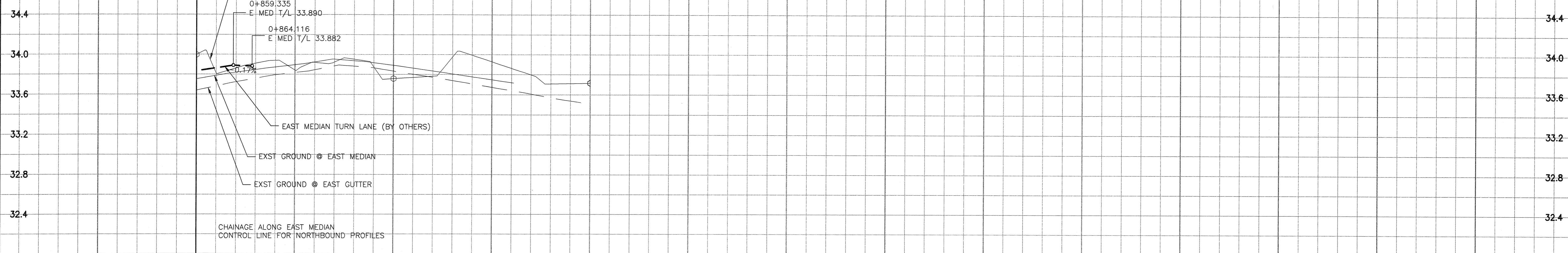

0+850 0+900 0+950 1+000 1+050 1+100 1+150

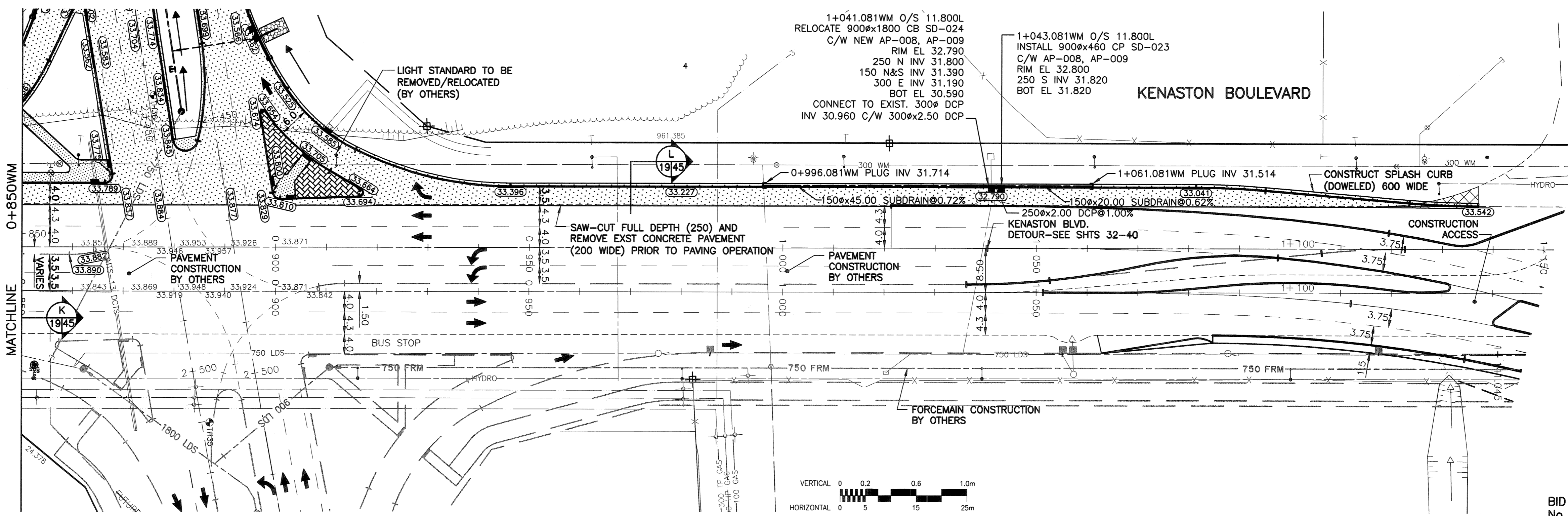

METRIC

WHOLE NUMBERS INDICATE MILLIMETRES
DECIMALIZED NUMBERS INDICATE METRES

WARNING

IF POWER EQUIPMENT OR EXPLOSIVES ARE TO BE USED FOR EXCAVATION ON THIS PROJECT THE CONTRACTOR MUST:

- 1) NOTIFY THE GAS COMPANY OF THE PROPOSED LOCATION OF EXCAVATION.
- 2) TAKE PRECAUTION TO AVOID DAMAGE TO GAS COMPANY INSTALLATIONS.

SEE PROVINCIAL REGULATION 140/92 FOR DETAILS

NOTES:
1. SEE SHEET 59 FOR LANDSCAPE DETAILS AT TRAFFIC ISLANDS.

BID OPPORTUNITY No. 84-2005

UMA
Certificate of Authorization
UMA Engineering Ltd.
No. 256 Expiry: April 30, 2005

	GAS		MANHOLE		CONCRETE PAVEMENT
	MTS		CATCH BASIN/CATCH PIT		CONC. SIDEWALK/MEDIAN
	HYDRO		C & G INLET WITH BOX		ASPHALT PAVEMENT
	CATV		TREE		ASPHALT APPROACH
	TRAFFIC SIGNALS		TEST HOLE		ASPHALT SHOULDER
	LAND DRAINAGE SEWER		PROPERTY LINE		GRAVEL SHOULDER
	SANITARY/COMBINED SEWER		SURVEY BAR		RAMP CURB
	CATCHBASIN LEAD		GEODETIC MONUMENT		REMOVAL
	WATERMAIN		FENCE		SIGN
	SUBDRAIN		B.O. CURB/E.O. PAVEMENT		POLE
	DITCH/SWALE		ELEVATION		RAIL SIGNALS/SIGNS
	EXISTING		NEW		EXISTING
	LEGEND - PLAN		LEGEND - PLAN		NEW

LOCATION APPROVED UNDERGROUND STRUCTURES

SUPV. U/G STRUCTURES COMMITTEE DATE

NOTE:
LOCATION OF UNDERGROUND STRUCTURES AS SHOWN ARE BASED ON THE BEST INFORMATION AVAILABLE BUT NO GUARANTEE IS GIVEN THAT ALL EXISTING UTILITIES ARE SHOWN OR THAT THE GIVEN LOCATIONS ARE EXACT. CONFIRMATION OF EXISTENCE AND EXACT LOCATION OF ALL SERVICES MUST BE OBTAINED FROM THE INDIVIDUAL UTILITIES BEFORE PROCEEDING WITH CONSTRUCTION.

B.M. 6B67-001 ELEV. 234.148			
NO.	REVISIONS	DATE	BY
0	ISSUED FOR CONSTRUCTION	05/04/19	DL
A	ISSUED FOR CLIENT REVIEW	05/02/28	DL

UMA
An AECOM Company
2005 UMA ENGINEERING LTD. ALL RIGHTS RESERVED.

DESIGNED BY	WRJ	CHECKED BY	RFB
DRAWN BY	DID, DL	APPROVED BY	BWB
HOR. SCALE:	1:500	AUTHORIZED BY	R. FINCAS
VERTICAL:	1:20	DATE	05-04-19
		BRIDGE PROJECTS ENGINEER	

ENGINEER'S SEAL
PROVINCE OF MANITOBA
BRUCE W. BIGLOW
05-04-19
REGISTERED PROFESSIONAL ENGINEER

THE CITY OF WINNIPEG
PUBLIC WORKS DEPARTMENT
ENGINEERING DIVISION

Winnipeg

KENASTON UNDERPASS PROJECT
STERLING LYON PARKWAY WEST OF
KENASTON BOULEVARD

HORIZONTAL & VERTICAL ALIGNMENT
KENASTON BLVD TO S BND TO W BND TURN LANE

SHEET 19 OF 61
CAD FILE DRAWING NUMBER 01-CT1017_RX
CITY DRAWING NUMBER P-3258-79