

A1 SIZE 23.4" x 33.1" (594mm x 841mm) PLOT: 05/04/12 5:33:11 PM

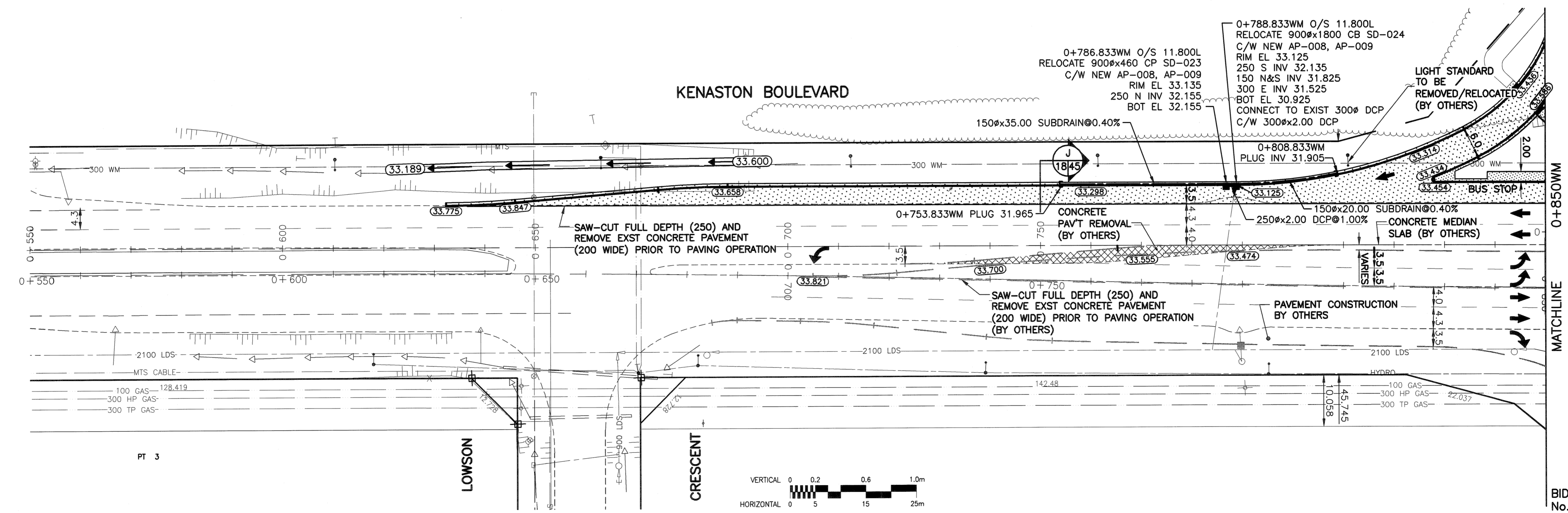
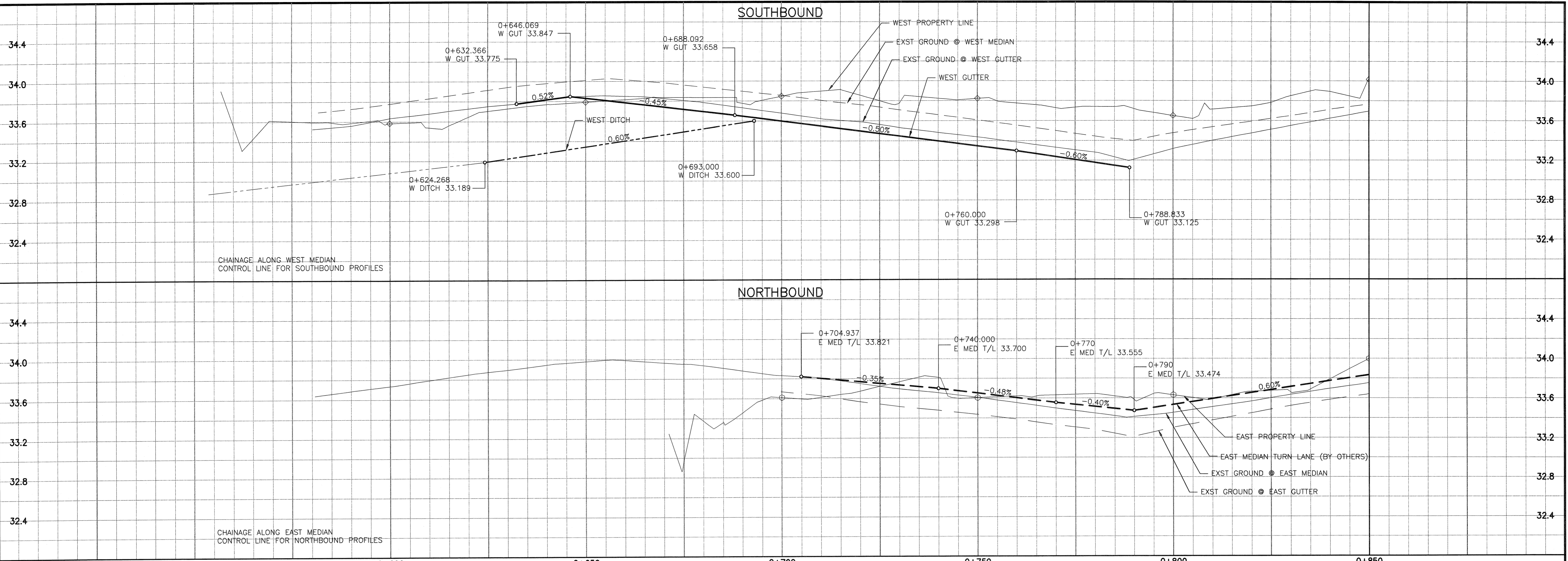

METRIC
WHOLE NUMBERS INDICATE MILLIMETRES
DECIMALIZED NUMBERS INDICATE METRES

WARNING
IF POWER EQUIPMENT OR EXPLOSIVES ARE TO BE USED FOR EXCAVATION ON THIS PROJECT THE CONTRACTOR MUST:
1) NOTIFY THE GAS COMPANY OF THE PROPOSED LOCATION OF EXCAVATION.
2) TAKE PRECAUTION TO AVOID DAMAGE TO GAS COMPANY INSTALLATIONS.
SEE PROVINCIAL REGULATION 140/92 FOR DETAILS

| | | | | | | |
|-----|---|-------------------------|---|-----------------------|---|------------------------|
| --- | ○ | MANHOLE | ● | CONCRETE PAVEMENT | ▨ | LOCATION APPROVED |
| --- | □ | CATCH BASIN/CATCH PIT | ■ | CONC. SIDEWALK/MEDIAN | ▩ | UNDERGROUND STRUCTURES |
| --- | △ | C & G INLET WITH BOX | ▲ | ASPHALT PAVEMENT | ▧ | |
| --- | ⊙ | TREE | ▲ | ASPHALT APPROACH | ▦ | |
| --- | ⊕ | TEST HOLE | ▲ | ASPHALT SHOULDER | ▥ | |
| --- | ⊖ | PROPERTY LINE | ▲ | GRAVEL SHOULDER | ▤ | |
| --- | ⊗ | SURVEY BAR | ▲ | RAMP CURB | ▣ | |
| --- | ⊘ | GEODETIC MONUMENT | ▲ | REMOVAL | ▢ | |
| --- | ⊙ | FENCE | ▲ | SIGN | □ | |
| --- | ⊚ | B.O. CURB/E.O. PAVEMENT | ▲ | POLE | ■ | |
| --- | ⊛ | ELEVATION (33.000) | ▲ | RAIL SIGNALS/SIGNS | ▤ | |
| --- | ⊜ | EXISTING | ▲ | NEW | ▥ | |
| --- | ⊝ | NEW | ▲ | EXISTING | ▦ | |

NOTE:
LOCATION OF UNDERGROUND STRUCTURES AS SHOWN ARE BASED ON THE BEST INFORMATION AVAILABLE BUT NO GUARANTEE IS GIVEN THAT ALL EXISTING UTILITIES ARE SHOWN OR THAT THE GIVEN LOCATIONS ARE EXACT. CONFIRMATION OF EXISTENCE AND EXACT LOCATION OF ALL SERVICES MUST BE OBTAINED FROM THE INDIVIDUAL UTILITIES BEFORE PROCEEDING WITH CONSTRUCTION.

| | | |
|--------------------------------|--------------------|--|
| B.M. QM67-001 ELEV. 234.148 | DESIGNED BY WRJ | CHECKED BY RFB |
| | DRAWN BY DID,DL | APPROVED BY Pant |
| | HOR. SCALE: 1:500 | AUTHORIZED BY: DATE |
| | VERTICAL: 1:20 | R. FINGAS PENG BRIDGE PROJECTS ENGINEER |
| | DATE 05/04/19 | |

UMA
An AECOM Company
2005 UMA ENGINEERING LTD. ALL RIGHTS RESERVED.

ENGINEER'S SEAL
PROVINCE OF MANITOBA
BRUCE W. BIGLOW
05-04-13
REGISTERED PROFESSIONAL ENGINEER

THE CITY OF WINNIPEG
PUBLIC WORKS DEPARTMENT
ENGINEERING DIVISION

Winnipeg

KENASTON UNDERPASS PROJECT
STERLING LYON PARKWAY WEST OF
KENASTON BOULEVARD

HORIZONTAL & VERTICAL ALIGNMENT
KENASTON BLVD S BND ACCELERATION LANE

SHEET 18 OF 61
CAD FILE DRAWING NUMBER 01-C1016_RX
CITY DRAWING NUMBER P-3258-78

BID OPPORTUNITY No. 84-2005
APECM Certificate of Authorization UMA Engineering Ltd. No. 256 Expiry: April 30, 2005