

NOTE:
STATIONS FOR ALL UNDERGROUND BASED ON CENTRELINE OF WILKES ROW

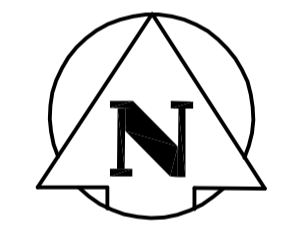
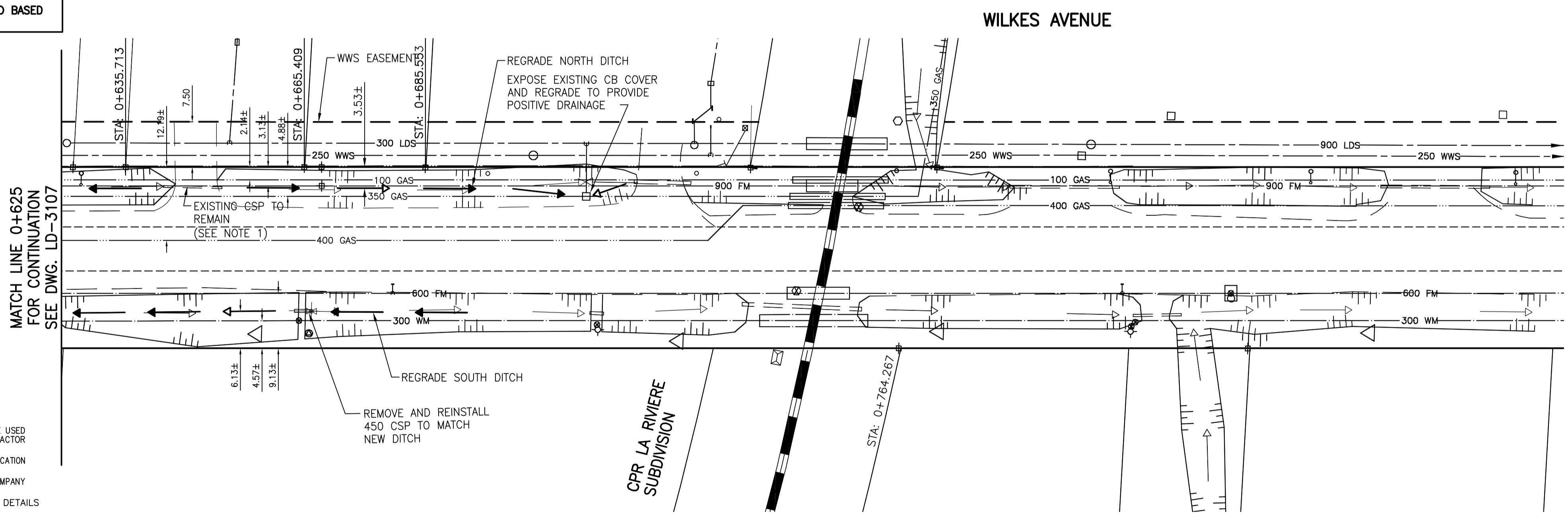

NOTES:
1. EXISTING CULVERTS TO REMAIN WILL BE INSPECTED BY CONTRACT ADMINISTRATOR PRIOR TO DITCH REGRADING. UPON INSPECTION, CONTRACT ADMINISTRATOR TO ADVISE CONTRACTOR OF CULVERT REPLACEMENT (IF REQUIRED).

WARNING

IF POWER EQUIPMENT OR EXPLOSIVES ARE TO BE USED FOR EXCAVATION ON THIS PROJECT THE CONTRACTOR MUST:
1) NOTIFY THE GAS COMPANY OF THE PROPOSED LOCATION OF EXCAVATION.
2) TAKE PRECAUTION TO AVOID DAMAGE TO GAS COMPANY INSTALLATIONS.
SEE PROVINCIAL REGULATION 140/92 FOR DETAILS

METRIC

WHOLE NUMBERS INDICATE MILLIMETRES
DECIMALIZED NUMBERS INDICATE METRES

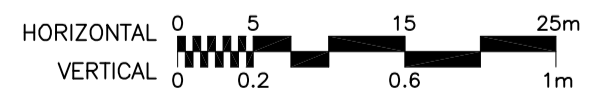

BENCH MARK: BOLT IN 12.5m CONC. PILE, 2.4m N. OF S.L. OF WILKES AVE. (FENCE LINE), & 7m E. OF E. FACE OF 2nd TOWER W. OF THE MOST ELY. SET OF TRACKS OF C.P.R. LA RIVIERE SUBD.

—	GAS	○	MANHOLE	●	HYDRANT	⊕
—	MTS	□	CATCH BASIN/CATCH PIT	■	WATERMAIN VALVE	⊗
—	HYDRO	△	C & G INLET WITH BOX	▲	GAS LINE MARKER	+
—	VIDEO	⊙	TREE	⊖	LIGHT STANDARD	⊕
—	TRAFFIC SIGNALS	⊙TH#10	TEST HOLE	⊖	GUY WIRE	⊕
—	LAND DRAINAGE SEWER	—	PROPERTY LINE	—	TRAFFIC SIGNAL	⊕
—	SANITARY/COMBINED SEWER	—	SURVEY BAR	—	SIGN	⊕
—	CATCHBASIN LEAD	—	GEODETIC MONUMENT	—	SIGNAL PIT	⊕
—	WATERMAIN	—	FENCE	—	HYDRO MARKER	⊕
—	SUBDRAIN	—	BACK OF CURB	—	BOLLARD	⊕
—	DITCH	—	ELEVATION	—		
←	EXISTING	←	LEGEND - PLAN	←	EXISTING	←
—	NEW	—	LEGEND - PLAN	—	NEW	—

LOCATION APPROVED UNDERGROUND STRUCTURES
SUPV. U/G STRUCTURES COMMITTEE DATE
NOTE: LOCATION OF UNDERGROUND STRUCTURES AS SHOWN ARE BASED ON THE BEST INFORMATION AVAILABLE BUT NO GUARANTEE IS GIVEN THAT ALL EXISTING UTILITIES ARE SHOWN OR THAT THE GIVEN LOCATIONS ARE EXACT. CONFIRMATION OF EXISTENCE AND EXACT LOCATION OF ALL SERVICES MUST BE OBTAINED FROM THE INDIVIDUAL UTILITIES BEFORE PROCEEDING WITH CONSTRUCTION.

B.M. ELEV.	66-001	233.425m	
NO.	REVISIONS	DATE	BY
1	ISSUED FOR TENDER	05.03.29	GWM
0	ISSUED FOR CLIENT REVIEW	05.02.28	AJR

Stantec Consulting Ltd.
905 Waverley Street, Winnipeg, Manitoba
Tel 204-489-5900 Fax 204-453-9012

DESIGNED BY	JKH	CHECKED BY	AJR
DRAWN BY	TAG	APPROVED BY	GWM
HOR. SCALE:	1:500	AUTHORIZED BY:	R. FINGAS
VERTICAL:	1:50	DATE	05.03.24
			R. FINGAS, P. ENG. BRIDGE PROJECTS ENGINEER

ENGINEER'S SEAL
ORIGINAL SEALED BY
A.J. RAPOSO
P. ENG.
05.03.24
CONSULTANT DRAWING NO.
I13703042-UI3

THE CITY OF WINNIPEG
PUBLIC WORKS DEPARTMENT
ENGINEERING DIVISION

Winnipeg

KENASTON UNDERPASS
KENASTON BLVD /CN RIVERS SUB MILE 5 18

DITCH REGRADING
STA 0+625 TO CPR LA RIVIERE SUBDIVISION

SHEET **43** OF **60**
CAD FILE DRAWING NUMBER
wilkes-ug.dwg
CITY DRAWING NUMBER
LD-3108

APEGM
Certificate of Authorization
Stantec Consulting Ltd.
No. 1301 Expiry: April 30, 2005