

NOTE: STATIONS FOR ALL UNDERGROUND BASED ON SOUTH CONTROL LINE.

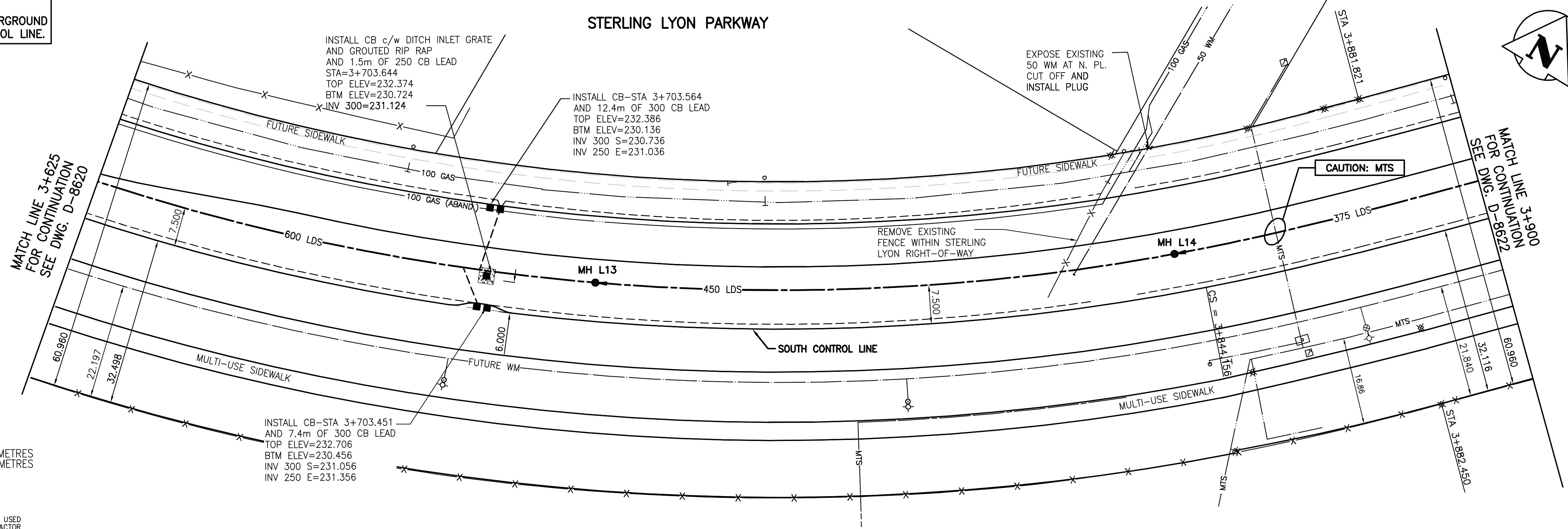

- NOTES:
1. ALL CATCH BASINS INSTALLED IN MEDIAN DITCH TO BE SD-025, SEE DETAIL DWG. D-8631.
  2. DOUBLE INLETS TO BE SD-023 AND SD-024 WITH SD-108 COVER, SEE DETAIL DWG. D-8631.
  3. ALL INLETS TO HAVE 250mm INTER CONNECTION PIPING AND 300 LEADS TO MAIN LINE, SEE DETAIL DWG. D-8631.
  4. FUTURE WM AND WWS SHOWN FOR INFORMATION PURPOSES. FINAL DESIGN TO BE CONFIRMED BY THE CITY OF WINNIPEG, WATER AND WASTE DEPT.

**METRIC**  
WHOLE NUMBERS INDICATE MILLIMETRES  
DECIMALIZED NUMBERS INDICATE METRES

**WARNING**  
IF POWER EQUIPMENT OR EXPLOSIVES ARE TO BE USED FOR EXCAVATION ON THIS PROJECT THE CONTRACTOR MUST:  
1) NOTIFY THE GAS COMPANY OF THE PROPOSED LOCATION OF EXCAVATION.  
2) TAKE PRECAUTION TO AVOID DAMAGE TO GAS COMPANY INSTALLATIONS.  
SEE PROVINCIAL REGULATION 140/92 FOR DETAILS

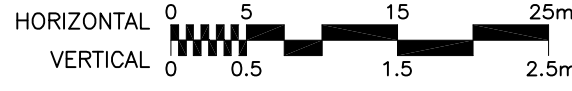

BENCH MARK: BOLT IN 12.5m CONC. PILE, 2.4m N. OF S.L. OF WILKES AVE. (FENCE LINE), & 7m E. OF E. FACE OF 2nd TOWER W. OF THE MOST ELY. SET OF TRACKS OF C.P.R. LA RIVIERE SUBD.

**APEGM**  
Certificate of Authorization  
Stantec Consulting Ltd.  
No. 1301 Expiry: April 30, 2005

EXISTING	LEGEND - PLAN	NEW	EXISTING	LEGEND - PLAN	NEW	EXISTING	LEGEND - PLAN	NEW
○	GAS	○	MANHOLE	●	HYDRANT	+	LOCATION APPROVED UNDERGROUND STRUCTURES	
□	MTS	□	CATCH BASIN/CATCH PIT	●	WATERMAIN VALVE	+		
△	HYDRO	△	C & G INLET WITH BOX	▲	GAS LINE MARKER	+		
○	VIDEO	○	TREE	+	LIGHT STANDARD	+		
—	TRAFFIC SIGNALS	⊙	TEST HOLE	+	GUY WIRE	+		
—	LAND DRAINAGE SEWER	—	PROPERTY LINE	+	TRAFFIC SIGNAL	+		
—	SANITARY/COMBINED SEWER	—	SURVEY BAR	+	SIGN	+		
—	CATCHBASIN LEAD	—	GEODETIC MONUMENT	+	SIGNAL PIT	+		
—	WATERMAIN	—	FENCE	+	HYDRO MARKER	+		
—	SUBDRAIN	—	BACK OF CURB	+	BOLLARD	+		
—	DITCH	—	ELEVATION	+	FORCEMAIN	+		

LOCATION APPROVED UNDERGROUND STRUCTURES  
SUPV. U/G STRUCTURES COMMITTEE DATE  
NOTE: LOCATION OF UNDERGROUND STRUCTURES AS SHOWN ARE BASED ON THE BEST INFORMATION AVAILABLE BUT NO GUARANTEE IS GIVEN THAT ALL EXISTING UTILITIES ARE SHOWN OR THAT THE GIVEN LOCATIONS ARE EXACT. CONFIRMATION OF EXISTENCE AND EXACT LOCATION OF ALL SERVICES MUST BE OBTAINED FROM THE INDIVIDUAL UTILITIES BEFORE PROCEEDING WITH CONSTRUCTION.

NO.	REVISIONS	DATE	BY
1	ISSUED FOR TENDER	05.03.29	GWM
0	ISSUED FOR CLIENT REVIEW	05.02.28	AJR

**Stantec Consulting Ltd.**  
905 Waverley Street, Winnipeg, Manitoba  
Tel 204-489-5900 Fax 204-453-9012

DESIGNED BY: JKH  
CHECKED BY: AJR  
DRAWN BY: TAG  
APPROVED BY: GWM  
HOR. SCALE: 1:500  
VERTICAL: 1:50  
AUTHORIZED BY: R. FINGAS  
DATE: 05.03.24  
R. FINGAS, P. ENG.  
BRIDGE PROJECTS ENGINEER

ENGINEER'S SEAL  
ORIGINAL SEALED BY A.J. RAPOSO P. ENG. 05.03.24  
CONSULTANT DRAWING NO. I13703042-U06

**THE CITY OF WINNIPEG**  
PUBLIC WORKS DEPARTMENT  
ENGINEERING DIVISION

**Winnipeg**

**KENASTON UNDERPASS**  
STERLING LYON PARKWAY (EAST)

LAND DRAINAGE SYSTEM  
STA 3+625 TO STA 3+900

SHEET 36 OF 60  
CAD FILE DRAWING NUMBER slp-u06.dwg  
CITY DRAWING NUMBER D-8621