

WATER SERVICE INFORMATION

ADDRESS	SIZE STREET	SIZE PROP	SHORT & LONG MEASUREMENT	CORP LOCATION	REMARKS
252 OXFORD ST RESIDENTIAL	20 COPPER	20	0.30 S/NHL	1.52 N/SC	WM. RENEWAL JUL/00
258 OXFORD ST RESIDENTIAL	20 COPPER	20	17.07>NNL KINGSWAY	1.52 N OF SC	SEWER RENEWAL MAY/97 NEW SERV. TO PROP. SEE SKETCH
259 OXFORD ST RESIDENTIAL	20 COPPER	20	3.05 S OF VALVE	0.49 N/SC	WM.RENEWAL JUL/00
269 OXFORD ST RESIDENTIAL	20 COPPER	16	1.52 S/NHL	3.11 S/SC	BR SERV WITH #273 SEWER RENEWAL MAY/97 NEW SERV. TO PROP. NEW SC/BOX & NEW COPPER WM TO SC SEE SKETCH
344 KINGSWAY AVE RESIDENTIAL	20 COPPER	13	20.42>NNL KINGSWAY	OPP S/C	94/05/30-POOR PRESSURE; CUST. NOTIFIED RE INTERNAL PROBLEMS
311 CAMBRIDGE ST RESIDENTIAL	13 LEAD	13	13.81 SSL KINGSWAY	0.30 S/SC	NOV 12/02- NOTICE LEFT IN ERROR/L.W. SERVICED FROM CAMBRIDGE FURTHER CORP/TEE MEAS- 31>NNL KINGSWAY
			14.02 SSL KINGSWAY		
			2.13 N/SHL		
			9.75>NNL KINGSWAY		

SEWER SERVICE INFORMATION

ADDRESS	SIZE	R DIST JUNCTION TIE	REMARKS
252 OXFORD ST RESIDENTIAL	150 PVC	22.25 EW LOTLINE	SERVICED OFF KINGSWAY (HOUSEFILES)
258 OXFORD ST RESIDENTIAL	150 PVC	32.0 E MH @ OXFORD	SERVICED OFF OXFORD (HOUSEFILES)
259 OXFORD ST RESIDENTIAL	150 PVC	0.3 SNL HSE	SERVICED OFF OXFORD (HOUSEFILES)
269 OXFORD ST RESIDENTIAL	150 PVC	0.70 S 1ST MH S KINGSWAY	SERVICED OFF OXFORD (HOUSEFILES)
344 KINGSWAY AVE RESIDENTIAL	150	6.70 SN LOTLINE	SERVICED OFF OXFORD (HOUSEFILES)
311 CAMBRIDGE ST RESIDENTIAL	150	73.15 S 2ND MH N KINGSWAY	SERVICED OFF OXFORD (HOUSEFILES)
		13.99 SSL KINGSWAY	SERVICED FROM KINGSWAY (HOUSEFILES)
		9.69 S 1ST MH S KINGSWAY	SERVICED FROM KINGSWAY (HOUSEFILES)
		9.93 E OF W LOTLINE	SERVICED FROM KINGSWAY (HOUSEFILES)
		28.70 W 1ST MH W CAMBRIDGE	SERVICED OFF CAMBRIDGE (HOUSEFILES)
		10.36 NN LOTLINE	SERVICED OFF CAMBRIDGE (HOUSEFILES)
		89.81 S OF MH @ DROMORE AVE	

NOTE: CHAINAGES SHOWN ARE ALONG N. R. OF KINGSWAY AVE.

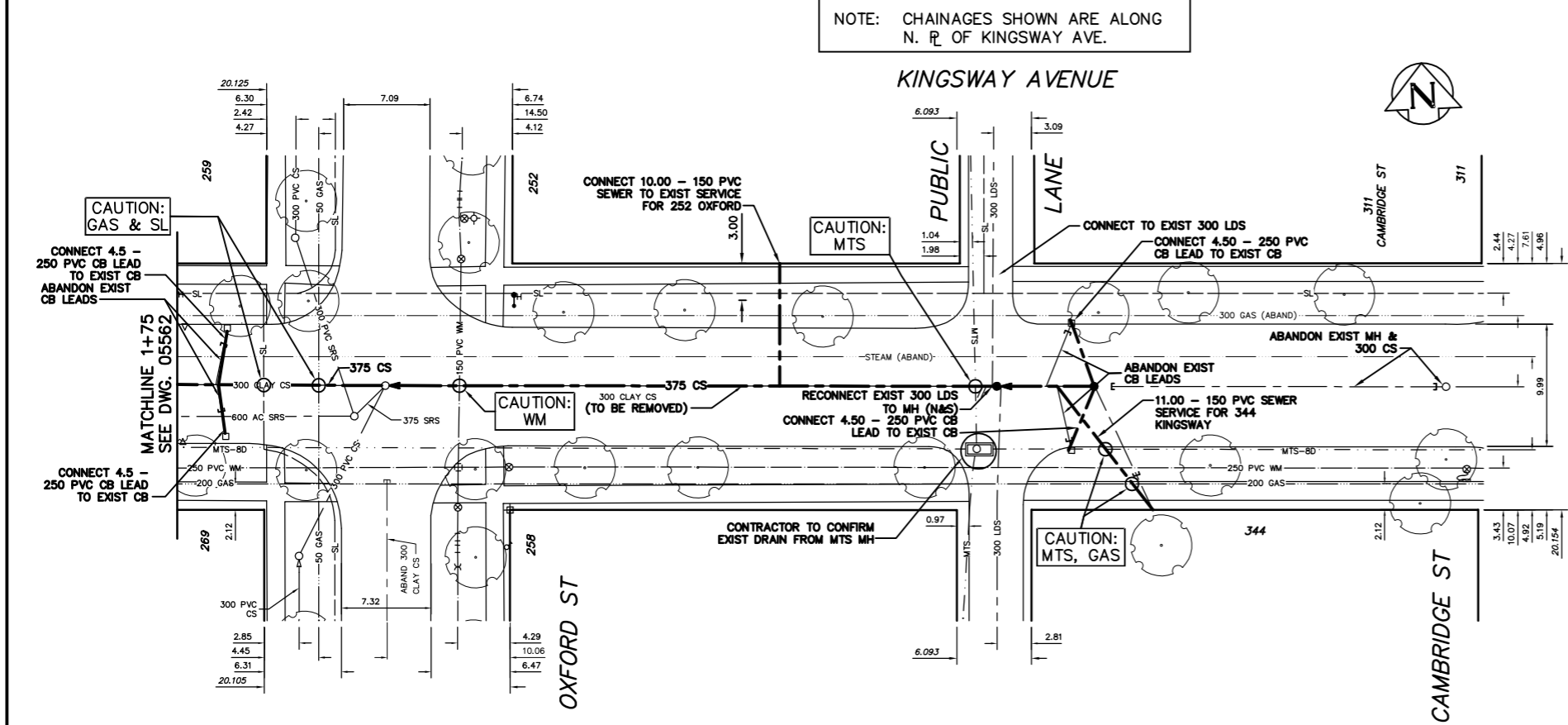

FOR CONSTRUCTION NOTES SEE DRAWING 05562

METRIC
WHOLE NUMBERS INDICATE MILLIMETRES
DECIMALIZED NUMBERS INDICATE METRES

WARNING
IF POWER EQUIPMENT OR EXPLOSIVES ARE TO BE USED FOR EXCAVATION ON THIS PROJECT THE CONTRACTOR MUST:
1) NOTIFY THE GAS COMPANY OF THE PROPOSED LOCATION OF EXCAVATION.
2) TAKE PRECAUTION TO AVOID DAMAGE TO GAS COMPANY INSTALLATIONS.
SEE PROVINCIAL REGULATION 210/72 FOR DETAILS

<table border="1"> <tr> <td>200 WM</td> <td>WATERMAIN</td> <td>200 WM</td> <td>SL, HYDRO</td> <td>150 WM</td> <td>WATERMAIN</td> <td>150 WM</td> </tr> <tr> <td>⊕</td> <td>HYDRANT</td> <td>⊕</td> <td>MTS</td> <td>⊕</td> <td>HYDRANT</td> <td>⊕</td> </tr> <tr> <td>⊙</td> <td>VALVE</td> <td>⊙</td> <td>TRAFFIC SIGNALS</td> <td>⊙</td> <td>VALVE</td> <td>⊙</td> </tr> <tr> <td>525 LDS</td> <td>LAND DRAINAGE SEWER</td> <td>525 LDS</td> <td>GAS</td> <td>300 LDS</td> <td>LAND DRAINAGE SEWER</td> <td>300 LDS</td> </tr> <tr> <td>375 WWS</td> <td>WASTEWATER SEWER</td> <td>375 WWS</td> <td>SURVEY BAR</td> <td>250 WWS</td> <td>WASTEWATER SEWER</td> <td>250 WWS</td> </tr> <tr> <td>○</td> <td>MANHOLE</td> <td>○</td> <td>FENCE</td> <td>⊕</td> <td>PROFILE</td> <td>⊕</td> </tr> <tr> <td>□</td> <td>CATCH BASIN</td> <td>□</td> <td>POLE - HYDRO, MTS</td> <td>⊕</td> <td>GROUND ABOVE PIPE</td> <td>⊕</td> </tr> <tr> <td>▽</td> <td>CURB INLET</td> <td>▽</td> <td>CURB STOP</td> <td>⊕</td> <td>DITCH (SOUTH & EAST)</td> <td>⊕</td> </tr> <tr> <td>⊕</td> <td>JUNCTIONS</td> <td>⊕</td> <td>GUY ANCHOR</td> <td>⊕</td> <td>GUTTER (NORTH & WEST)</td> <td>⊕</td> </tr> <tr> <td>⊕</td> <td>CULVERT</td> <td>⊕</td> <td>LIGHT STANDARD</td> <td>⊕</td> <td></td> <td>⊕</td> </tr> <tr> <td>⊕</td> <td>ANODE</td> <td>⊕</td> <td>TREE</td> <td>⊕</td> <td></td> <td>⊕</td> </tr> <tr> <td>EXISTING</td> <td>LEGEND-PLAN</td> <td>PROPOSED</td> <td>EXISTING</td> <td>LEGEND-PLAN</td> <td>PROPOSED</td> <td>EXISTING</td> </tr> <tr> <td>EXISTING</td> <td>LEGEND-PROFILE</td> <td>PROPOSED</td> <td>EXISTING</td> <td>LEGEND-PROFILE</td> <td>PROPOSED</td> <td>EXISTING</td> </tr> </table>	200 WM	WATERMAIN	200 WM	SL, HYDRO	150 WM	WATERMAIN	150 WM	⊕	HYDRANT	⊕	MTS	⊕	HYDRANT	⊕	⊙	VALVE	⊙	TRAFFIC SIGNALS	⊙	VALVE	⊙	525 LDS	LAND DRAINAGE SEWER	525 LDS	GAS	300 LDS	LAND DRAINAGE SEWER	300 LDS	375 WWS	WASTEWATER SEWER	375 WWS	SURVEY BAR	250 WWS	WASTEWATER SEWER	250 WWS	○	MANHOLE	○	FENCE	⊕	PROFILE	⊕	□	CATCH BASIN	□	POLE - HYDRO, MTS	⊕	GROUND ABOVE PIPE	⊕	▽	CURB INLET	▽	CURB STOP	⊕	DITCH (SOUTH & EAST)	⊕	⊕	JUNCTIONS	⊕	GUY ANCHOR	⊕	GUTTER (NORTH & WEST)	⊕	⊕	CULVERT	⊕	LIGHT STANDARD	⊕		⊕	⊕	ANODE	⊕	TREE	⊕		⊕	EXISTING	LEGEND-PLAN	PROPOSED	EXISTING	LEGEND-PLAN	PROPOSED	EXISTING	EXISTING	LEGEND-PROFILE	PROPOSED	EXISTING	LEGEND-PROFILE	PROPOSED	EXISTING	<p>LOCATION APPROVED UNDERGROUND STRUCTURES</p> <p>SUPV. U/G STRUCTURES COMMITTEE DATE</p> <p>NOTE: LOCATION OF UNDERGROUND STRUCTURES AS SHOWN ARE BASED ON THE BEST INFORMATION AVAILABLE BUT NO GUARANTEE IS GIVEN THAT ALL EXISTING UTILITIES ARE SHOWN OR THAT THE GIVEN LOCATIONS ARE EXACT. CONFIRMATION OF EXISTENCE AND EXACT LOCATION OF ALL SERVICES MUST BE OBTAINED FROM THE INDIVIDUAL UTILITIES BEFORE PROCEEDING WITH CONSTRUCTION.</p>	<p>B.M. ELEV. FIELD BOOK #</p> <p>POSTED TO LBS</p> <p>NO. REVISIONS DATE BY</p>	<p>CITY OF WINNIPEG WATER AND WASTE ENGINEERING DIVISION</p> <p>DESIGNED BY NC CHECKED BY TW/KZ</p> <p>DRAWN BY C.JH/WKT APPROVED BY KZ</p> <p>HOR. SCALE 1:250 VERTICAL 1:50</p> <p>RELEASED FOR CONSTRUCTION</p> <p>DATE 2005 04 11 DATE</p>	<p>ENGINEER'S SEAL</p> <p>ORIGINAL SIGNED BY K.R. ZUREK 05/04/11</p>	<p>THE CITY OF WINNIPEG WATER AND WASTE DEPARTMENT</p> <p>2005 SEWER RENEWALS AND ASSOCIATED WORKS KINGSWAY AVENUE MH AT Q OXFORD ST TO 35 m W OF CAMBRIDGE ST</p>	<p>SHEET 2 of 10</p> <p>CITY DRAWING NUMBER 05563</p>
200 WM	WATERMAIN	200 WM	SL, HYDRO	150 WM	WATERMAIN	150 WM																																																																																											
⊕	HYDRANT	⊕	MTS	⊕	HYDRANT	⊕																																																																																											
⊙	VALVE	⊙	TRAFFIC SIGNALS	⊙	VALVE	⊙																																																																																											
525 LDS	LAND DRAINAGE SEWER	525 LDS	GAS	300 LDS	LAND DRAINAGE SEWER	300 LDS																																																																																											
375 WWS	WASTEWATER SEWER	375 WWS	SURVEY BAR	250 WWS	WASTEWATER SEWER	250 WWS																																																																																											
○	MANHOLE	○	FENCE	⊕	PROFILE	⊕																																																																																											
□	CATCH BASIN	□	POLE - HYDRO, MTS	⊕	GROUND ABOVE PIPE	⊕																																																																																											
▽	CURB INLET	▽	CURB STOP	⊕	DITCH (SOUTH & EAST)	⊕																																																																																											
⊕	JUNCTIONS	⊕	GUY ANCHOR	⊕	GUTTER (NORTH & WEST)	⊕																																																																																											
⊕	CULVERT	⊕	LIGHT STANDARD	⊕		⊕																																																																																											
⊕	ANODE	⊕	TREE	⊕		⊕																																																																																											
EXISTING	LEGEND-PLAN	PROPOSED	EXISTING	LEGEND-PLAN	PROPOSED	EXISTING																																																																																											
EXISTING	LEGEND-PROFILE	PROPOSED	EXISTING	LEGEND-PROFILE	PROPOSED	EXISTING																																																																																											