

- NOTES:
1. ALL 120V AND 208V LOADS ARE FED FROM LP-R31 UNLESS OTHERWISE NOTED.
 2. EMERGENCY LIGHTING EM-X-1 ARE FED FROM BATTERY PACK EM-X.
 3. MOUNT TYPE LUMINARIES AT 2.4m ABOVE THE FLOOR.

THIRD FLOOR POWER AND LIGHTING PLAN
1:100

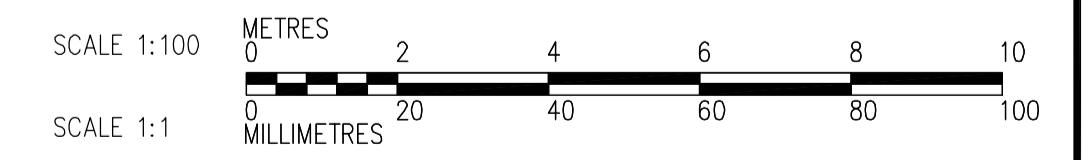
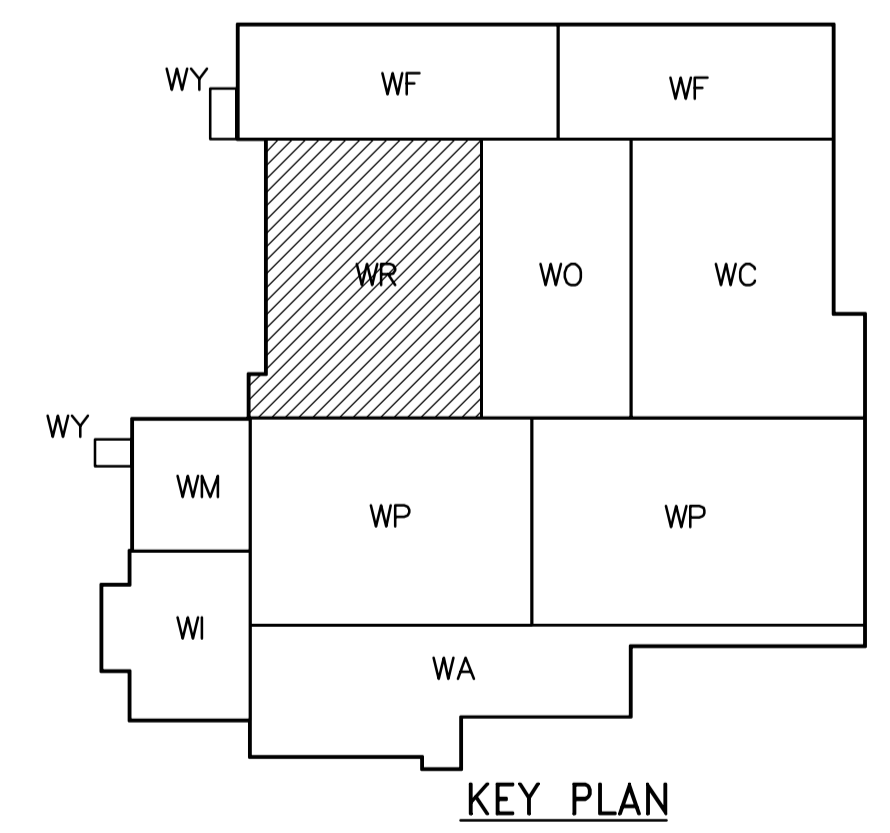

<p>Certificate of Authorization CH2M HILL Canada Ltd. No. 1441 Expiry: April 30, 2007</p>	<p>Frederickson Cooper ARCHITECTS</p>		<p>A Terra International Ltd. Company</p>		<p>ENGINEER'S SEAL</p> <p>ORIGINAL SIGNED BY L.D. LLEWELLYN 2006/03/29</p>	<p>THE CITY OF WINNIPEG WATER AND WASTE DEPARTMENT ENGINEERING DIVISION</p>	<p>WATER TREATMENT PLANT RESIDUALS HANDLING MECHANICAL AND ELECTRICAL</p>	<p>CITY FILE NUMBER</p>
	<p>DESIGNED BY LL</p> <p>CHECKED BY ND</p> <p>DRAWN BY TL</p> <p>APPROVED BY AHL</p> <p>SCALE: 1:100</p> <p>RELEASED FOR CONSTRUCTION BY: R. SOROKOWSKI</p> <p>DATE 2005/07/12</p> <p>DATE 2006/03/29</p>	<p>CONSULTANT DRAWING NO. WR-E0133</p>	<p>ELECTRICAL RESIDUALS HANDLING AREA THIRD FLOOR POWER AND LIGHTING PLAN</p>	<p>SHEET OF</p> <p>CITY DRAWING NUMBER 1-0601R-A-E0133-001-01D</p>				

NO.	REVISIONS	DATE	BY
01	742-2005 ADDENDUM 3	06/05/05	LL
00	ISSUED FOR TENDER	06/03/29	LL