

- NOTES:**
1. ALL 120V AND 208V LOADS ARE FED FROM LP-P11.
 2. EMERGENCY LIGHTING EM-X-1, -2 ETC ARE FED FROM BATTERY PACK EM-X.
 3. MOUNT TYPE A LUMINAIRE AT 3.4m ABOVE FINISHED FLOOR.

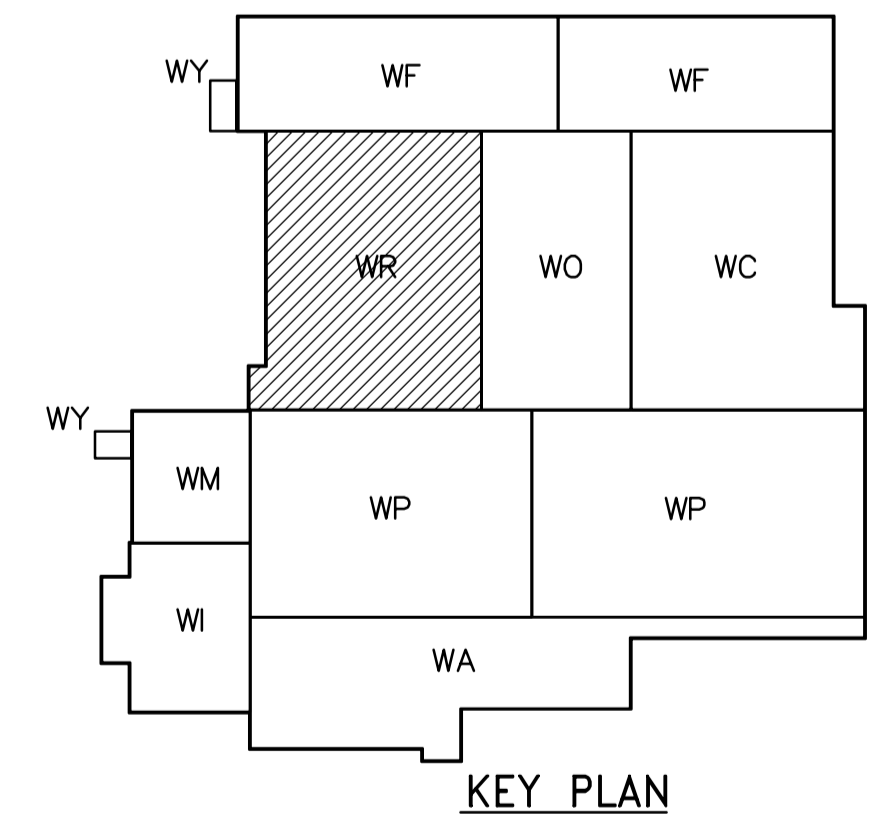

FIRST FLOOR POWER AND LIGHTING PLAN
1:100

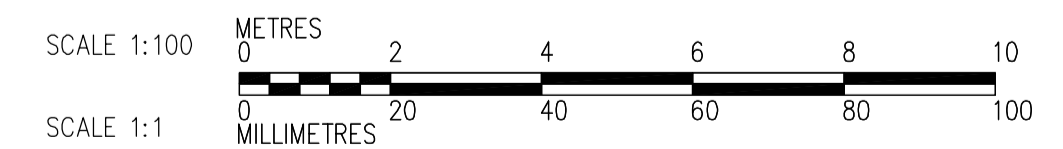

<p>APEGN Certificate of Authorization CH2M HILL Canada Ltd. No. 1441 Expiry: April 30, 2007</p>	<p>Frederickson Cooper ARCHITECTS</p>	<p>A You International Ltd. Company</p>	<p>ENGINEER'S SEAL</p> <p>ORIGINAL SIGNED BY L.D. LLEWELLYN 2006/03/29</p>	<p>THE CITY OF WINNIPEG WATER AND WASTE DEPARTMENT ENGINEERING DIVISION</p> <p>WATER TREATMENT PLANT RESIDUALS HANDLING AREA MECHANICAL AND ELECTRICAL</p> <p>ELECTRICAL RESIDUALS HANDLING AREA FIRST FLOOR POWER AND LIGHTING PLAN</p>	
	<p>DESIGNED BY LL</p> <p>CHECKED BY ND</p>	<p>DRAWN BY TLL</p> <p>APPROVED BY AHL</p>	<p>SCALE: 1:100</p> <p>RELEASED FOR CONSTRUCTION BY: R. SOROKOWSKI</p>		<p>CITY FILE NUMBER</p> <p>SHEET OF</p>
	<p>01 742-2005 ADDENDUM 3 06/05/05 LL</p> <p>00 ISSUED FOR TENDER 06/02/15 LL</p>	<p>SCALE: 1:100</p> <p>DATE 2005/07/12</p>	<p>DATE 2006/03/29</p> <p>CONSULTANT DRAWING NO. WR-E0113</p>		<p>CITY DRAWING NUMBER 1-0601R-A-E0113-001-01D</p>
	<p>NO. REVISIONS</p>	<p>DATE BY</p>	<p>DATE</p>		