

NOTES:
 1. ALL 120V AND 208V LOADS ARE FED FROM LP-M11.
 2. EMERGENCY LIGHTING EM-X-1 ARE FED FROM BATTERY PACK EM-X.
 3. MOUNT TYPE A LUMINAIRE AT 3.0m ABOVE THE FLOOR.
 4. SEE DWG-WB-E0401 FOR LIGHT MOUNTING DETAIL

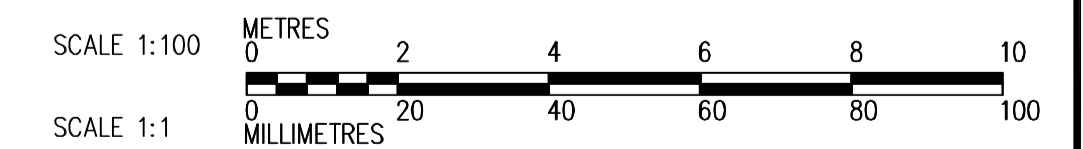

THIRD FLOOR POWER AND LIGHTING PLAN
 1:100

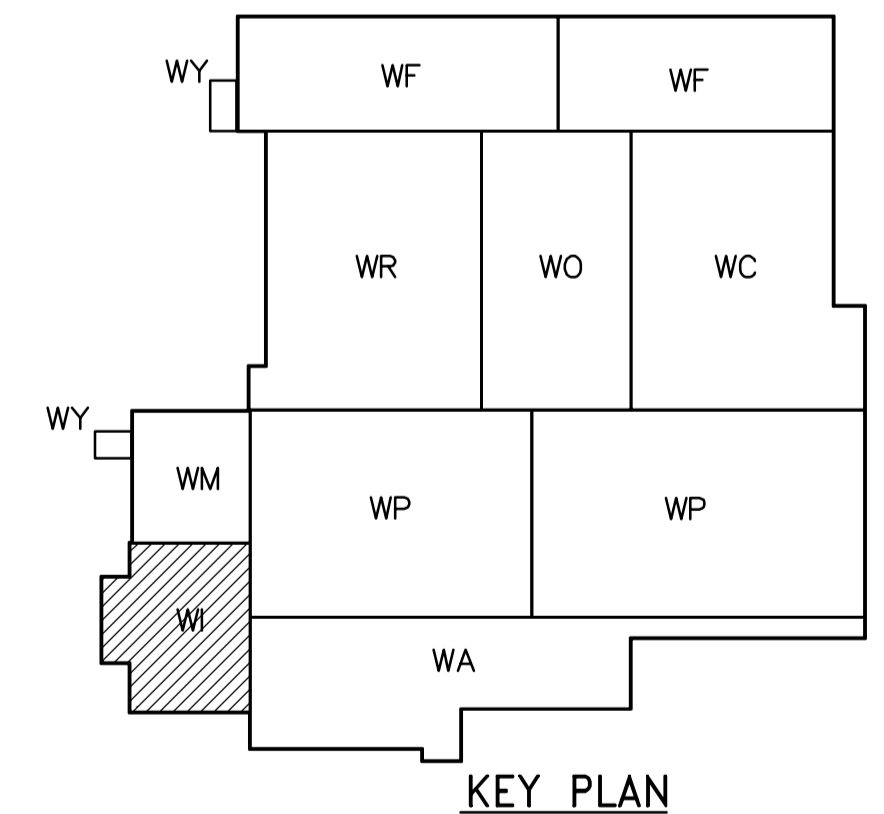

<p>APEGN Certificate of Authorization CH2M HILL Canada Ltd. No. 1441 Expiry: April 30, 2007</p>	B.M. ELEV.	<p>Frederickson Cooper ARCHITECTS</p>	<p>EarthTech A Tyco International Ltd. Company</p>	ENGINEER'S SEAL ORIGINAL SIGNED BY L.D. LLEWELLYN 2006/03/29	<p>THE CITY OF WINNIPEG WATER AND WASTE DEPARTMENT ENGINEERING DIVISION</p>	
	DESIGNED BY LL CHECKED BY ND DRAWN BY TL APPROVED BY AHL	SCALE: 1:100 RELEASED FOR CONSTRUCTION BY: R. SOROKOWSKI	CONSULTANT DRAWING NO. WI-E0133	WATER TREATMENT PLANT INLET WORKS AND RAW WATER PUMPING MECHANICAL AND ELECTRICAL		CITY FILE NUMBER SHEET OF
	NO. REVISIONS DATE BY	DATE 2005/07/13 DATE 2006/03/29	ELECTRICAL RAW WATER PUMPING STATION AREA THIRD FLOOR POWER AND LIGHTING PLAN	CITY DRAWING NUMBER 1-06011-A-E0133-001-01D		
	01 742-2005 ADDENDUM 3 06/05/05 LL 00 ISSUED FOR TENDER 06/03/29 LL					