

NOTES:
 1. CONTRACTOR TO VERIFY LIMITS OF SEWER REPAIRS PRIOR TO EXCAVATION BY MEANS OF VIDEO INSPECTION.
 2. CONTRACTOR TO PROVIDE VIDEO INSPECTION OF SEWER SERVICES WITHIN LIMITS OF REPAIR OR RENEWAL IN PRESENCE OF CONTRACT ADMINISTRATOR TO DETERMINE IF SERVICE RENEWAL IS REQUIRED.

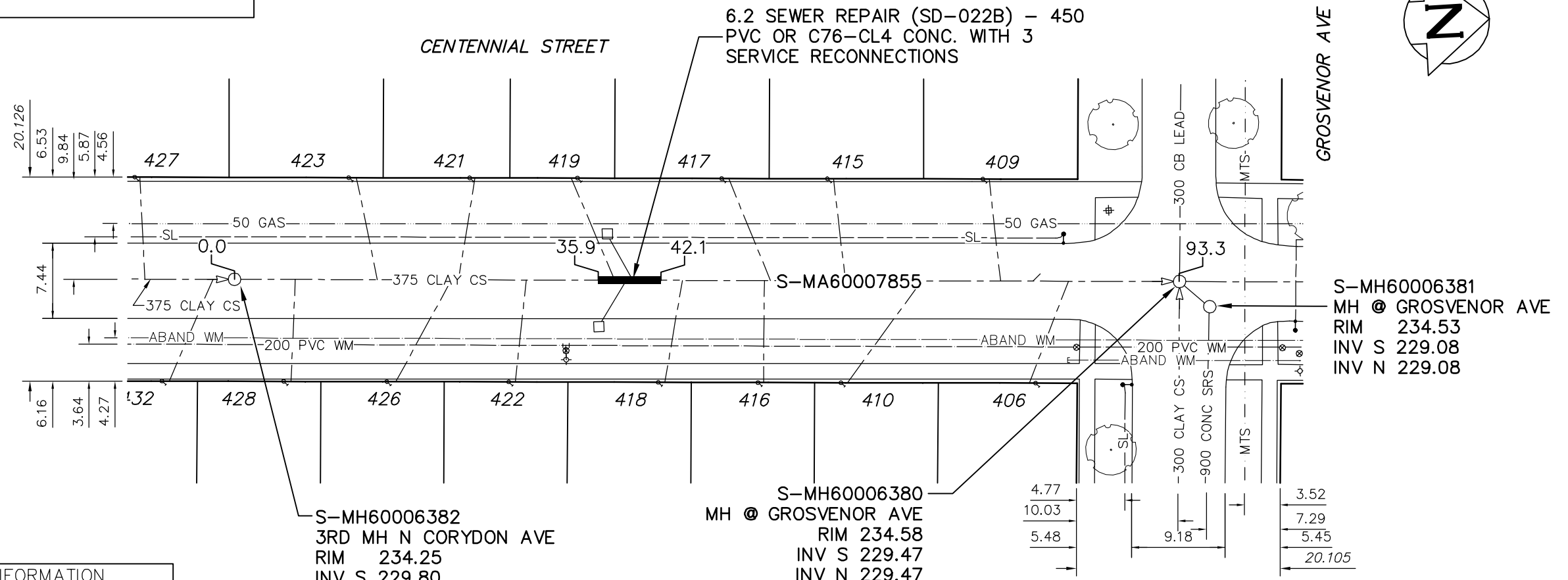

SEWER JUNCTION INFORMATION FROM VIDEO INSPECTION

DISTANCE FROM 1st MH (S-MH60006382) S OF GROSVENOR AVENUE

6.00	N	150	EAST	428	CENTENNIAL ST
14.10	N	150	WEST	423	CENTENNIAL ST
21.40	N	150	EAST	426	CENTENNIAL ST
22.10	N	150	WEST	421	CENTENNIAL ST
28.80	N	150	EAST	422	CENTENNIAL ST
37.50	N	150	WEST	419	CENTENNIAL ST
38.70	N	150	EAST	CB LEAD	
39.30	N	150	WEST	CB LEAD	
44.20	N	150	EAST	418	CENTENNIAL ST
52.30	N	150	EAST	416	CENTENNIAL ST
52.90	N	150	WEST	417	CENTENNIAL ST
60.30	N	150	WEST	415	CENTENNIAL ST
67.80	N	150	EAST	410	CENTENNIAL ST
75.60	N	150	WEST	409	CENTENNIAL ST
78.80	N	150	WEST	-	
82.30	N	150	EAST	406	CENTENNIAL ST

S-MH60006382
 3RD MH N CORYDON AVE
 RIM 234.25
 INV S 229.80
 INV N 229.80

S-MH60006380
 MH @ GROSVENOR AVE
 RIM 234.58
 INV S 229.47
 INV N 229.47
 INV E 229.47
 INV W 229.47

S-MH60006381
 MH @ GROSVENOR AVE
 RIM 234.53
 INV S 229.08
 INV N 229.08

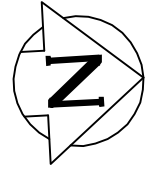

ENGINEER'S SEAL

ORIGINAL SIGNED BY K.R. ZUREK
 05/12/07

BID OPPORTUNITY No: 683-2005
 FILENAME : Centennial_EPR's.dwg
 PLOT DATE : 2005 12 08

LEGEND:
 52.0 | MEASUREMENT TO REPAIR FROM REFERENCE MH SHOWN THUS... 0.0

METRIC
 WHOLE NUMBERS INDICATE MILLIMETRES
 DECIMALIZED NUMBERS INDICATE METRES

B.M. ELEV.	FIELD BOOK #:	CITY OF WINNIPEG WATER AND WASTE ENGINEERING DIVISION		THE CITY OF WINNIPEG WATER AND WASTE DEPARTMENT	
POSTED TO LIS		DESIGNED BY: NC	CHECKED BY: TW/KZ	2005 COMBINED SEWER RENEWALS AND SEWER REPAIRS CONTRACT 18	
		DRAWN BY: HL/CJH	APPROVED BY: KZ	CENTENNIAL STREET	
		HOR. SCALE 1:500	RELEASED FOR CONSTRUCTION	3RD MH NORTH CORYDON AVENUE TO MH AT GROSVENOR AVENUE	
		VERTICAL		SHEET 3 OF 10	
NO.	REVISIONS	DATE	BY	CITY DRAWING NUMBER	
				05702	
		DATE	2005 12 08		