

CONSTRUCTION NOTES

- 1) CURB AND GUTTER AND CURB REPLACEMENT AS DIRECTED BY THE CONTRACT ADMINISTRATOR
- 2) ALL STREET RADIUS CURB UNDER 15M RADIUS SHALL BE REPLACED AS MODIFIED BARRIER CURB OR AS DIRECTED BY THE CONTRACT ADMINISTRATOR
- 3) EXISTING ASPHALT SURFACE TO BE PLANED WITHIN THE CONSTRUCTION LIMITS AS DIRECTED BY THE CONTRACT ADMINISTRATOR
- 4) PAVEMENT REPAIRS SHOWN ARE ONLY A REPRESENTATIVE SAMPLE OF THE TENDERED QUANTITIES

WARNING

IF POWER EQUIPMENT OR EXPLOSIVES ARE TO BE USED FOR EXCAVATION ON THIS PROJECT THE CONTRACTOR MUST:

- 1) OBTAIN CLEARANCE FROM THE GAS UTILITY PRIOR TO EXCAVATION.
- 2) TAKE PRECAUTION TO AVOID DAMAGE TO GAS UTILITY INSTALLATIONS.

SEE PROVINCIAL REGULATION 210/72 FOR DETAILS

ALL CHAINAGES ARE MEASURED ALONG THE CENTER LINE OF ST. ANNES ROAD

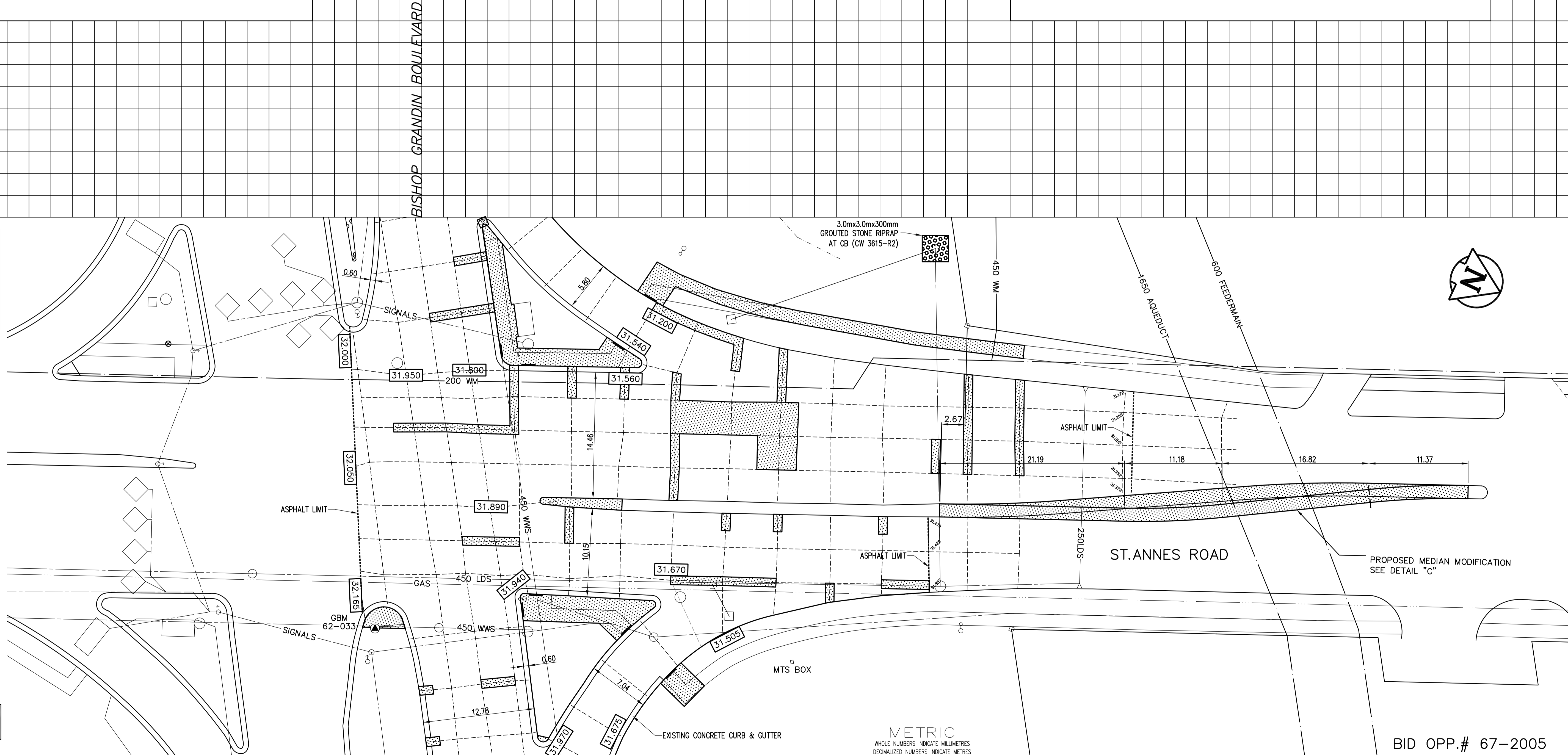

EXISTING	LEGEND - PLAN	PROPOSED	EXISTING	LEGEND - PLAN	PROPOSED	EXISTING	LEGEND - PROFILE	PROPOSED
150 mm WM	WATERMAIN	150 mm WM	HYDRO	SWALE	150 mm WM	WATERMAIN	HYDRANT	
Hydrant Valve		Hydrant Valve	Concrete		Hydrant Valve	Hydrant Valve		
300 mm LDS	LAND DRAINAGE SEWER	300 mm LDS	LIMIT OF ASPHALT		300 mm LDS	SEWER		
250 mm WWS	WASTE WATER SEWER	250 mm WWS	CURB RENEWAL					
Manhole		Manhole	Guard Rail				NORTH GUTTER	
Catch Basin		Catch Basin	Elevations	31.000			Q PROFILE	
Curb Inlet		Curb Inlet	Signal				SOUTH GUTTER	
Wood Poles		Wood Poles	Survey Bar				NORTH Q DITCH	
Lamp Standard		Lamp Standard	North Q Ditch				Ramp Curb	
Gas		Gas	Ramp Curb					

LOCATION APPROVED UNDERGROUND STRUCTURES

DATE COMMITTEE

NOTE: LOCATION OF UNDERGROUND STRUCTURES AS SHOWN ARE BASED ON THE BEST INFORMATION AVAILABLE, BUT NO GUARANTEE IS GIVEN THAT ALL EXISTING UTILITIES ARE SHOWN OR THAT THE GIVEN LOCATIONS ARE EXACT. CONFIRMATION OF EXISTENCE AND EXACT LOCATION OF ALL SERVICES MUST BE OBTAINED FROM THE INDIVIDUAL UTILITIES BEFORE PROCEEDING WITH CONSTRUCTION.

B.M. ELEV. GBM 62-033 232.164m

NO. REVISIONS

DATE

BY

ENGINEERING DIVISION TECHNOLOGY SERVICES BRANCH
106 - 1155 PACIFIC AVE

DESIGNED BY B.K.

CHECKED BY B.K. A.J.P.

DRAWN BY M.R.J.

APPROVED BY L.P.D.

HOR. SCALE: 1 : 250

VERTICAL: 1 : 20

DATE 2005/04/01

ENGINEER'S SEAL

PROVINCE OF MANITOBA

L.P. DEANE

REGISTERED ENGINEER

ORIGINAL SIGNED BY L.P.D. APR 07/05

THE CITY OF WINNIPEG
PUBLIC WORKS DEPARTMENT

BISHOP GRANDIN BOULEVARD (WESTBOUND)

ST. ANNE'S ROAD INTERSECTION
ASPHALT RESURFACING AND MISCELLANEOUS DETAILS

CITY DRAWING NUMBER SE-05-12

SHEET 12 OF 14

BID OPP.# 67-2005

12