

PLAN
SCALE 1:50

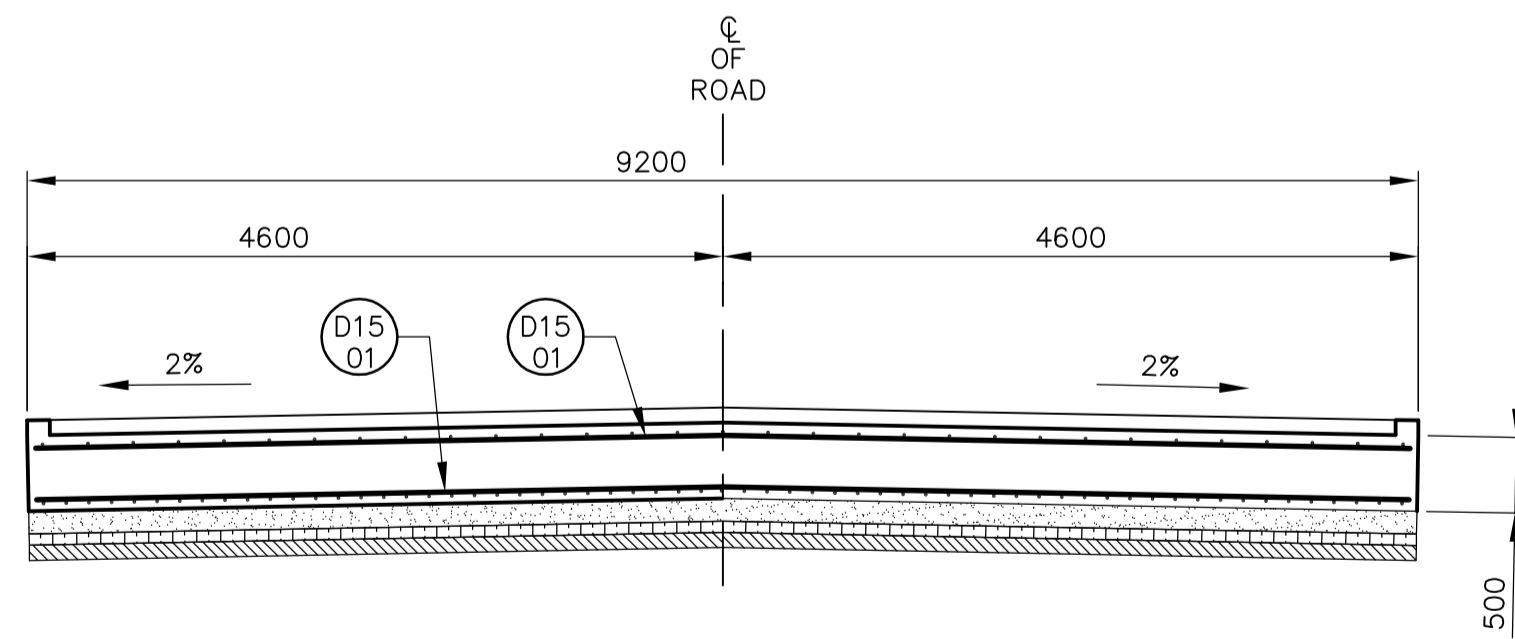

1 SECTION
SCALE 1:50

NOTE:
SEE CURB AND REINFORCEMENT DETAIL
ON SHEET

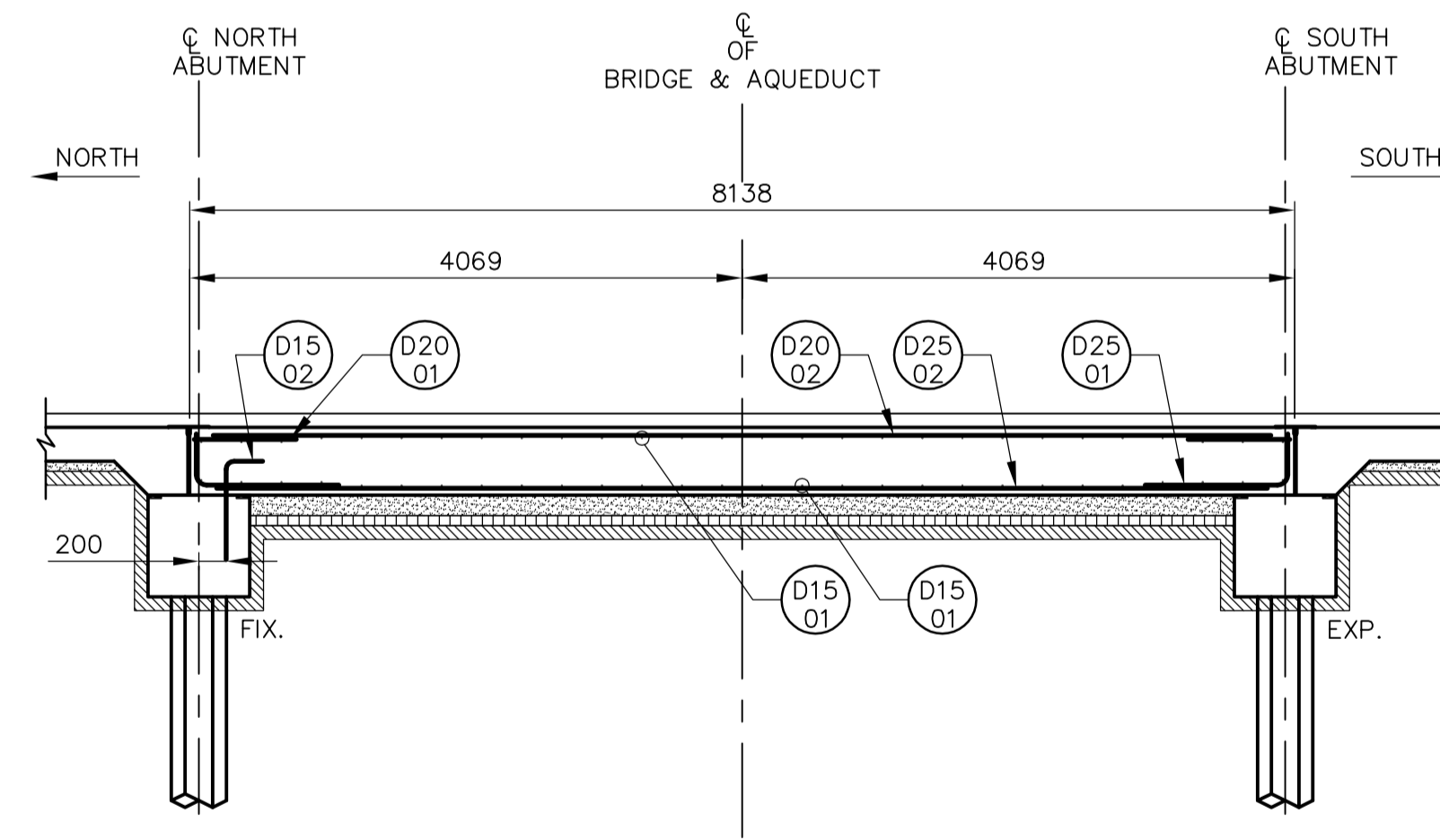

2 SECTION
SCALE 1:50

BILL OF REINFORCING STEEL FOR SLAB								
STRAIGHT BARS				BENT BARS				BENDING DIAGRAM
MK.	No.	LENGTH	MASS	MK.	No.	LENGTH	MASS	
D1501	56	9100	800	D1502	11	1000	17	
D2001	62	750	110	D2501	122	1450	694	
D2002	31	8000	584					
D2502	61	8000	1915					
TOTAL MASS OF REINFORCING STEEL							4120 kg	
TOTAL VOLUME OF STRUCTURAL CONCRETE (BRIDGE SLAB)							37.43 m³	

- NOTES:
1. ALL DIMENSIONS GIVEN ARE OUT TO OUT, EXCEPT RADII ARE INSIDE DIMENSIONS.
 2. ALL REINFORCING STEEL SHALL BE DEFORMED REINFORCING, UNLESS NOTED OTHERWISE IN THE ABOVE BILL OF REINFORCING STEEL.
 3. ALL REINFORCING STEEL SHALL CONFORM TO CAN/CSA G30.16-M92 GRADE 400W UNLESS NOTED OTHERWISE IN THE ABOVE BILL OF REINFORCING STEEL.
 4. LIKE BARS SHALL BE BUNDLED, SECURELY TIED AND IDENTIFIED AS TO MARK AND SITE No. BY APPROPRIATE MEANS. ALL OTHER ITEMS SHALL BE IDENTIFIED IN A SIMILAR FASHION.

<p>Certificate of Authorization Earth Tech Canada Inc. No. 730 Expiry: April 30, 2006</p>	<p>Frederickson Cooper ARCHITECTS</p>	<p>A Tyco International Ltd. Company</p>		<p>THE CITY OF WINNIPEG WATER AND WASTE DEPARTMENT ENGINEERING DIVISION</p>	
				<p>DESIGNED BY: AP CHECKED BY: EBL</p> <p>DRAWN BY: KC APPROVED BY: D.J. TANIGUCHI</p> <p>SCALE: AS NOTED RELEASED FOR CONSTRUCTION BY: R. SOROKOWSKI</p>	
<p>CONSULTANT DRAWING NO. WN-S0472</p>			<p>STRUCTURAL WESTERN BRIDGE DECK SLAB DETAILS</p>		<p>CITY FILE NUMBER</p> <p>SHEET 5 OF 8</p> <p>CITY DRAWING NUMBER</p> <p>1-060N-A-S0472-001-00D</p>