

- NOTES:**
- PARAPET WALLS TO BE PROVIDED IN SEPARATE CONTRACT ALONG ALL EXTERIOR WALLS AND ALONG ALL EXPANSION JOINTS. FOR DOWEL DETAIL SEE **4** WB-S0464
 - DESIGN SNOW LOAD AS NOTED. **4** WB-S0464
 - SUPERIMPOSED DEAD LOAD IS 1.0 kPa. **6** WB-S0464
 - CONNECTIONS BETWEEN TEES TO BE SPACED BY PRECAST SUPPLIER AS PER LOADS. SEE **6** WB-S0464
 - CAST-IN PLACE ANGLE IN UPSTAND BEAM DESIGNED AND SUPPLIED BY PRECAST SUPPLIER, AND INSTALLED BY GENERAL CONTRACTOR. SEE **6** WB-S0464
 - NOTE THAT **5** WB-S0464 MAY BE USED TO SUPPORT LIGHT FIXTURES INSTALLED UNDER SEPARATE CONTRACT. COORDINATE NUMBER AND LOCATION.
 - PROVIDE 20mm ϕ SLEEVES IN ALL DOUBLE TEE STEMS 1200mm C/C.

LEGEND:

NOT IN CONTRACT

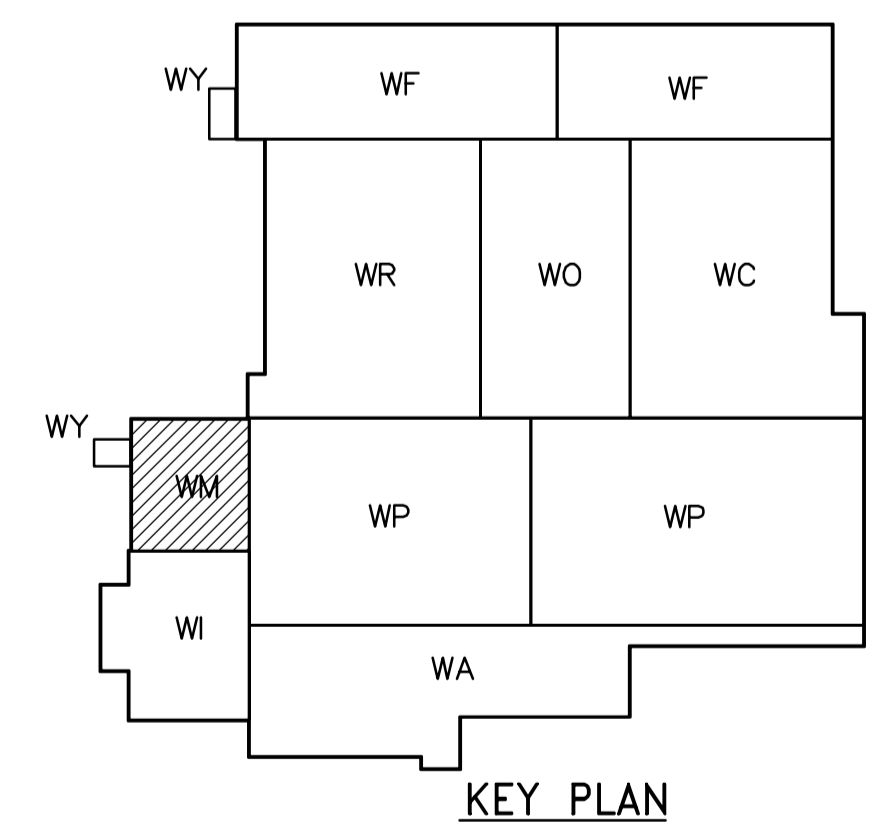

ROOF PLAN
1:100

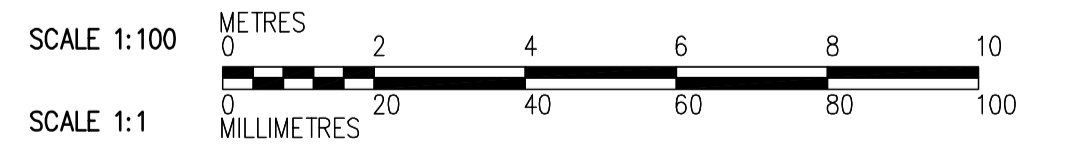

 Certificate of Authorization CH2M HILL Canada Ltd. No. 1441 Expiry: April 30, 2006	B.M. ELEV. <table border="1"> <tr><td> </td><td> </td><td> </td><td> </td></tr> <tr><td> </td><td> </td><td> </td><td> </td></tr> <tr><td> </td><td> </td><td> </td><td> </td></tr> <tr><td> </td><td> </td><td> </td><td> </td></tr> </table>																	 Frederickson Cooper ARCHITECTS	 A Neo International Ltd. Company	ENGINEER'S SEAL ORIGINAL SIGNED BY D. KRUGER 2006/02/06	 THE CITY OF WINNIPEG WATER AND WASTE DEPARTMENT ENGINEERING DIVISION WATER TREATMENT PLANT GENERAL PLANT SERVICES/MISCELLANEOUS FOUNDATIONS AND CONCRETE STRUCTURES STRUCTURAL ELECTRICAL ROOM ROOF PLAN	CITY FILE NUMBER SHEET OF CITY DRAWING NUMBER 1-060M-A-00146-001-00D
DESIGNED BY: DK CHECKED BY: AP DRAWN BY: RL/PM APPROVED BY: DJT SCALE: 1:100 RELEASED FOR CONSTRUCTION BY: R. SOROKOWSKI	CONSULTANT DRAWING NO. WM-S0146																					
00 ISSUED FOR TENDER NO. REVISIONS	2006/02/03 DATE BY	DATE: 2005/09/15	DATE: 2006/02/08	WM-S0146	WM-S0202 WM-S0203 WM-S0204 WM-S0205 WM-S0201	WM-S0456																