

NOTES:

- DESIGN SNOW LOAD AS NOTED.
- SUPER IMPOSED DEAD LOAD IS 1.0 kPa. PROVIDE 20mm DIA SLEEVES IN ALL DOUBLE TEE STEMS 1200mm C/C.
- PROVIDE SLEEVES FOR 25mm DIA THRU BOLTS. TWO SLEEVES PER CONNECTION POINT SEE (3) (SIM.) WF-S0405
- CONNECTORS BETWEEN PRECAST DOUBLE TEES AND CAST-IN PLACE ROOF FRAMING BEAMS TO BE DESIGNED, LOCATED AND SUPPLIED BY PRECAST SUPPLIER. SEE (6) WB-S0464
- CONNECTORS IN CAST-IN PLACE UPSTAND BEAMS TO BE INSTALLED BY GENERAL CONTRACTOR.
- NOTE THAT (5) WB-S0464 MAY BE USED TO SUPPORT LIGHT FIXTURES INSTALLED UNDER SEPARATE CONTRACT. COORDINATE NUMBER AND LOCATION.
- ONLY ROOF (THIS DRAWING) IS PART OF THIS CONTRACT. DRAWINGS NO. WI-S0201 AND WI-S0202 ARE PROVIDED FOR ROOF FRAMING UPSTAND INFORMATION.
- PARAPET WALL WILL BE PROVIDED IN SEPARATE CONTRACT AT ALL EXTERIOR WALLS AND ALONG ALL EXPANSION JOINTS. FOR DOWEL DETAIL SEE (4) WB-S0464

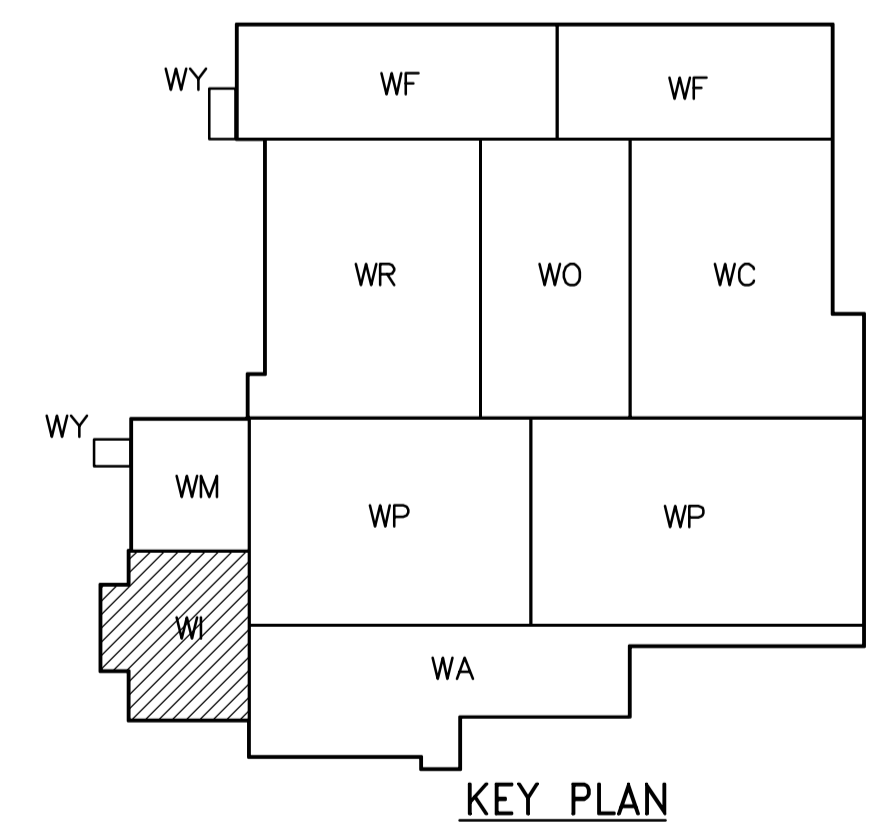

ROOF PLAN
1:100

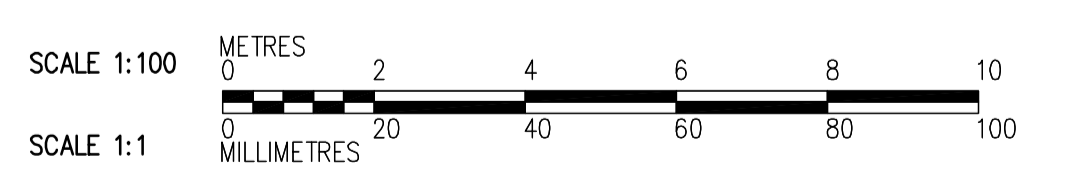

<p>Certificate of Authorization CH2M HILL Canada Ltd. No. 1441 Expiry: April 30, 2006</p>	<p>Frederickson Cooper ARCHITECTS</p>		<p>A Geo International Ltd. Company</p>		ENGINEER'S SEAL ORIGINAL SIGNED BY D. KRUGER 2006/02/06	<p>THE CITY OF WINNIPEG WATER AND WASTE DEPARTMENT ENGINEERING DIVISION</p>	WATER TREATMENT PLANT INLET WORKS & RAW WATER PUMPING FOUNDATIONS AND CONCRETE STRUCTURES	CITY FILE NUMBER SHEET OF
	DESIGNED BY DK CHECKED BY AP		DRAWN BY PM APPROVED BY DJT		CONSULTANT DRAWING NO. WI-S0146		STRUCTURAL RAW WATER PUMP STATION AREA ROOF PLAN	CITY DRAWING NUMBER 1-0601-A-S0146-001-00D
	SCALE: 1:100		RELEASED FOR CONSTRUCTION BY: R. SOROKOWSKI					
	00 ISSUED FOR TENDER 2006/02/03 DK		DATE 2005/07/08 DATE 2006/02/08					