

ROOF PLAN  
1:100

NOTES:

- DESIGN SNOW LOAD = 1.56 kPa
- SUPER IMPOSED DEAD LOAD = 1 kPa
- PARAPET WALLS TO BE PROVIDED IN SEPARATE CONTRACT ALONG ALL EXTERIOR WALLS AND ALONG ALL EXPANSION JOINTS. FOR DOWEL DETAIL SEE 4
- CONNECTIONS BETWEEN TEE BEAM TO BE SPACED BY PRECAST SUPPLIER AS PER LOAD
- CAST-IN-PLACE ANGLE IN UPSTAND BEAM DESIGNED AND SUPPLIED BY PRECAST SUPPLIER, AND INSTALLED BY GENERAL CONTRACTOR
- PROVIDE 20mm  $\phi$  SLEEVES IN ALL DOUBLE TEE STEMS 1200mm C/C.

LIFTING EYE

- TYPE "1" (900 kg)
- TYPE "2" (1800 kg)

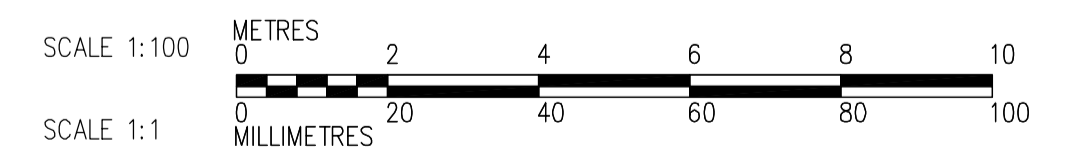
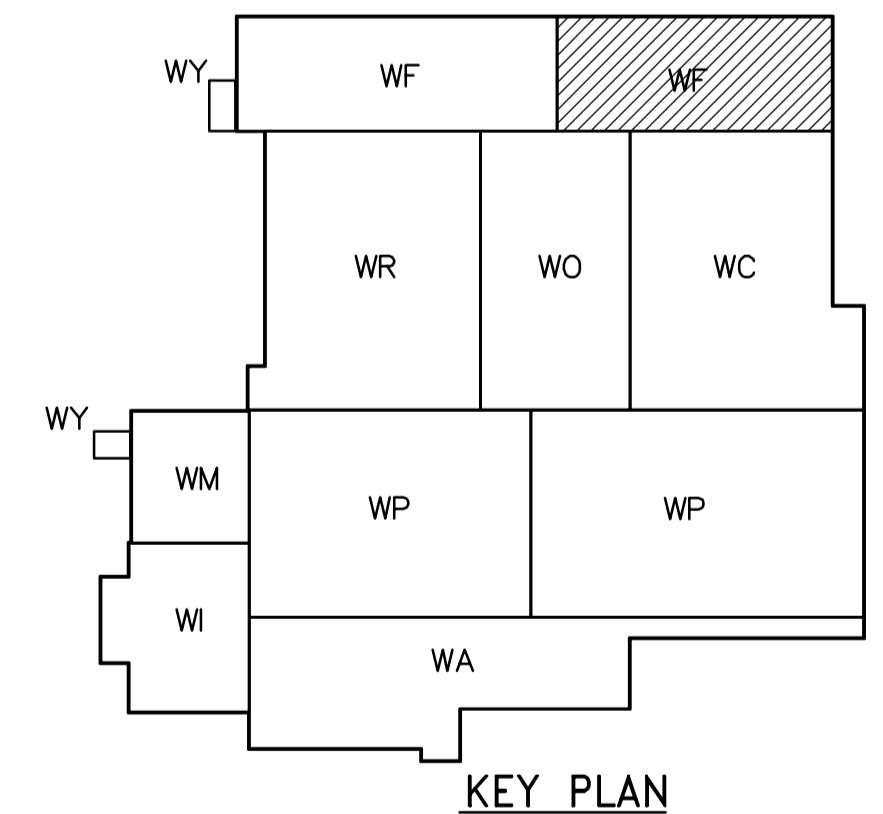

|  |   |                                      |   |  |  |   |
|--|---|--------------------------------------|---|--|--|---|
| <br>Certificate of Authorization<br>CH2M HILL Canada Ltd.<br>No. 1441 Expiry: April 30, 2006 | <br>Frederickson Cooper<br>ARCHITECTS                       | <br>A Geo International Ltd. Company | ENGINEER'S SEAL   | <br>THE CITY OF WINNIPEG<br>WATER AND WASTE DEPARTMENT<br>ENGINEERING DIVISION | WATER TREATMENT PLANT<br>FILTRATION<br>FOUNDATIONS AND CONCRETE STRUCTURES | CITY FILE NUMBER  |
|  |   |                                      | DESIGNED BY DK<br>CHECKED BY AP<br>DRAWN BY PM<br>APPROVED BY DJT<br>SCALE: 1:100<br>RELEASED FOR CONSTRUCTION BY:<br>R. SOROKOWSKI |  |  | ORIGINAL SIGNED BY<br>D. KRUGER<br>2006/02/06<br>CONSULTANT DRAWING NO.<br>WF-S0147 |
| B.M. ELEV.   | 00 ISSUED FOR TENDER 2006/02/03 DK<br>NO. REVISIONS DATE BY | DATE 2005/08/10 DATE 2006/02/08      | STRUCTURAL<br>FILTRATION AREA 2<br>ROOF PLAN  | CITY DRAWING NUMBER<br>1-060F-A-50147-001-00D                                  |  |   |