

- NOTES:**
- DESIGN SNOW LOAD AS NOTED.
  - SUPERIMPOSED DEAD LOAD IS 1.0 kPa.
  - PARAPET WALLS TO BE PROVIDED IN SEPARATE CONTRACT ALONG ALL EXTERIOR WALLS AND ALONG ALL EXPANSION JOINTS. FOR DOWEL DETAIL SEE (4) WB-S0464
  - CONNECTIONS BETWEEN TEES TO BE SPACED BY PRECAST SUPPLIER AS PER LOADS. SEE (6) WB-S0464
  - CAST-IN PLACE ANGLE IN UPSTAND BEAM DESIGNED AND SUPPLIED BY PRECAST SUPPLIER, AND INSTALLED BY GENERAL CONTRACTOR. SEE (6) WB-S0464
  - NOTE THAT (5) WB-S0464 MAY BE USED TO SUPPORT LIGHT FIXTURES INSTALLED UNDER SEPARATE CONTRACT. COORDINATE NUMBER AND LOCATION.
  - PROVIDE 20mm  $\phi$  SLEEVES IN ALL DOUBLE TEE STEMS 1200mm C/C.

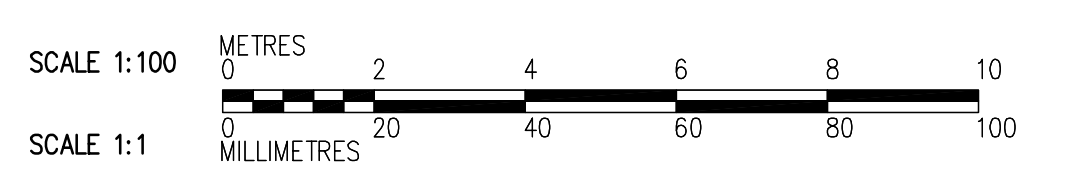
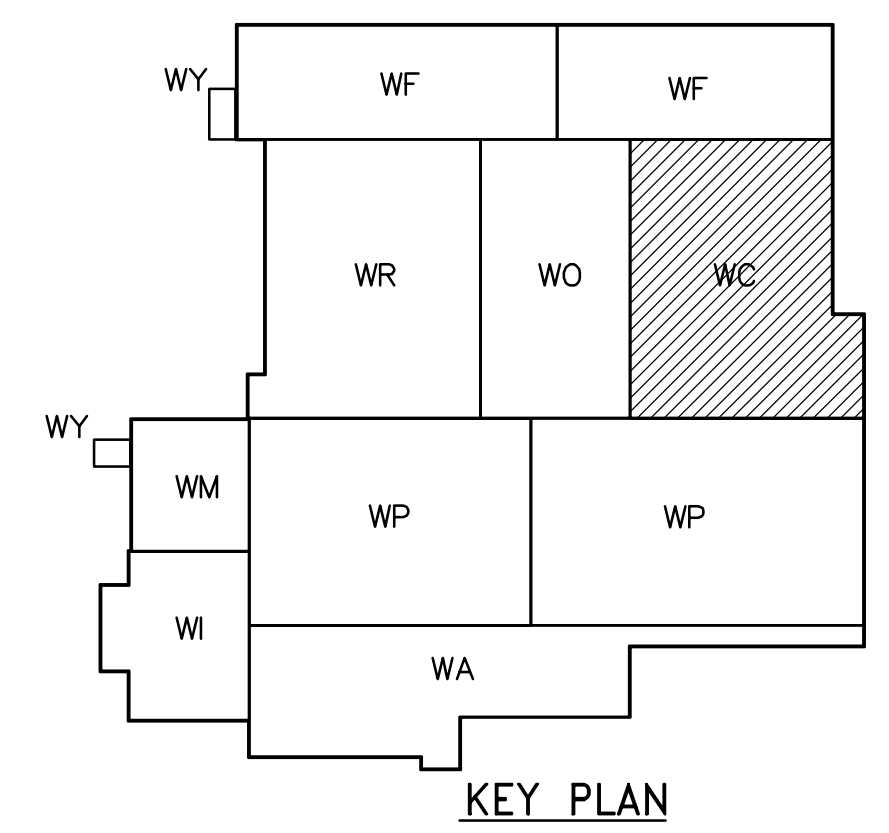

ROOF PLAN  
1:100

 Certificate of Authorization CH2M HILL Canada Ltd. No. 1441 Expiry: April 30, 2006	B.M. ELEV.	 Frederickson Cooper ARCHITECTS	 A Neo International Ltd. Company	ENGINEER'S SEAL	 THE CITY OF WINNIPEG WATER AND WASTE DEPARTMENT ENGINEERING DIVISION WATER TREATMENT PLANT CHEMICAL FEED SYSTEMS FOUNDATIONS AND CONCRETE STRUCTURES STRUCTURAL CHEMICAL AREA ROOF PLAN	CITY FILE NUMBER
	DESIGNED BY DK			CHECKED BY AP		ORIGINAL SIGNED BY D. KRUGER
	DRAWN BY PM	APPROVED BY DJT	2006/02/06	CITY DRAWING NUMBER		
	SCALE: 1:100	RELEASED FOR CONSTRUCTION BY: R. SOROKOWSKI	CONSULTANT DRAWING NO. WC-S0146	1-0601C-A-S0146-001-00D		
00 ISSUED FOR TENDER	2006/02/03 DK	DATE 2005/08/28	DATE 2006/02/08			