

- NOTES:**
- DESIGN LIVE LOAD (SNOW) IS:
 - 4.50 kPa
 - 1.56 kPa
 - SUPERIMPOSED DEAD LOAD IS 1.0 kPa.
 - PARAPET WALLS TO BE PROVIDED IN SEPARATE CONTRACT ALONG ALL EXTERIOR WALLS AND ALONG ALL EXPANSION JOINTS. FOR DOWEL DETAIL SEE 4.
 - CONNECTION BETWEEN TEE BEAM TO BE SPACED BY PRECAST SUPPLIER AS PER LOAD.
 - CAST-IN-PLACE ANGLE IN UPSTAND BEAM DESIGNED AND SUPPLIED BY PRECAST SUPPLIER, AND INSTALLED BY GENERAL CONTRACTOR.
 - PROVIDE 20mm ϕ SLEEVES IN ALL DOUBLE TEE STEMS 1200mm C/C.
 - REFER TO "GENERAL NOTES" ON DRAWING WM-S9002 FOR OPENINGS AND BLOCK-OUTS NOT IDENTIFIED ON THIS DRAWING.

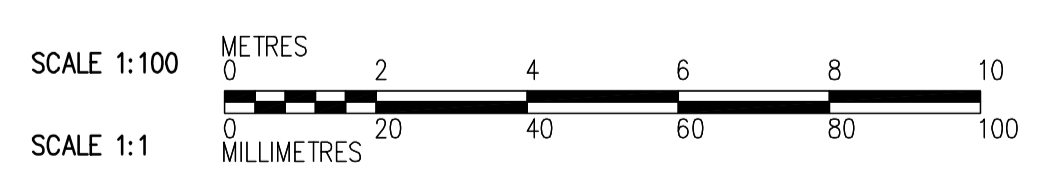
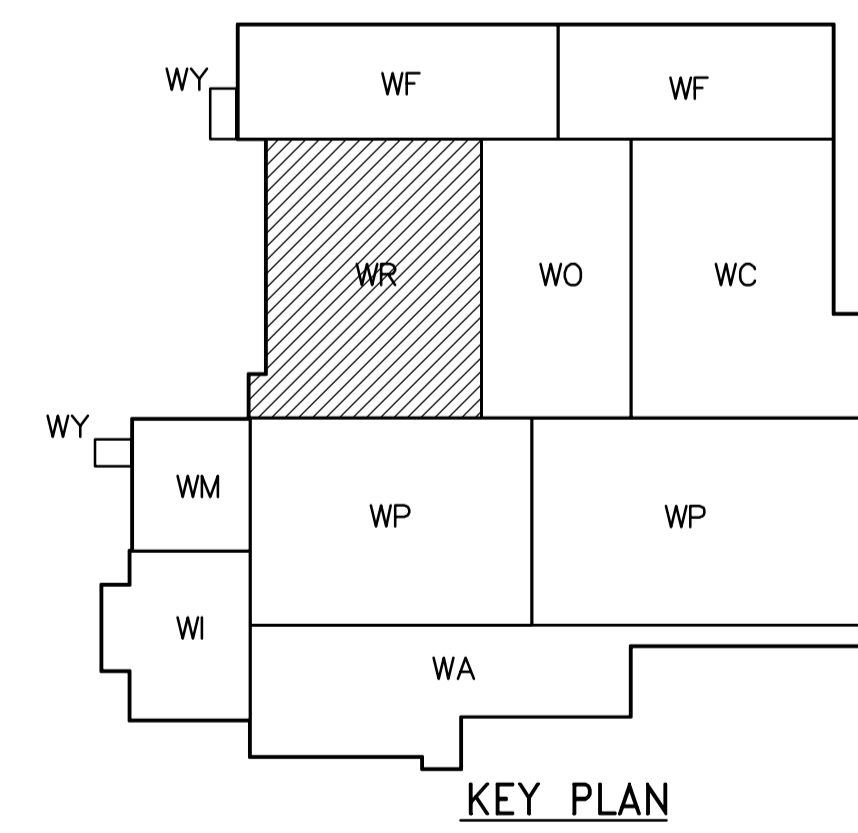

ROOF PLAN
1:100

<p>APEGN Certificate of Authorization CH2M HILL Canada Ltd. No. 1441 Expiry: April 30, 2006</p>	<p>Frederickson Cooper ARCHITECTS</p>		<p>EarthTech A Tyco International Ltd. Company</p>		<p>ENGINEER'S SEAL</p> <p>ORIGINAL SIGNED BY D. KRUGER 2006/02/06</p> <p>CONSULTANT DRAWING NO. WR-S0146</p>	<p>THE CITY OF WINNIPEG WATER AND WASTE DEPARTMENT ENGINEERING DIVISION</p> <p>WATER TREATMENT PLANT RESIDUALS HANDLING FOUNDATIONS AND CONCRETE STRUCTURES</p> <p>STRUCTURAL RESIDUALS HANDLING AREA ROOF PLAN</p>	CITY FILE NUMBER
	DESIGNED BY DK	CHECKED BY AP	SHEET OF				
	DRAWN BY PM	APPROVED BY DJT	CITY DRAWING NUMBER				
	SCALE: 1:100	RELEASED FOR CONSTRUCTION BY: R. SOROKOWSKI	1-060R-A-0046-001-0D				
01 583-2005 ADDENDUM 3 06/03/10 DK	DATE 2005/06/28	DATE 2006/02/08					
00 ISSUED FOR TENDER 2006/02/03 DK							
NO. REVISIONS	DATE	BY	DATE	DATE			