

HOUSE No.	SIZE	JUNCTION LOCATION	PL INV	LOCATION AT PROPERTY LINE	COMMENTS
No. 479	-	92.9 W OF MH AT OSBORNE	-	2.3 WEL	
No. 485	-	3.4 W OF 1ST MH W OF OSBORNE	-	3.4 WEL	
No. 489	-	19.2 W OF 1ST MH W OF OSBORNE	-	8.1 WEL	Wyed service with 491
No. 490	-	92.4 W OF MH AT OSBORNE	-	6.1 WEL	
No. 493	-	SEE #493	-	-	
No. 494	-	28.8 W OF 1ST MH W OF OSBORNE	-	3.2 WEL	
No. 495	-	10.9 W OF 1ST MH W OF OSBORNE	-	-	
No. 496	-	34.4 W OF 1ST MH W OF OSBORNE	-	3.8 WEL	
No. 497	-	18.6 W OF 1ST MH W OF OSBORNE	-	8.1 EML OF 498	Wyed service with 498
No. 498	-	42.1 W OF 1ST MH W OF OSBORNE	-	1.5 WEL	
No. 499	-	SEE #499	-	-	
No. 500	-	49.7 W OF 1ST MH W OF OSBORNE	-	4.6 EML	
No. 502	-	33.8 W OF 1ST MH W OF OSBORNE	-	6.4 EML	
No. 504	-	41.5 W OF 1ST MH W OF OSBORNE	-	8.8 EML OF 504	Wyed service with 504
No. 505	-	SEE #502	-	-	
No. 506	-	64.9 W OF 1ST MH W OF OSBORNE	-	9.4 WEL	Wyed service with 507
No. 507	-	56.7 W OF 1ST MH W OF OSBORNE	-	7.2 EML OF 508	Wyed service with 508
No. 508	-	SEE #505	-	-	
No. 509	-	SEE #506	-	-	
No. 509	-	72.5 W OF 1ST MH W OF OSBORNE	-	2.4 WEL	
No. 510	-	71.9 W OF 1ST MH W OF OSBORNE	-	3.4 WEL	Wyed service with 512
No. 511	-	80.2 W OF 1ST MH W OF OSBORNE	-	3.8 WEL	
No. 512	-	SEE #510	-	-	
No. 513	-	87.8 W OF 1ST MH W OF OSBORNE	-	4.3 EML	
No. 514	-	87.2 W OF 1ST MH W OF OSBORNE	-	3.9 WEL	Wyed service with 516
No. 515	-	95.4 W OF 1ST MH W OF OSBORNE	-	-	
No. 516	-	SEE #514	-	-	

* TO BE DETERMINED IN FIELD IF SERVICES CAN BE SEPARATED

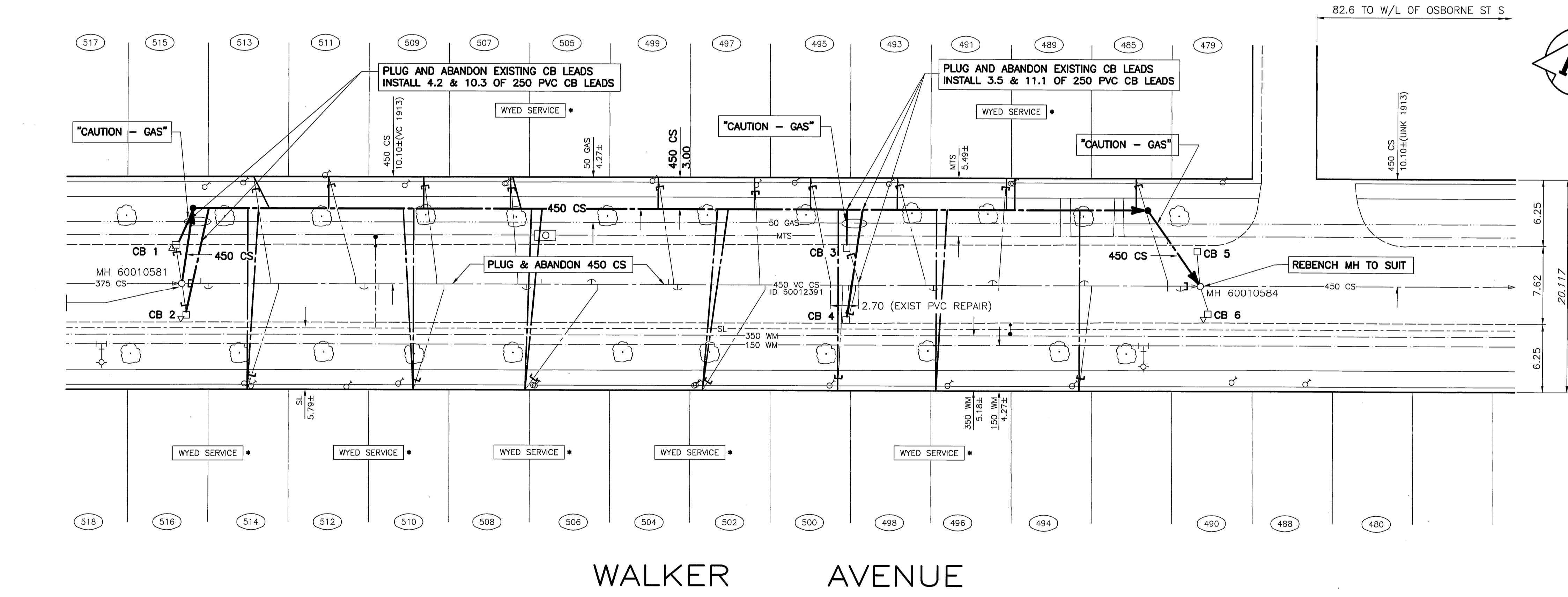

MANHOLE INFORMATION		
MANHOLE NUMBER	MANHOLE TYPE	WORK REQUIRED
60010581	PRECAST	NO REPAIRS REQUIRED
60010584	PRECAST	INSTALL 1 RUNG, GROUT TOP 1m

CATCHBASIN INFORMATION	
CATCHBASIN NUMBER	WORK REQUIRED
CB 1	NO REPAIRS REQUIRED
CB 2	NO REPAIRS REQUIRED
CB 3	NO REPAIRS REQUIRED
CB 3	NO REPAIRS REQUIRED
CB 5	NO REPAIRS REQUIRED
CB 6	INSTALL HOOD

- GENERAL NOTES:**
- CHAINAGE IS ALONG SOUTH PROPERTY LINE OF WALKER AVENUE.
- CONSTRUCTION NOTES:**
- ALL BACKFILL IN BOULEVARDS TO BE CLASS 5.
 - ALL BACKFILL IN PAVEMENT TO BE CLASS 3.
 - INSTALL SEWER USING TRENCHLESS METHODS.
 - INSTALL NEW SEWER SERVICES TO PROPERTY LINE.
 - ALL CATCHBASIN LEADS ARE 250 PVC AT A MINIMUM 1.0% UNLESS OTHERWISE NOTED.
 - CONFIRM LOCATION OF ALL SEWER SERVICES WITHIN RENEWAL LIMITS.



EXISTING	LEGEND-PLAN	PROPOSED	EXISTING	LEGEND-PLAN	PROPOSED	EXISTING	LEGEND-PLAN	PROPOSED
150 WM	WATERMAIN	150 WM	BEND			ANCHOR		
400 FM	FEEDERMAIN	400 FM	TEE			TREE		
300 LDS	LAND DRAINAGE SEWER	300 LDS	CURB STOP			LEGAL DIMENSION		
250 WWS	WASTEWATER SEWER	250 WWS	PLUG			SURVEY BAR		
300 CS	COMBINED SEWER	300 CS	MANHOLE			TRAFFIC SIGNAL		
200 FCM	FORCEMAIN	200 FCM	CATCHBASIN			GAS		
	JUNCTIONS		CURB INLET			HYDRO		
	HYDRANT		ADDRESS			MTS		
	VALVE		HYDRO POLE			SIDEWALK		
	REDUCER		LIGHT STANDARD			CURB		

LOCATION APPROVED UNDERGROUND STRUCTURES

SUPV. U/G STRUCTURES DATE COMMITTEE

NOTE: LOCATION OF UNDERGROUND STRUCTURES AS SHOWN ARE BASED ON THE BEST INFORMATION AVAILABLE. BUT NO GUARANTEE IS GIVEN THAT ALL EXISTING UTILITIES ARE SHOWN OR THAT THE GIVEN LOCATIONS ARE EXACT. CONFIRMATION OF EXISTENCE AND EXACT LOCATION OF ALL SERVICES MUST BE OBTAINED FROM THE INDIVIDUAL UTILITIES BEFORE PROCEEDING WITH CONSTRUCTION.

NO.	REVISIONS	DATE	BY
-	ISSUED FOR TENDER	05.10.27	LC
-	REVISED AS PER CITY COMMENTS	05.09.30	GS
-	ISSUED FOR APPROVAL	05.08.18	GS

WARDROP Engineering Inc.

DESIGNED BY: GWC
DRAWN BY: GMD

CHECKED BY: [Signature]
APPROVED BY: [Signature]

RELEASED FOR CONSTRUCTION: [Signature]

DATE: 05.07.11



THE CITY OF WINNIPEG WATER AND WASTE DEPARTMENT

2005 COMBINED SEWER RENEWALS AND SEWER REPAIRS - CONTRACT No. 16

WALKER AVENUE
1st MANHOLE EAST OF NASSAU ST S TO
2nd MANHOLE EAST OF NASSAU ST S

CITY DRAWING NUMBER: 05639
SHEET 7 OF 11
CONSULTANT DRAWING NO.: 0500120500-DWG-C5007