

D SIZE 22" x 34" (559mm x 864mm)

PLOT: 05/08/22 4:32:44 PM

UMA FILE NAME: D265-195-01_00-C-0017_RX.dwg Saved By: lberard

EXISTING FEATURES
233.0
232.0
231.0
230.0
229.0
228.0
227.0
226.0
225.0
224.0
CHAINAGE ALONG S.P.

233.0
232.0
231.0
230.0
229.0
228.0
227.0
226.0
225.0
224.0

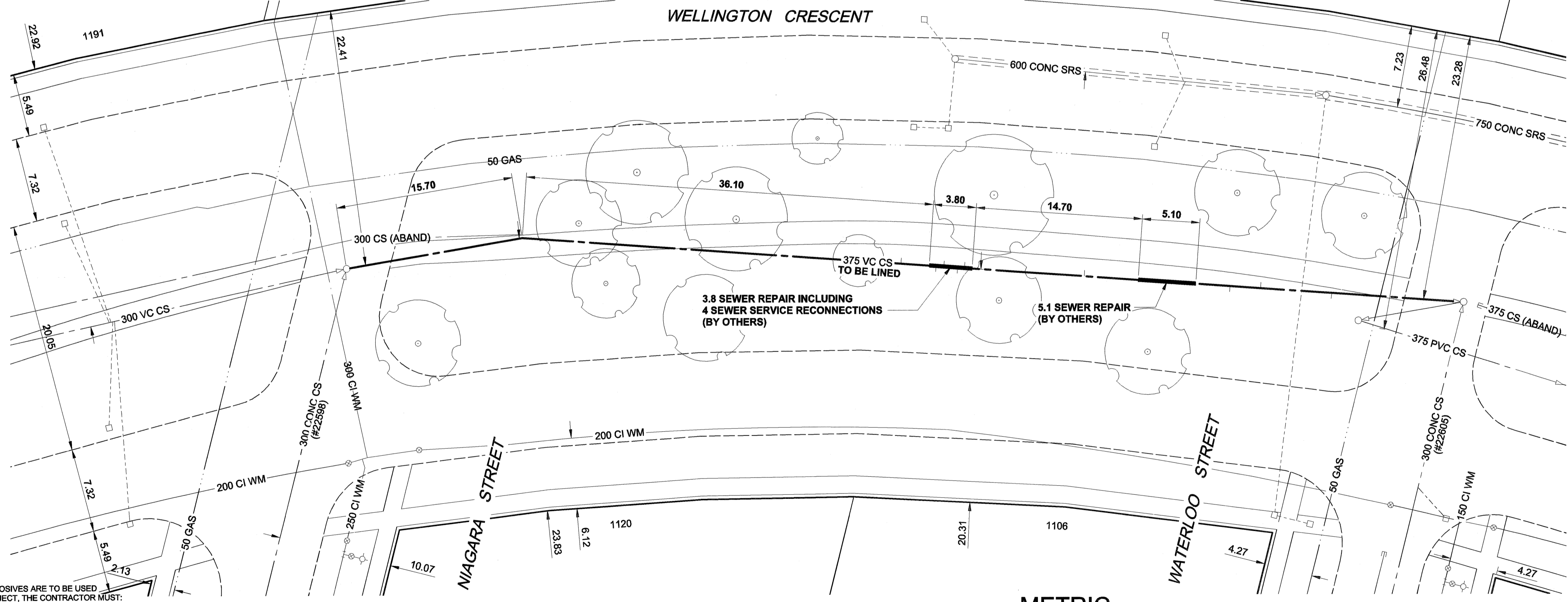
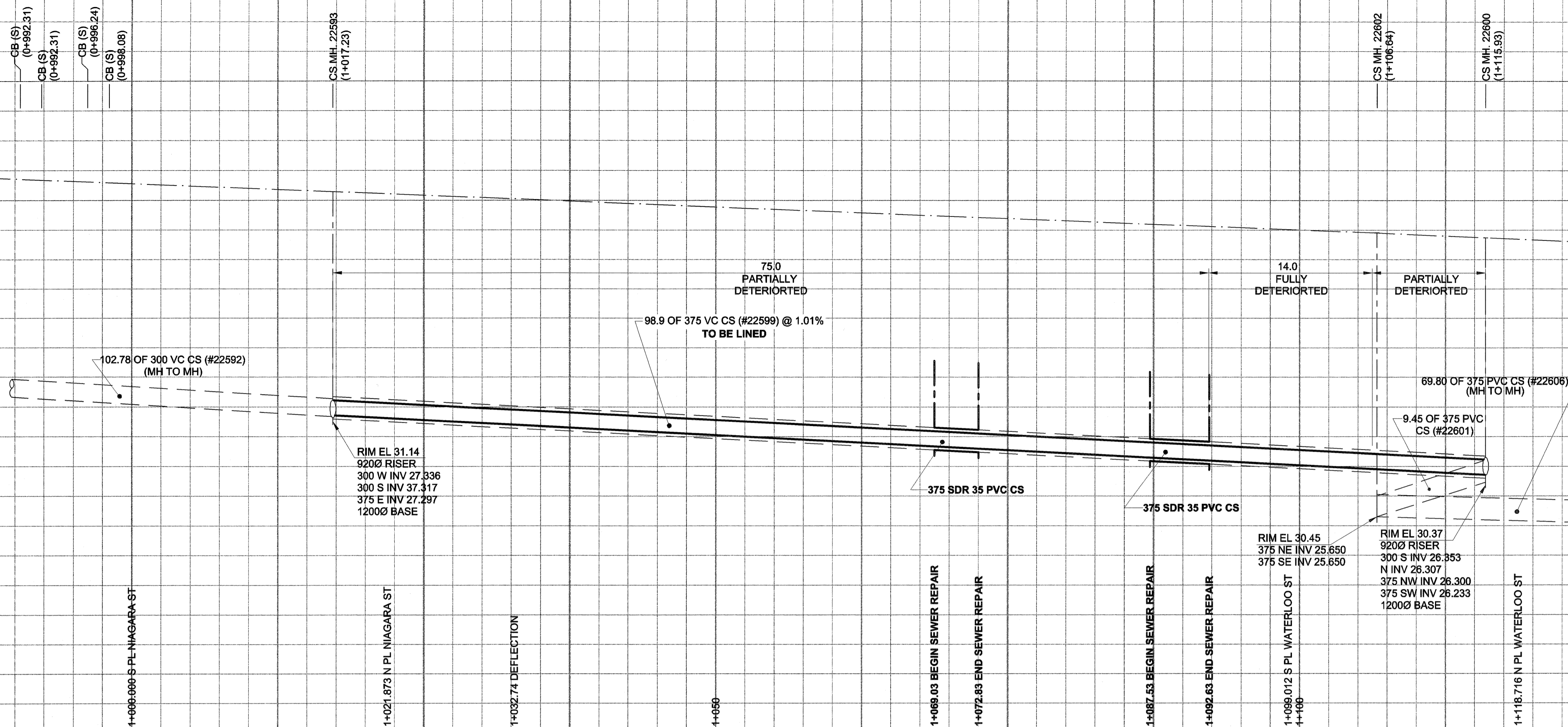

SEWER JUNCTION INFORMATION*

REF. MH	DIST FROM REF. MH	SIZE	CLOCK AT
22593	49.00	1500	10
22593	52.10	1500	02
22593	52.80	1500	10
22593	54.00	1500	02
22593	54.60	1500	10
22593	65.20	1500	10
22593	78.10	1500	02
22600	11.70	1500	10
22600	18.00	1500	02

*JUNCTION LOCATION FROM VIDEO INSPECTION

WARNING
IF POWER EQUIPMENT OR EXPLOSIVES ARE TO BE USED FOR EXCAVATION ON THIS PROJECT, THE CONTRACTOR MUST:
1) NOTIFY THE GAS COMPANY OF THE PROPOSED LOCATION OF EXCAVATION.
2) TAKE PRECAUTION TO AVOID DAMAGE TO GAS COMPANY INSTALLATIONS.
SEE PROVINCIAL REGULATION 140/92 FOR DETAILS

EXISTING	LEGEND - PLAN	NEW	EXISTING	LEGEND - PROFILE	NEW
150 mm WM	WATERMAIN	150 mm WM	150 mm WM	WATERMAIN	150 mm WM
300 mm LDS	LAND DRAINAGE SEWER	300 mm LDS	300 mm LDS	LAND DRAINAGE SEWER	300 mm LDS
250 mm WWS	WASTE WATER SEWER	250 mm WWS	250 mm WWS	WASTE WATER SEWER	250 mm WWS
○	MANHOLE	●	○	MANHOLE	●
□	CATCH BASIN	■	□	CATCH BASIN	■
△	CURB INLET	▲	△	CURB INLET	▲
▭	CULVERT	▭	▭	CULVERT	▭
—	PIPE ABANDONMENTS	—	—	PIPE ABANDONMENTS	—
+	SURVEY BARS	+	+	SURVEY BARS	+

LOCATION APPROVED
UNDERGROUND STRUCTURES
SUPR. U/G STRUCTURES DATE COMMITTEE
NOTE: LOCATION OF UNDERGROUND STRUCTURES AS SHOWN ARE BASED ON THE BEST INFORMATION AVAILABLE. BUT NO GUARANTEE IS GIVEN THAT ALL EXISTING UTILITIES ARE SHOWN OR THAT THE GIVEN LOCATIONS ARE EXACT. CONFIRMATION OF EXISTENCE AND EXACT LOCATION OF ALL SERVICES MUST BE OBTAINED FROM THE INDIVIDUAL UTILITIES BEFORE PROCEEDING WITH CONSTRUCTION.

METRIC
WHOLE NUMBERS INDICATE MILLIMETRES
DECIMALIZED NUMBERS INDICATE METRES

BM 51-049
ELEV 233.099m
N. side Wellington Cres. & Queenston St.
Brass plug in 10.8 m Conc. pile, 4.1 m E. of W.L. of Queenston St. produced from the S. n. 2.3 S. of the N.L. of Wellington Cres.

UMA | AECOM

© 2005 UMA ENGINEERING LTD. ALL RIGHTS RESERVED.

DESIGNED BY: ALD / MJR
CHECKED BY: [Signature]
DRAWN BY: KMB
APPROVED BY: [Signature]
HOR. SCALE: 1:250
VERT. SCALE: 1:50
DATE: 05/08/22

PROFESSIONAL'S SEAL
C.C. MACEY
REGISTERED ENGINEER
CONSULTANT DRAWING NO. 15
D265-195-01

THE CITY OF WINNIPEG
WATER AND WASTE DEPARTMENT

2005 COMBINED SEWER RENEWALS BY CIPP LINING

WELLINGTON CRESCENT
MH AT NIAGARA STREET TO MH AT WATERLOO STREET

SHEET 15 OF 15
CITY DRAWING NUMBER
05630
REV 0

BID OPPORTUNITY NO. 498-2005