

EXISTING FEATURES  
 236.0  
 235.0  
 234.0  
 233.0  
 232.0  
 231.0  
 230.0  
 229.0  
 228.0  
 227.0  
 CHAINAGE  
 ALONG E.P.

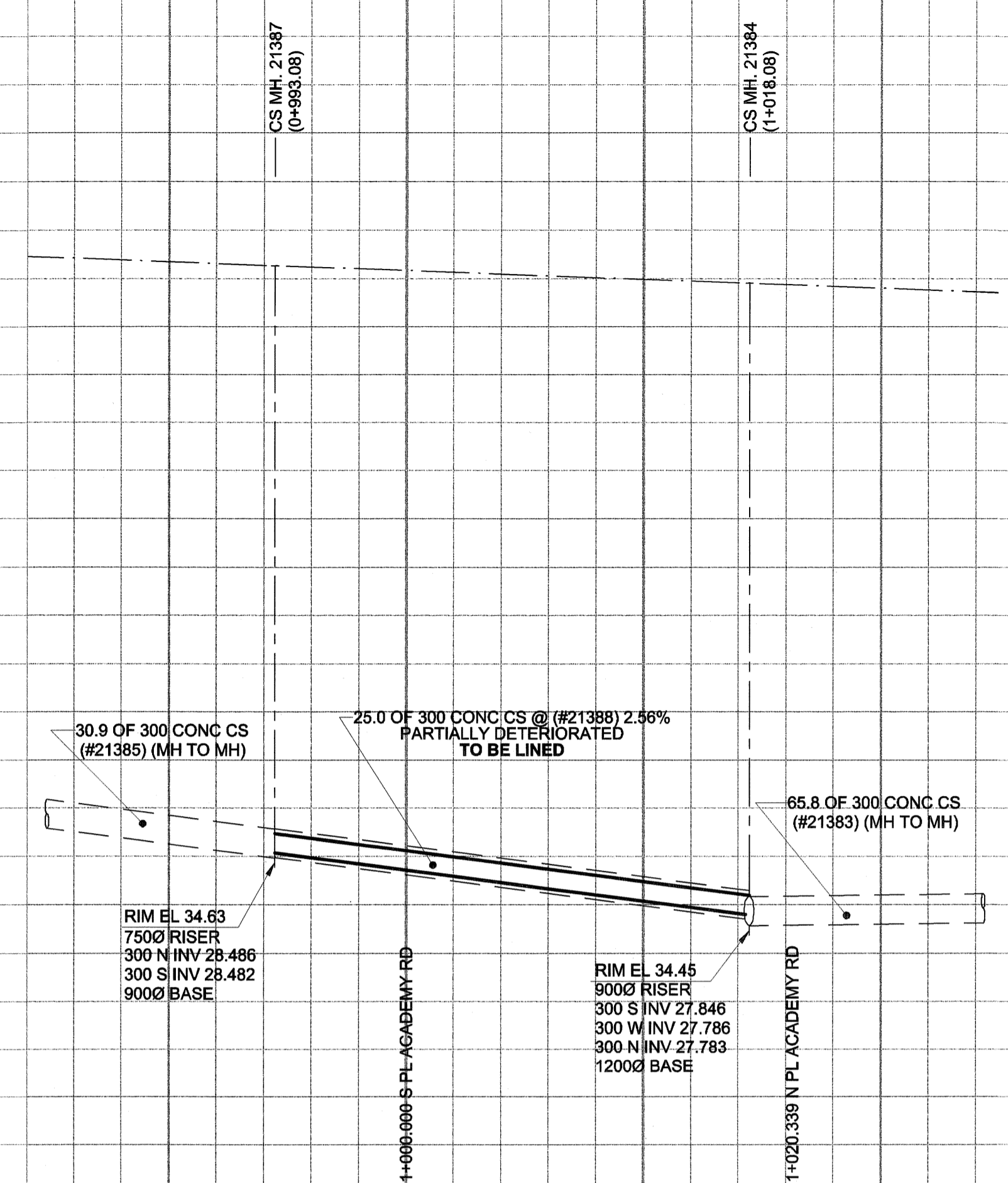

236.0  
 235.0  
 234.0  
 233.0  
 232.0  
 231.0  
 230.0  
 229.0  
 228.0  
 227.0

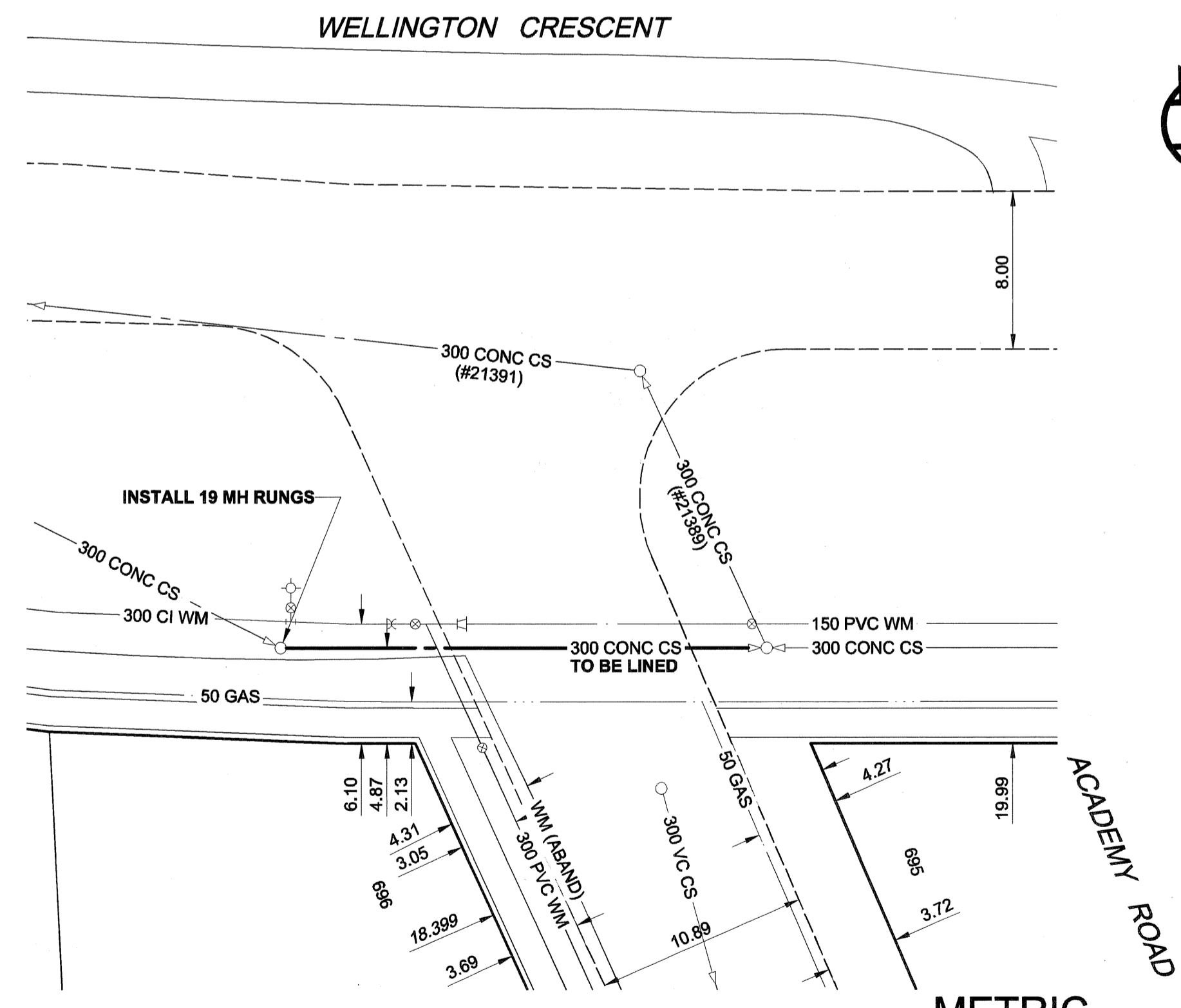

**WARNING**  
 IF POWER EQUIPMENT OR EXPLOSIVES ARE TO BE USED FOR EXCAVATION ON THIS PROJECT, THE CONTRACTOR MUST:  
 1) NOTIFY THE GAS COMPANY OF THE PROPOSED LOCATION OF EXCAVATION.  
 2) TAKE PRECAUTION TO AVOID DAMAGE TO GAS COMPANY INSTALLATIONS.  
 SEE PROVINCIAL REGULATION 140/92 FOR DETAILS

150 mm WM	WATERMAIN	150 mm WM	EXISTING	CURB STOP	NEW	150 mm WM	WATERMAIN	150 mm WM	EXISTING	150 mm WM	WATERMAIN	150 mm WM	EXISTING	150 mm WM	WATERMAIN	150 mm WM	EXISTING	150 mm WM	WATERMAIN	150 mm WM
	HYDRANT			REDUCER			HYDRANT				HYDRANT				HYDRANT					
	VALVE			COUPLING			VALVE				VALVE				VALVE					
	LAND DRAINAGE SEWER			ANODE			LAND DRAINAGE SEWER				LAND DRAINAGE SEWER				LAND DRAINAGE SEWER					
	WASTE WATER SEWER			HYDRO			WASTE WATER SEWER				WASTE WATER SEWER				WASTE WATER SEWER					
	MANHOLE			MTS			MANHOLE				MANHOLE				MANHOLE					
	CATCH BASIN			GAS			CATCH BASIN				CATCH BASIN				CATCH BASIN					
	CURB INLET			TESTHOLE			CURB INLET				CURB INLET				CURB INLET					
	CULVERT			LAMP STANDARD			CULVERT				CULVERT				CULVERT					
	PIPE ABANDONMENTS			TREE			PIPE ABANDONMENTS				PIPE ABANDONMENTS				PIPE ABANDONMENTS					
	SURVEY BAR						SURVEY BAR				SURVEY BAR				SURVEY BAR					
	EXISTING		NEW	EXISTING	NEW		EXISTING		NEW		EXISTING		NEW		EXISTING		NEW			

**LOCATION APPROVED**  
 UNDERGROUND STRUCTURES  
 SUPR. U/G STRUCTURES DATE COMMITTEE  
 NOTE: LOCATION OF UNDERGROUND STRUCTURES AS SHOWN ARE BASED ON THE BEST INFORMATION AVAILABLE. BUT NO GUARANTEE IS GIVEN THAT ALL EXISTING UTILITIES ARE SHOWN OR THAT THE GIVEN LOCATIONS ARE EXACT. CONFIRMATION OF EXISTENCE AND EXACT LOCATION OF ALL SERVICES MUST BE OBTAINED FROM THE INDIVIDUAL UTILITIES BEFORE PROCEEDING WITH CONSTRUCTION.

BM 51-045	S.W. Cor. Academy Rd. & Lockwood St.		
ELEV 233.853m	Brass plug in 4.0 m Conc. pile, 0.7 m S. of S.L. Academy Rd. & 7.5 m W. of C.L. Lockwood St.		
0	ISSUED FOR CONSTRUCTION	05/08/22	KMB
NO.	REVISIONS	YYMMDD	BY

UMA   AECOM		© 2005 UMA ENGINEERING LTD. ALL RIGHTS RESERVED.	
DESIGNED BY	ALD / MJR	CHECKED BY	
DRAWN BY	KMB	APPROVED BY	
HOR. SCALE	1:250	RELEASED FOR CONSTRUCTION	
VERT. SCALE	1:50	DATE	10 Aug 25 105

**APGM**  
 Certificate of Authorization  
 UMA Engineering Ltd.  
 No. 256 Expiry: April 30, 2006

PROFESSIONAL'S SEAL  
 PROVINCE OF MANITOBA  
 C.C. MACEY  
 REGISTERED ENGINEER  
 CONSULTANT DRAWING NO. 13  
 D265-195-01

**THE CITY OF WINNIPEG**  
 WATER AND WASTE DEPARTMENT  
 2005 COMBINED SEWER RENEWALS  
 BY CIPP LINING  
 WELLINGTON CRESCENT  
 1ST MH S OF ACADEMY ROAD  
 TO MH AT N PL ACADEMY ROAD

SHEET 13 OF 15  
 CITY DRAWING NUMBER  
**05628** REV 0

BID OPPORTUNITY NO. 498-2005