

**LIST OF DRAWINGS**

- |     |  |     |   |
|-----|--|-----|---|
| L01 | DEMOLITION PLAN (WESTMINSTER AT LIPTON ST.)            | L15 | BANNER/BIRDHOUSE LAYOUT PLAN                                |
| L02 | DEMOLITION PLAN (WESTMINSTER AT RUBY ST.)              | L16 | SITE FURNISHING PLAN (WESTMINSTER AT LIPTON ST.)            |
| L03 | DEMOLITION PLAN (WOLSELEY AT RUBY ST.)                 | L17 | SITE FURNISHING PLAN (WESTMINSTER AT RUBY ST.)              |
| L04 | DEMOLITION PLAN (WESTMINSTER AT EVANSON ST.)           | L18 | SITE FURNISHING PLAN (WOLSELEY AT RUBY ST.)                 |
| L05 | DEMOLITION PLAN (WESTMINSTER AT EVANSON/ARLINGTON ST.) | L19 | SITE FURNISHING PLAN (WESTMINSTER AT EVANSON ST.)           |
| L06 | DEMOLITION PLAN (WESTMINSTER AT HOME ST.)              | L20 | SITE FURNISHING PLAN (WESTMINSTER AT EVANSON/ARLINGTON ST.) |
| L07 | DEMOLITION PLAN (WESTMINSTER AT CHESTNUT ST.)          | L21 | SITE FURNISHING PLAN (WESTMINSTER AT HOME ST.)              |
|     |  | L22 | SITE FURNISHING PLAN (WESTMINSTER AT CHESTNUT ST.)          |
| L08 | LAYOUT PLAN (WESTMINSTER AT LIPTON ST.)                | L23 | DETAILS   |
| L09 | LAYOUT PLAN (WESTMINSTER AT RUBY ST.)                  | L24 | DETAILS   |
| L10 | LAYOUT PLAN (WOLSELEY AT RUBY ST.)                     | L25 | SITE FURNISHING DETAILS                                     |
| L11 | LAYOUT PLAN (WESTMINSTER AT EVANSON ST.)               | L26 | PLANTING DETAILS AND SPECIFICATION LIST                     |
| L12 | LAYOUT PLAN (WESTMINSTER AT EVANSON/ARLINGTON ST.)     | L27 | PERENNIAL PLANTING LAYOUT                                   |
| L13 | LAYOUT PLAN (WESTMINSTER AT HOME ST.)                  | L28 | DETAILS FOR PRIVATE SPACES                                  |
| L14 | LAYOUT PLAN (WESTMINSTER AT CHESTNUT ST.)              |     |   |

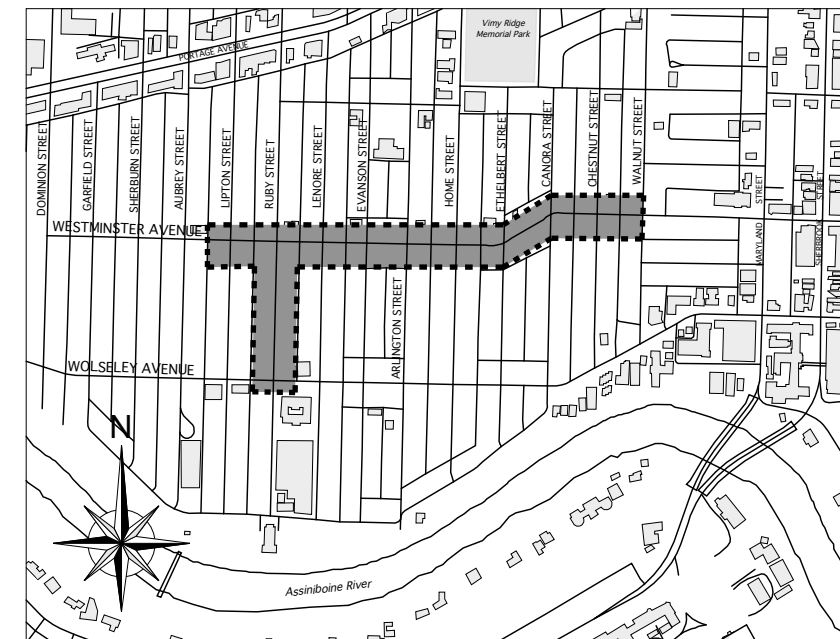

SCALE: 1:10 000

**LOCATION PLAN**



The City of Winnipeg  
Public Works Department  
Bid Opportunity No. 452-2005

# WESTMINSTER AVENUE / WOLSELEY AVENUE STREETSCAPE IMPROVEMENTS

