

SEWER SERVICE INFORMATION				
ADDRESS	SIZE	R. DIST	JUNCTION TIE	
89 EATON ST	-	3.66	SNPL	
RESIDENTIAL	-	9.75 S OF 1st MH S HERBERT AV		
92 EATON ST	-	-	-	
RESIDENTIAL	-	2.44 S 1st MH S HERBERT AV		
95 EATON ST	-	4.57	SNPL	
RESIDENTIAL	-	NO INFORMATION AVAILABLE		
96 EATON ST	-	2.90	SNPL	
RESIDENTIAL	-	53.34 S MH @ HERBERT AV		
97 EATON ST	-	1.52	SNPL	
RESIDENTIAL	-	45.42 S MH @ HERBERT AV		
98 EATON ST	-	6.40	NSPL	
RESIDENTIAL	-	44.81 S MH @ HERBERT AV		
99 EATON ST	-	5.49	NSPL	
RESIDENTIAL	-	37.80 S MH @ HERBERT AV		
103 EATON ST	-	1.98	SNPL	
RESIDENTIAL	-	30.48 S MH @ HERBERT AV		
104 EATON ST	-	2.44	SNPL	
RESIDENTIAL	-	28.57 S MH @ HERBERT AV		
105 EATON ST	-	1.37	SNPL	
RESIDENTIAL	-	22.56 S MH @ HERBERT AV		
106 EATON ST	-	0.91	SNPL	
RESIDENTIAL	-	21.95 S MH @ HERBERT AV		
107 EATON ST	-	0.61	SNPL	
RESIDENTIAL	-	15.54 S MH @ HERBERT AV		
108 EATON ST	-	6.71	NSPL 108 EATON ST	
RESIDENTIAL	-	14.94 S MH @ HERBERT AV		
110 EATON ST	-	WYED SERV W/ 108 EATON ST		
RESIDENTIAL	-	SEE 108 EATON ST		
581 HERBERT AV	-	-	NO INFORMATION AVAILABLE	
RESIDENTIAL	-	-	NO INFORMATION AVAILABLE	
587-A HERBERT AV	-	-	-	
RESIDENTIAL	-	-	NO INFORMATION AVAILABLE	
587-B HERBERT AV	-	-	-	
RESIDENTIAL	-	-	NO INFORMATION AVAILABLE	

NOTE: CHAINAGES SHOWN ARE ALONG Q OF EATON ST.

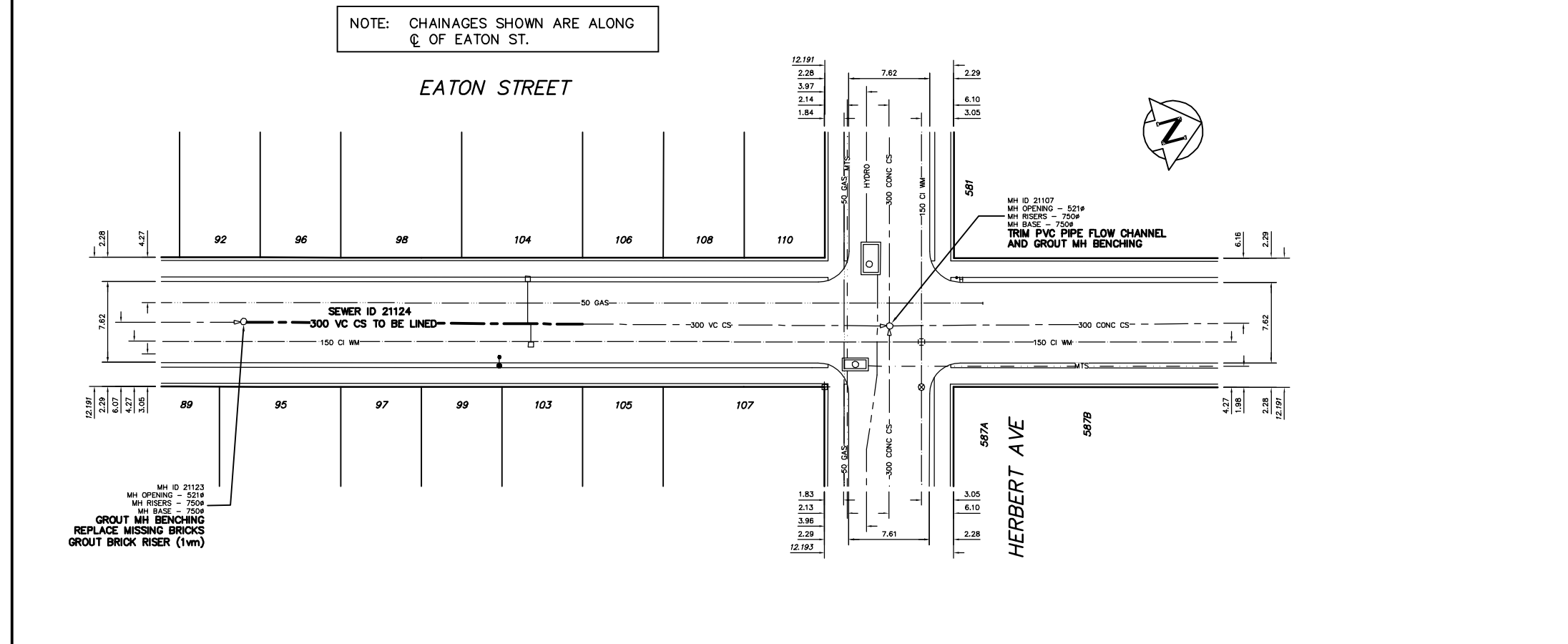

SEWER JUNCTION INFORMATION * SEWER ID 21124			
DISTANCE FROM MH ID 21123			
7.00	N	150ø	2 JN
7.70	N	150ø	11 JN
15.40	N	150ø	2 JX
16.20	N	150ø	10 JN
23.30	N	150ø	2 JN
29.00	N	150ø	2 JN
30.00	N	150ø	10 JN
30.70	N	200ø	2 JX
31.40	N	150ø	10 JN
38.00	N	150ø	2 JN
39.20	N	150ø	10 JN
45.30	N	150ø	2 JN
46.40	N	150ø	10 JN
56.10	N	150ø	2 JN
58.40	N	150ø	2 JN
-	N	150ø	-

* INFORMATION FROM SEWER VIDEO INSPECTION

METRIC
WHOLE NUMBERS INDICATE MILLIMETRES
DECIMALIZED NUMBERS INDICATE METRES

WARNING
IF POWER EQUIPMENT OR EXPLOSIVES ARE TO BE USED FOR EXCAVATION ON THIS PROJECT THE CONTRACTOR MUST:
1) NOTIFY THE GAS COMPANY OF THE PROPOSED LOCATION OF EXCAVATION
2) TAKE PRECAUTION TO AVEOID DAMAGE TO GAS COMPANY INSTALLATIONS.
SEE PROVINCIAL REGULATION 210/72 FOR DETAILS

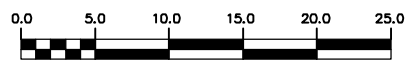

200 WM	WATERMAIN	200 WM	SL, HYDRO	150 WM	WATERMAIN	150 WM
⊕	HYDRANT	⊕	MTS	⊕	HYDRANT	⊕
⊙	VALVE	⊙	TRAFFIC SIGNALS	⊙	VALVE	⊙
525 LDS	LAND DRAINAGE SEWER	525 LDS	GAS	50 GAS	300 LDS	LAND DRAINAGE SEWER
375 WWS	WASTEWATER SEWER	375 WWS	SURVEY BAR	250 WWS	WASTEWATER SEWER	250 WWS
○	MANHOLE	○	FENCE	⊗	PROFILE	⊗
□	CATCH BASIN	□	POLE - HYDRO, MTS	⊖	GROUND ABOVE PIPE	⊖
▽	CURB INLET	▽	CURB STOP	⊠	⊖ DITCH (NORTH & WEST)	⊠
⊖	JUNCTIONS	⊖	GUY ANCHOR	⊖	⊖ DITCH (SOUTH & EAST)	⊖
⊖	CULVERT	⊖	LIGHT STANDARD	⊖	⊖ GUTTER (NORTH & WEST)	⊖
⊖	ANODE	⊖	TREE	⊖	⊖ GUTTER (SOUTH & EAST)	⊖
EXISTING	LEGEND-PLAN	PROPOSED	EXISTING	LEGEND-PLAN	PROPOSED	EXISTING
EXISTING	LEGEND-PROFILE	PROPOSED	EXISTING	LEGEND-PROFILE	PROPOSED	EXISTING

LOCATION APPROVED UNDERGROUND STRUCTURES		B.M. ELEV.	FIELD BOOK #
SUPV. U/G STRUCTURES COMMITTEE	DATE		
NO. REVISIONS	DATE	BY	

CITY OF WINNIPEG
WATER AND WASTE
ENGINEERING DIVISION

DESIGNED BY: TW
CHECKED BY: KZ
DRAWN BY: C.JH/BAW
APPROVED BY: KZ
HOR. SCALE: 1:250
VERTICAL: 1:50
DATE: 2005 06 29

ENGINEER'S SEAL
ORIGINAL SIGNED BY K.R. ZUREK
05/06/30

THE CITY OF WINNIPEG
WATER AND WASTE DEPARTMENT

2005 COMBINED SEWER RENEWALS
BY CIPP LINING
EATON STREET
MH AT HERBERT AVENUE TO
1st MH SOUTH OF HERBERT AVENUE

SHEET 2 OF 7
CITY DRAWING NUMBER
05584

BID OPPORTUNITY: 385-2005
FILENAME: 05584_Eaton.dwg
PLOT DATE: 2005 06 29