

ADDRESS AND SERVICE	SIZE (mm) & TYPE (STREET)	STOP COCK SHORT & LONG MEASUREMENT (m)	CORPORATION LOCATION
419 ST. ANNES ROAD RESIDENTIAL	19 COPPER	N/A	N/A
425 ST. ANNES ROAD RESIDENTIAL	19 COPPER	2.50 RLHL 4.43 SSL OUSTIC	N/A
192 OUSTIC AVENUE E RESIDENTIAL	19 COPPER	2.34 LRHL 41.11 EEL ST. ANNE'S	N/A
194 OUSTIC AVENUE E RESIDENTIAL	19 COPPER	1.27 LRHL 53.88 EEL ST. ANNE'S	N/A
195 OUSTIC AVENUE E RESIDENTIAL	13 COPPER	2.32 LRHL 55.86 EEL ST. ANNE'S	N/A
197 OUSTIC AVENUE E RESIDENTIAL	19 COPPER	1.30 LRHL 63.04 EEL ST. ANNE'S	N/A
198 OUSTIC AVENUE E RESIDENTIAL	19 COPPER	2.32 LRHL 74.45 EEL ST. ANNE'S	N/A
199 OUSTIC AVENUE E RESIDENTIAL	19 COPPER	5.63 RLHL 45.28 WWL PUBLIC LANE BESIDE #203 OUSTIC	N/A
200 OUSTIC AVENUE E RESIDENTIAL	19 COPPER	0.12 RRHL 83.71 EEL ST. ANNE'S	N/A
201 OUSTIC AVENUE E RESIDENTIAL	19 COPPER	4.63 RLHL 30.66 WWL PUBLIC LANE BESIDE #203 OUSTIC	N/A
202 OUSTIC AVENUE E RESIDENTIAL	19 COPPER	0.58 RRHL 93.10 EEL ST. ANNE'S	N/A
203 OUSTIC AVENUE E RESIDENTIAL	19 COPPER	1.70 RLHL 17.86 WWL PUBLIC LANE BESIDE #203 OUSTIC	N/A
204 OUSTIC AVENUE E RESIDENTIAL	19 COPPER	2.33 RRHL 76.69 WWL PUBLIC LANE BESIDE #212 OUSTIC	N/A

- CONSTRUCTION NOTES:**
1. EXPOSE EXISTING WATERMAIN & CONFIRM INVERTS PRIOR TO CONSTRUCTION.
  2. CONFIRM LOCATION OF ALL SERVICES IN THE FIELD.
  3. INSTALL WATERMAIN BY TRENCHLESS METHODS.
  4. TRENCHES AND EXCAVATIONS WITHIN 1 METRE OF A PAVED AREA INCLUDING SIDEWALKS SHALL BE CLASS 3 BACKFILL.
  5. ALL MATERIALS SHALL CONFORM TO THE CITY OF WINNIPEG STANDARD CONSTRUCTION SPECIFICATIONS.
  6. MINIMUM COVER SHALL BE 2.4m.
  7. REPLACE ALL EXISTING LEAD SERVICES FROM PROPOSED WATERMAIN TO PL. OF EXCAVATION.
  8. NOTIFY ALL AFFECTED RESIDENTS AND BUSINESSES 24 HOURS IN ADVANCE OF ANY WATER SHUTDOWNS OR DISRUPTION OF SERVICE.

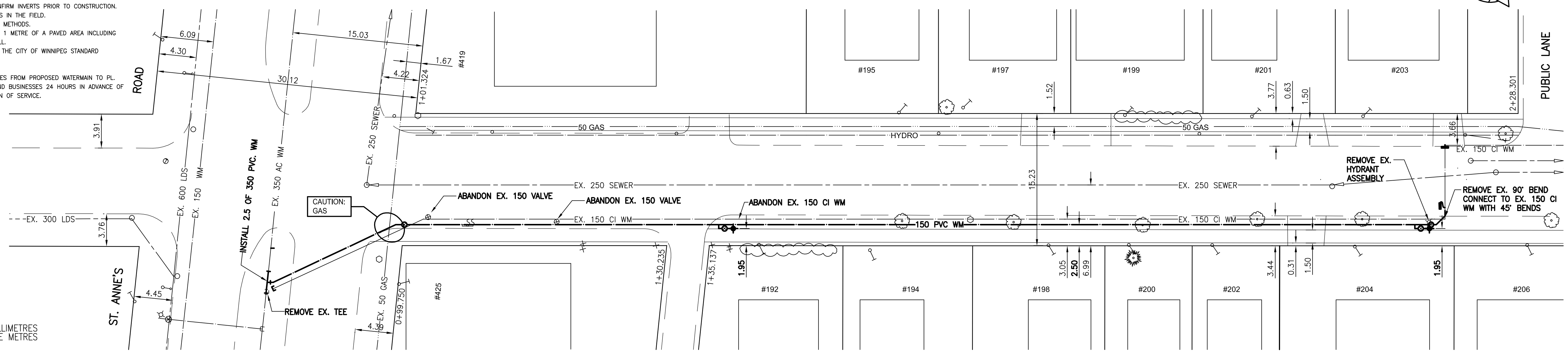

**METRIC**  
WHOLE NUMBERS INDICATE MILLIMETRES  
DECIMALIZED NUMBERS INDICATE METRES

**WARNING**  
IF POWER EQUIPMENT OR EXPLOSIVES ARE TO BE USED FOR EXCAVATION ON THIS PROJECT THE CONTRACTOR MUST:  
1) NOTIFY THE GAS COMPANY OF THE PROPOSED LOCATION OF EXCAVATION.  
2) TAKE PRECAUTION TO AVOID DAMAGE TO GAS COMPANY INSTALLATIONS.  
SEE PROVINCIAL REGULATION 140/92 FOR DETAILS

Bench Mark Tblt. in E. Conc. foundation of new portion of Manitoba Telephone System Bldg., No. 460 St. Anne's Rd., 1.7 m S. of N.E. Cor. of Bldg.

**APEGM**  
Certificate of Authorization  
Stantec Consulting Ltd.  
No. 1301 Expiry: April 30, 2006

150 WM	WATERMAIN	150 WM	HYDRO	150 WM	WATERMAIN	150 WM
+	HYDRANT	+	M.T.S.	+	HYDRANT, VALVE	+
○	VALVE	○	CONCRETE	○	LAND DRAINAGE SEWER	○
300 LDS	LAND DRAINAGE SEWER	300 LDS	ASPHALT	250 WWS	WASTE WATER SEWER	250 WWS
250 WWS	WASTE WATER SEWER	250 WWS	SIDEWALK	-X-	EX. GROUND PROFILE	-X-
○	MANHOLE	○	PROPERTY LINE	□	NORTH OR WEST GUTTER	□
□	CATCH BASIN	□	SURVEY BAR	○	SOUTH OR EAST GUTTER	○
▽	CURB INLET	▽	DITCH	◇	NORTH OR WEST IP	◇
+	JUNCTIONS	+	ELEVATION	○	SOUTH OR EAST IP	○
○	SIGN	○	CURB STOP	△	NORTH OR WEST DITCH	△
○	GAS	○	ANODE	▽	SOUTH OR EAST DITCH	▽
EXISTING	LEGEND-PLAN	PROPOSED	EXISTING	LEGEND-PLAN	PROPOSED	EXISTING

LOCATION APPROVED UNDERGROUND STRUCTURES	
SUPV. U/G STRUCTURES COMMITTEE	DATE
NOTE: LOCATION OF UNDERGROUND STRUCTURES AS SHOWN ARE BASED ON THE BEST INFORMATION AVAILABLE BUT NO GUARANTEE IS GIVEN THAT ALL EXISTING UTILITIES ARE SHOWN OR THAT THE GIVEN LOCATIONS ARE EXACT. CONFIRMATION OF EXISTENCE AND EXACT LOCATION OF ALL SERVICES MUST BE OBTAINED FROM THE INDIVIDUAL UTILITIES BEFORE PROCEEDING WITH CONSTRUCTION.	

**Stantec Consulting Ltd.**  
905 Waverley Street, Winnipeg, Manitoba  
Tel 204-489-5900 Fax 204-453-9012

DESIGNED BY: J.H.  
CHECKED BY: C.L.D./W.B.  
DRAWN BY: K.R.  
APPROVED BY: C.L.D.

HOR. SCALE: 1:250  
VERTICAL: 1:50

RELEASED FOR CONSTRUCTION:  
K. ZUREK P. ENG.  
DATE: 06.23.05

CONSULTANT DRAWING NO. CW-53-614

**THE CITY OF WINNIPEG**  
WATER AND WASTE DEPARTMENT  
ENGINEERING DIVISION

2005 WATERMAIN RENEWALS  
OUSTIC AVENUE  
ST. ANNE'S ROAD TO 45.0m W OF CLAYTON DRIVE  
STA. 1+00 TO STA. 2+20

SHEET 8 OF 15  
CAD FILE DRAWING NUMBER III208260-CI04.dwg  
CITY DRAWING NUMBER D-8786

11/15/05 11:58:53 AM 4500 C:\P\Projects\11208260-CI04.dwg  
 11/15/05 11:58:53 AM 4500 C:\P\Projects\11208260-CI04.dwg  
 11/15/05 11:58:53 AM 4500 C:\P\Projects\11208260-CI04.dwg