



THE CITY OF WINNIPEG

WATER AND WASTE DEPARTMENT

2005 WATERMAIN RENEWALS CONTRACT NO. 8

BID OPPORTUNITY NO. 382-2005

DRAWING INDEX

CITY PLAN NO.	CONSULTANT PLAN NO.			
D-8780	CW-47-614	FENNBARK PLACE	BERNADETTE AVENUE TO CUL-DE-SAC STA. 1+00 TO STA. 1+70	SHEET 1 OF 15
D-8781	CW-48-614	LAKE PARK DRIVE	FROM W LEG LAKE PARK DRIVE TO E LEG LAKE PARK DRIVE STA. 1+00 TO STA. 2+25	SHEET 2 OF 15
D-8782	CW-49-614	LAKE PARK DRIVE	2+25 TO LAKE PARK DRIVE EAST STA. 2+25 TO STA. 3+92	SHEET 3 OF 15
D-8783	CW-50-614	LAKEWOOD BOULEVARD	BEAVERHILL BOULEVARD TO TAMARAC BAY STA. 1+00 TO STA. 2+25	SHEET 4 OF 15
D-8784	CW-51-614	LAKEWOOD BOULEVARD	BEAVERHILL BOULEVARD TO 2+25 STA. 2+25 TO 3+59	SHEET 5 OF 15
D-8785	CW-52-614	CYRIL PLACE	LAKEWOOD BOULEVARD TO CUL-DE-SAC STA. 1+00 TO STA. 1+75	SHEET 6 OF 15
D-8820	CW-59-614	LAKEWOOD BOULEVARD	TAMARAC BAY TO WILLOWLAKE CRESCENT STA. 1+00 TO 2+35	SHEET 7 OF 15
D-8786	CW-53-614	OUSTIC AVENUE	ST. ANNE'S ROAD TO 45.0m W OF CLAYTON DRIVE STA. 1+00 TO STA. 2+20	SHEET 8 OF 15
D-8787	CW-54-614	SADLER AVENUE	ST. DAVID STREET TO ST. GEORGE ROAD STA. 1+00 TO STA. 1+90	SHEET 9 OF 15
D-8788	CW-55-614	SADLER AVENUE	ST. DAVID STREET TO ST. GEORGE ROAD STA. 1+90 TO STA. 2+91	SHEET 10 OF 15
D-8789	CW-56-614	VERMILLION ROAD	WEST LEG OF LAKE PARK DRIVE TO 9m EAST OF BONAVISTA PLACE STA. 1+00 TO STA. 2+00	SHEET 11 OF 15
D-8790	CW-57-614	VERMILLION ROAD	9m EAST OF BONAVISTA PLACE TO EAST LEG OF LAKE PARK DRIVE STA. 2+00 TO STA. 3+00	SHEET 12 OF 15
D-8791	CW-58-614	BONAVISTA PLACE	VERMILLION ROAD TO CUL-DE-SAC STA. 2+20 TO 3+06	SHEET 13 OF 15
05591	CW-59-614	SPRUCE STREET	2ND MH S OF WELLINGTON TO 3RD MH S OF WELLINGTON STA. 1+59 TO 1+62	SHEET 14 OF 15
05592	CW-60-614	ABERDEEN AVENUE	MH AT BATTERY STREET (W LEG) TO MH AT BATTERY ST (SS OF CL) STA. 1+15 TO 1+18	SHEET 15 OF 15

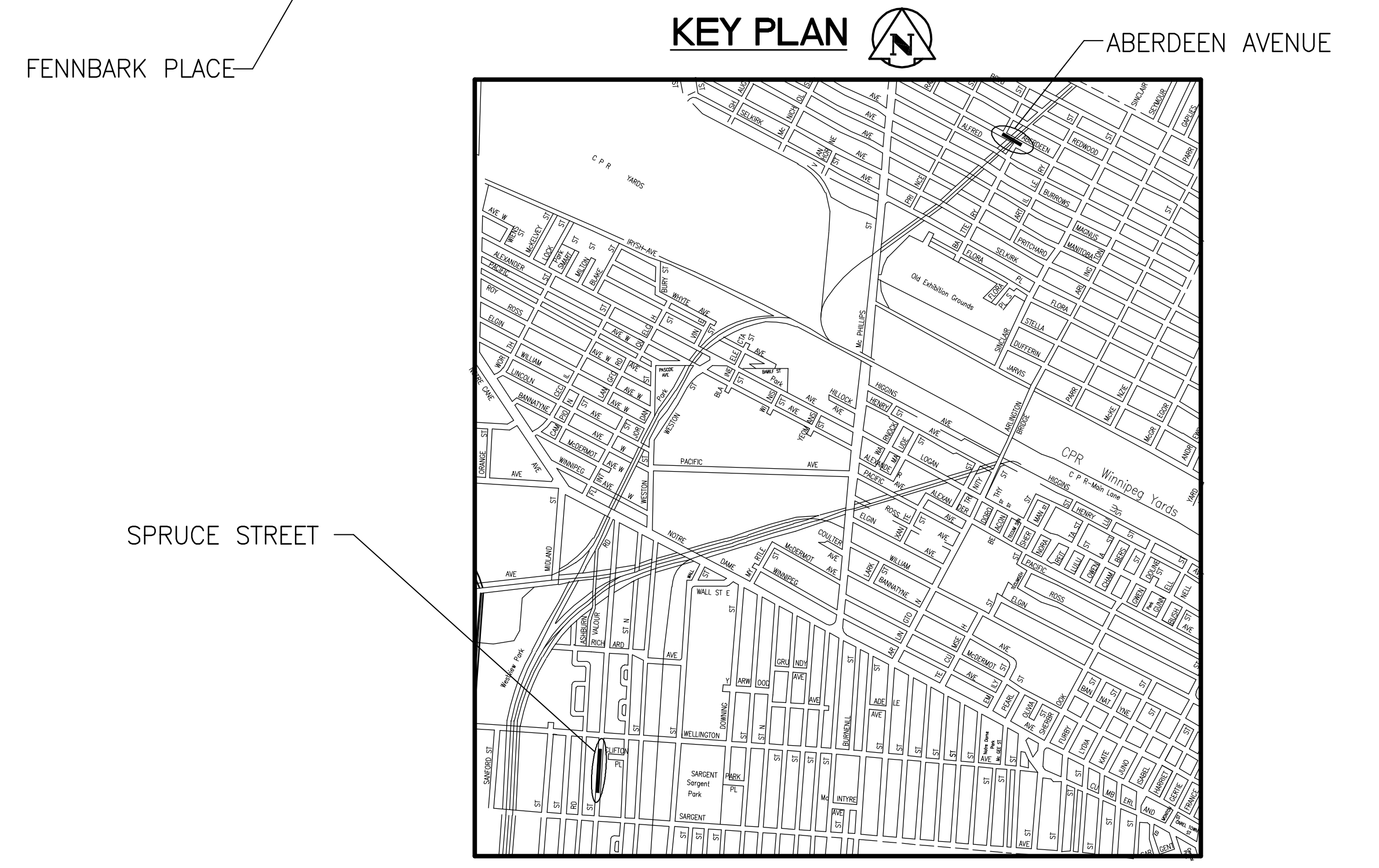
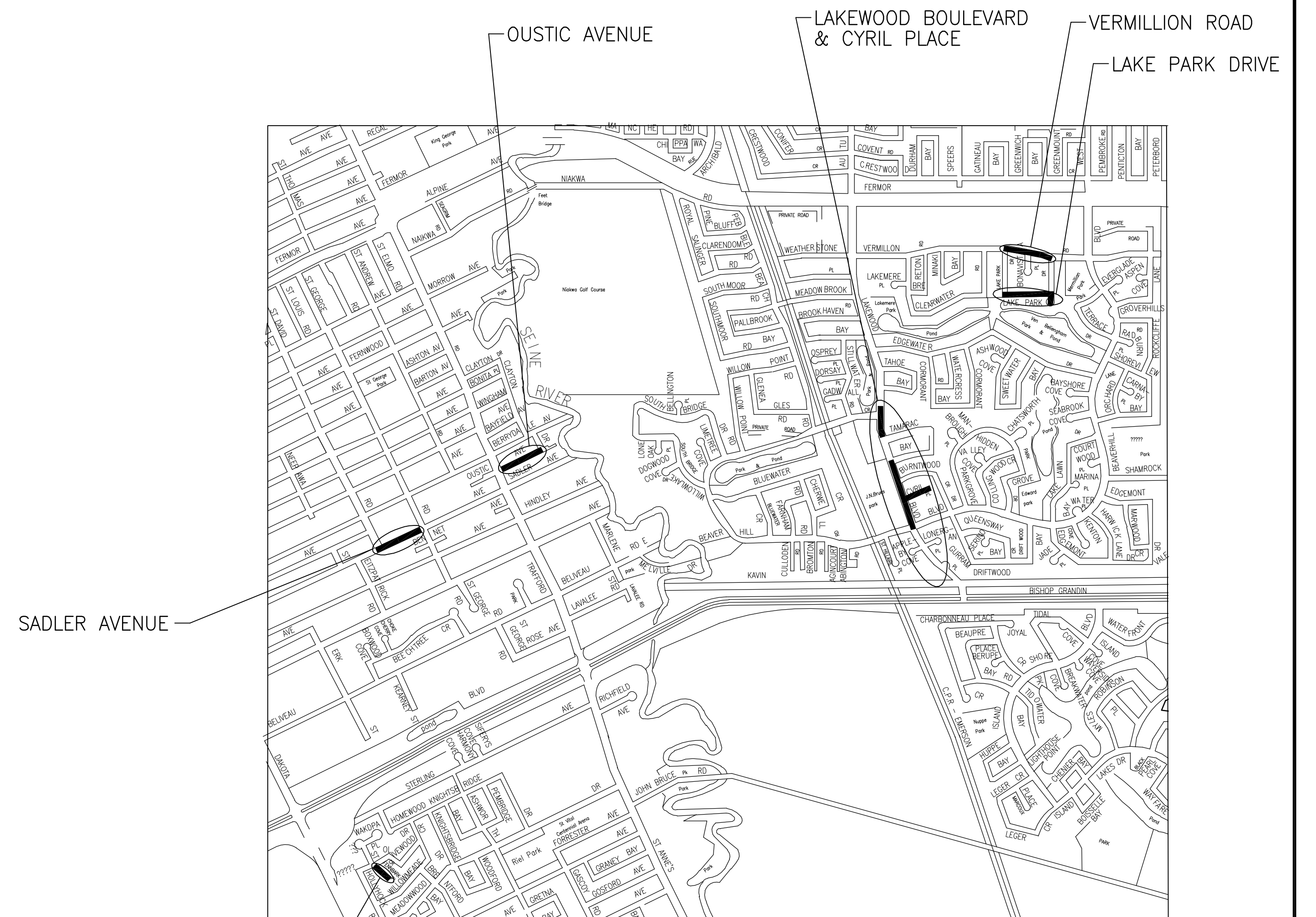

Stantec Consulting Ltd.
WINNIPEG MANITOBA

V:\1110\active\11208260 - 2005 CW W Watermain\Drawings\11208260-0101.dwg
2005-06-23 08:21PM Bp_jhns