

SEE DRAWING D-8795

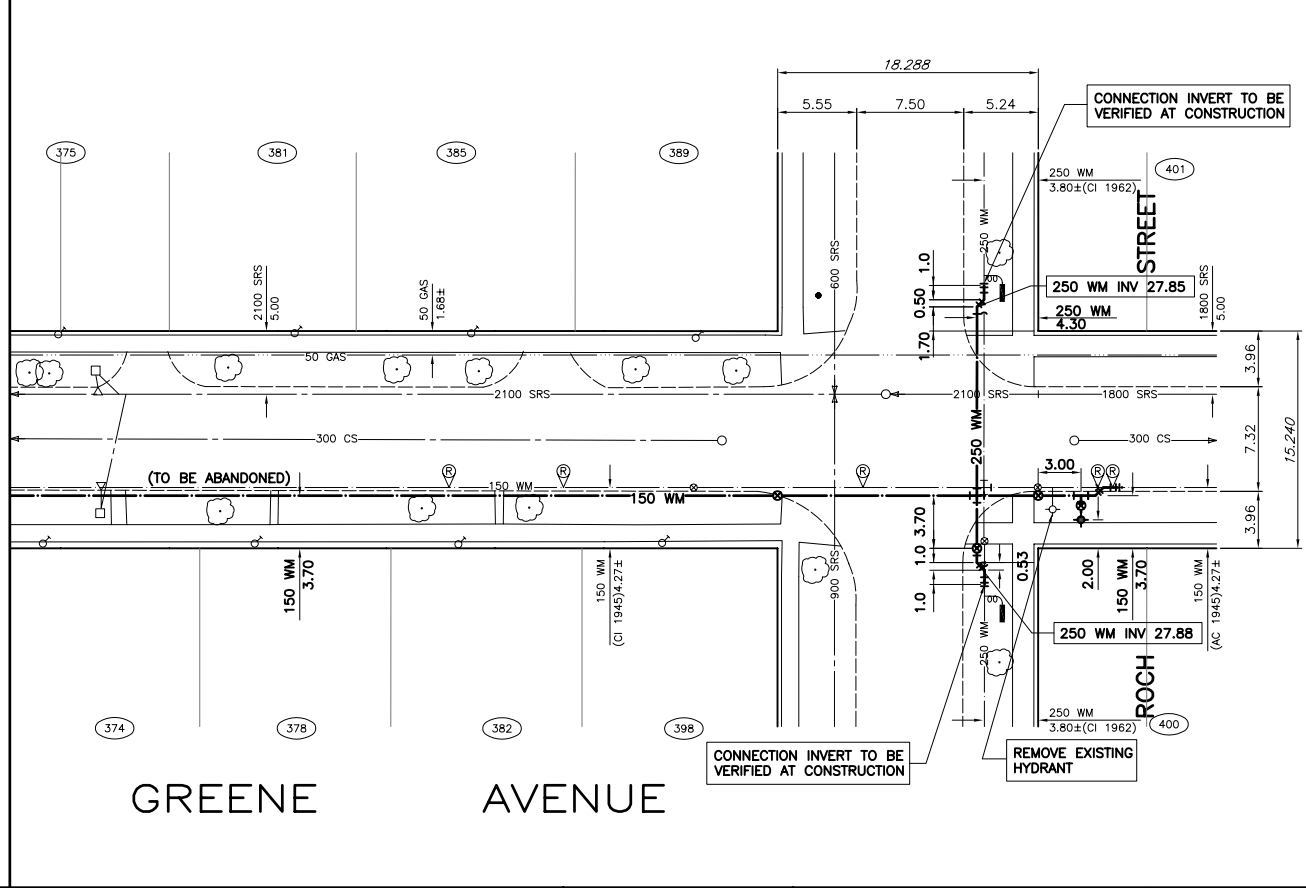

H.R.S.E. No.	SIZE & TYPE	DISTANCE TO P.L.	STOP COCK LOCATION		CORPORATION COCK LOC.	COMMENTS
			SHORT	LONG		
374	20 COP	UNSK	1.21 OF WHL	UNKNOWN		31.21 OF HYD
375	20 COP	UNSK	2.71 OF WHL	UNKNOWN		69.01 OF HYD
378	20 COP	0.3	2.71 OF W.COR USE	UNKNOWN		46.21 OF HYD
381	20 COP	UNSK	3.0 W OF EHL	UNKNOWN		49.71 OF HYD
382	20 COP	0.3	3.41 OF W.COR USE	UNKNOWN		60.21 OF HYD
385	20 COP	0.3	5.81 OF W.COR USE	UNKNOWN		62.81 OF HYD
389	20 COP	UNSK	3.0 W OF EHL	UNKNOWN		76.71 OF W HYD
398	20 COP	0.3	4.61 OF W.COR USE	UNKNOWN		75.11 OF HYD
400	20 COP	0.3	1.2 W OF E.COR USE	UNKNOWN		80.11 OF HYD
401	20 COP	UNSK	3.01 OF WHL	UNKNOWN		42.11 OF HYD

- GENERAL NOTES:**
- CHANGAGE IS ALONG SOUTH PROPERTY LINE OF GREENE AVENUE.
- CONSTRUCTION NOTES:**
- EXPOSE EXISTING WATERMAIN AT TIE-IN LOCATIONS AND CONFIRM INVERT PRIOR TO CONSTRUCTION.
  - INSTALL WATERMAIN BY TRENCHLESS METHODS.
  - ALL MATERIALS SHALL CONFORM TO THE CITY OF WINNIPEG STANDARD CONSTRUCTION SPECIFICATIONS.
  - MINIMUM COVER TO TOP OF WATERMAIN SHALL BE 2.4m.
  - NOTIFY ALL AFFECTED RESIDENTS AND BUSINESSES 24 HOURS IN ADVANCE OF ANY WATER SHUTDOWNS OR DISRUPTION OF SERVICE.



150 WM	WATERMAIN	150 WM	ANCHOR	LOCATION APPROVED UNDERGROUND STRUCTURES	B.M. CITY OF WINNIPEG 12-057 ELEV. 230.475m	F.B. 2091		DESIGNED BY GWC CHECKED BY DRAWN BY GMD APPROVED BY HOR. SCALE: 1 : 250 VERTICAL: 1 : 50 DATE 05.06.03	ORIGINAL DRAWING REVISION * - SEALED BY H.A.K. KATZ 05.06.30	THE CITY OF WINNIPEG WATER AND WASTE DEPARTMENT 2005 WATERMAIN RENEWALS CONTRACT No. 9 GREENE AVENUE 225m EAST OF BRAZIER STREET TO ROCH STREET	CITY DRAWING NUMBER D-8796 SHEET 5 OF 14 C4005
400 FM	FEEDERMAIN	400 FM	ANCHOR TREE								
300 LDS	LAND DRAINAGE SEWER	300 LDS	BEND TEE	LEGAL DIMENSION SURVEY BAR TRAFFIC SIGNAL GAS HYDRO MTS SIDEWALK CURB							
250 WWS	WASTEWATER SEWER	250 WWS	CURB STOP								
300 CS	COMBINED SEWER	300 CS	PLUG								
200 FCM	FORCEMAIN	200 FCM	MANHOLE								
	JUNCTIONS		CATCHBASIN								
	HYDRANT		CURB INLET								
	VALVE		ADDRESS								
	REDUCER		HYDRO POLE								
EXISTING	LEGEND-PLAN	PROPOSED	LEGEND-PLAN	PROPOSED	EXISTING	LEGEND-PLAN	PROPOSED				