

DESCRIPTION	RIM	INVERT			
		NORTH	SOUTH	EAST	WEST
CB 1	32.800				31.245
CB 2	32.725			31.150	
CB 3	32.795				31.245
CB 4	32.825				31.260

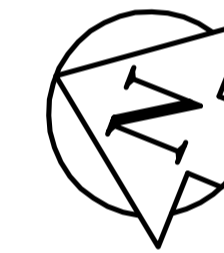

- REFERENCE NOTES**
- BASELINE IS CENTRED BETWEEN NORTHBOUND AND SOUTHBOUND GUTTER BACK OF CURB LINE.
 - LEGAL PLAN - L.B.I.S.
 - ADD 200.000 TO OBTAIN GEODETIC DATUM.
 - PAVEMENT DIMENSIONS ARE TO BACK OF CURB.
 - EARTH TECH FIELD BOOK NO. 4405.

- CONSTRUCTION NOTES**
- PLANE AND CONSTRUCT NEW ASPHALTIC CONCRETE OVERLAY.
 - CONSTRUCT NEW 200mm PLAIN DOWELLED CONCRETE PAVEMENT c/w ASPHALTIC CONCRETE OVERLAY.
 - ABANDON EXISTING DRAINAGE INLET.
 - ABANDON EXISTING CATCHBASIN.
 - INSTALL NEW CURB AND GUTTER INLET c/w CATCHBASIN (SD024) AND CONNECT TO EXISTING CATCHBASIN LEAD.
 - ADJUST EXISTING CATCHBASIN FRAME AND COVER.
 - CONSTRUCT NEW MONOLITHIC CONCRETE BULLNOSE.
 - CONSTRUCT NEW CONCRETE MEDIAN SLAB & SAFETY CURB.
 - CONSTRUCT NEW MONOLITHIC CONCRETE SPLASH STRIP.
 - ADJUST EXISTING WATERMAIN VALVE BOX TO GRADE.
 - ADJUST EXISTING MANHOLE FRAME AND COVER.
 - INSTALL NEW WATERMAIN VALVE BOX EXTENDABLE SECTION INSERT.
 - INSTALL NEW CAST IRON RISER RING.
 - ADJUST EXISTING CURB STOP TO GRADE.

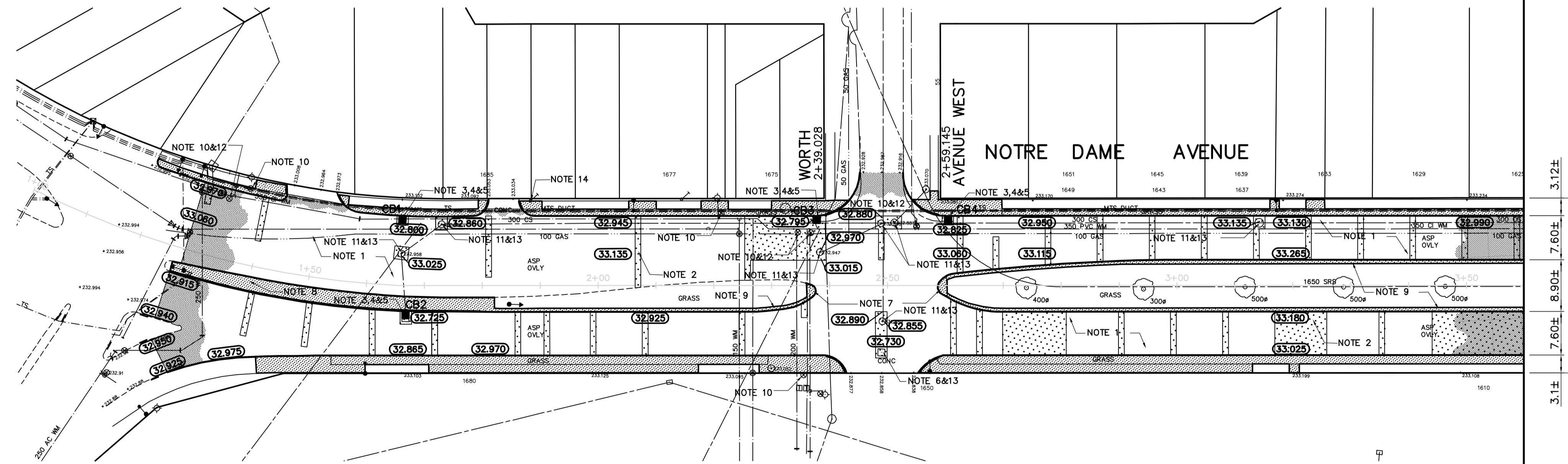

APEGM
 Certificate of Authorization
 Earth Tech Canada Inc.
 No. 730 Expiry: April 30, 2005

METRIC
 WHOLE NUMBERS INDICATE MILLIMETRES
 DECIMALIZED NUMBERS INDICATE METRES

150 mm W.M.	WATERMAIN	150 mm W.M.	HYDRO	EXISTING	LEGEND - PLAN	PROPOSED	EXISTING	LEGEND - PLAN	PROPOSED	EXISTING	LEGEND - PROFILE	PROPOSED
⊕	HYDRANT	⊕	M.T.S.	---	---	---	---	---	---	---	---	---
⊕	VALVE	⊕	CONCRETE	---	---	---	---	---	---	---	---	---
⊕	LAND DRAINAGE SEWER	⊕	ASPHALT	---	---	---	---	---	---	---	---	---
⊕	WASTEWATER SEWER	⊕	PROPERTY LINE	---	---	---	---	---	---	---	---	---
○	MANHOLE	○	SURVEY BAR	---	---	---	---	---	---	---	---	---
□	CATCH BASIN	□	ELEVATION	---	---	---	---	---	---	---	---	---
▽	CURB INLET	▽	TREE	---	---	---	---	---	---	---	---	---
---	JUNCTIONS	---	SIDEWALK RAMP	---	---	---	---	---	---	---	---	---
---	CULVERT	---	CONCRETE SIDEWALK	---	---	---	---	---	---	---	---	---
---	GAS	---	FENCE	---	---	---	---	---	---	---	---	---

LOCATION APPROVED
UNDERGROUND STRUCTURES

SUPV. U/G STRUCTURES COMMITTEE DATE

NOTE:
 LOCATION OF UNDERGROUND STRUCTURES AS SHOWN ARE BASED ON THE BEST INFORMATION AVAILABLE, BUT NO GUARANTEE IS GIVEN THAT ALL EXISTING UTILITIES ARE SHOWN OR THAT THE GIVEN LOCATIONS ARE EXACT. CONFIRMATION OF EXISTENCE AND EXACT LOCATION OF ALL SERVICES MUST BE OBTAINED FROM THE INDIVIDUAL UTILITIES BEFORE PROCEEDING WITH CONSTRUCTION.

B.M. 36-031
 ELEV. 233.527

SE cor. Notre Dame Ave. & Winnipeg Ave. W. 1/4th 20' S. cor. Transition No. 1485 Notre Dame Ave., 1m E. & 0.3m below conc. blocks of S.W. cor. of Bldg.

NO.	REVISIONS	DATE	BY
0	ISSUED FOR TENDER	03/05	BC
A	ISSUED FOR REVIEW	01/05	BC

EARTH TECH
 Earth Tech (Canada) Inc. Winnipeg, Manitoba 204.477.5381

DESIGNED BY	CHECKED BY
BSK	BC

DRAWN BY	APPROVED BY
BSK	

HOR. SCALE: 1=500
 VERTICAL: 1=20

RELEASED FOR CONSTRUCTION BY: _____

DATE: 2004/12/01

ENGINEER'S SEAL
 PROVINCE OF MANITOBA
 ORIGINAL SIGNED
T.G. SMITH
 MAR. 16, 2005
 REGISTERED PROFESSIONAL ENGINEER

THE CITY OF WINNIPEG
 PUBLIC WORKS DEPARTMENT
 ENGINEERING DIVISION

NOTRE DAME AVENUE
 KEEWATIN STREET TO DUBLIN AVENUE
 CONCRETE REPAIRS AND ASPHALT RESURFACING

PLAN - PROFILE
 KEEWATIN STREET TO STA. 3+60

CITY DRAWING NUMBER
 P-3255-02
 SHEET 2 OF 4

0