

**EAST APPROACH PAVEMENT PROFILE**

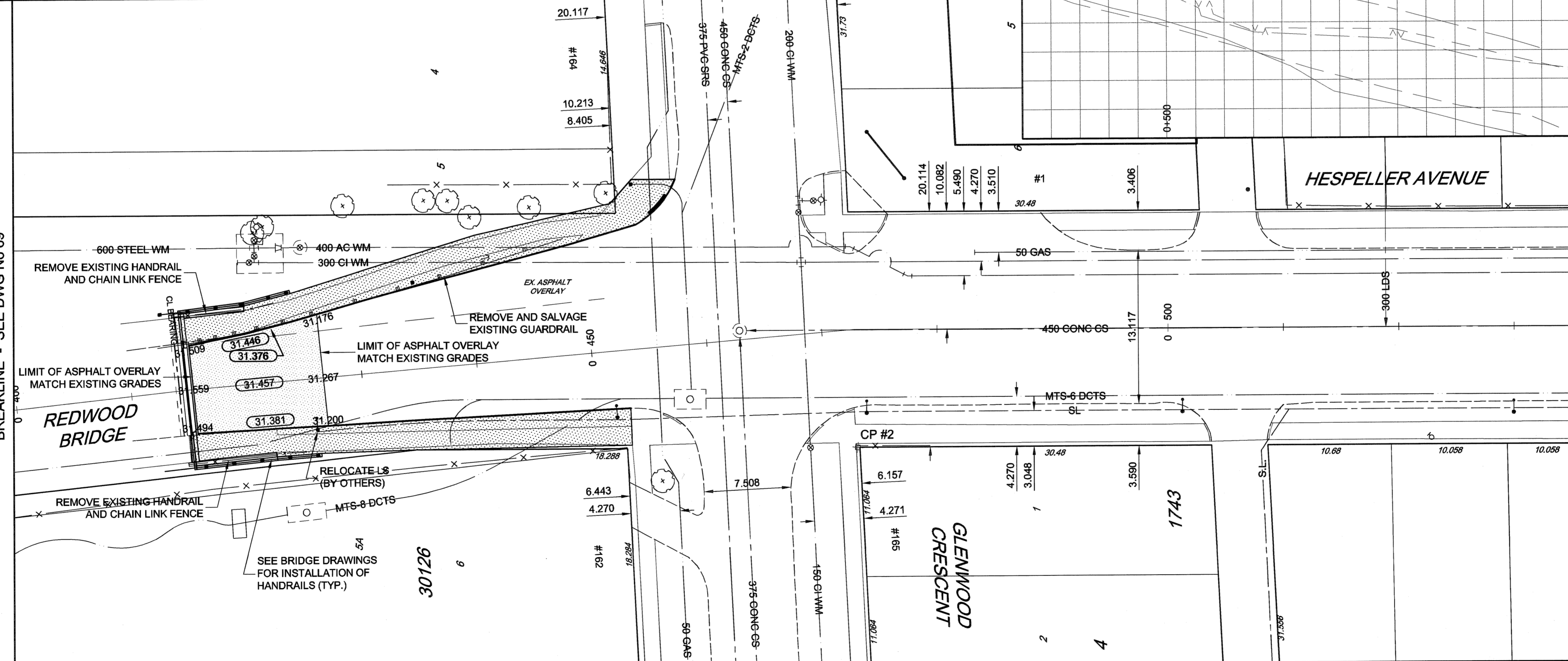

- NOTES**
1. ADJUST MH. AND CB RIMS TO NEW GRADES
  2. LAMP STANDARDS, HYDRO POLES AND ANCHORS MAY REQUIRE TEMPORARY SUPPORT/REMOVAL OR REPLACEMENT AT THE CONTRACTOR'S EXPENSE.
  3. CONTRACTOR SHALL TAKE PRECAUTIONARY STEPS TO AVOID DAMAGE TO EXISTING BOULEVARD TREES FROM CONSTRUCTION ACTIVITIES WITHIN THE LIMITS OF CONSTRUCTION AS OUTLINED IN THE SPECIFICATIONS.
  4. MINIMUM 1.98m CLEAR LATERAL DISTANCE BETWEEN BACK OF PROPOSED SIDEWALKS AND ABBR POSTS/LS's.
  5. ADD 200.000m TO ABBREVIATED ELEVATIONS FOR GEODETIC ELEVATIONS.
  6. SEE DRAWING NO. 73 FOR INSTALLATION OF ALUMINUM BALANCED BARRIER RAIL AND POSTS.

**METRIC**  
WHOLE NUMBERS INDICATE MILLIMETRES  
DECIMALIZED NUMBERS INDICATE METRES

Bid Opportunity No. 257-2005

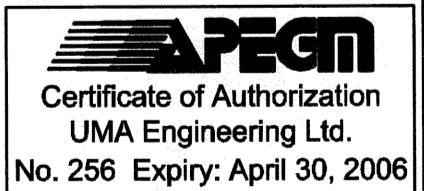

EXISTING	LEGEND - PLAN	PROPOSED	EXISTING	LEGEND - PLAN	PROPOSED	EXISTING	LEGEND - PLAN	PROPOSED	
	GAS		MANHOLE		CONCRETE		ASPHALT		LOCATION APPROVED
	MTS		CATCH BASIN/CATCH PIT		MONOLITHIC BULLNOSE		CONCRETE SIDEWALK		UNDERGROUND STRUCTURES
	HYDRO		C & G INLET W/BOX		PAVING STONE		TOPSOIL & SOD		SUPR. U/G STRUCTURES
	VIDEON		TREE		GRAVEL		RAMP CURB		DATE
	TRAFFIC SIGNALS		TEST HOLE		REMOVAL		PROPERTY LINE		NOTE:
	LAND DRAINAGE SEWER		SURVEY BAR		FENCE		BACK OF CURB		LOCATION OF UNDERGROUND STRUCTURES AS SHOWN ARE BASED ON THE BEST INFORMATION AVAILABLE BUT NO GUARANTEE IS GIVEN THAT ALL EXISTING UTILITIES ARE SHOWN OR THAT THE GIVEN LOCATIONS ARE EXACT. CONFIRMATION OF EXISTENCE AND EXACT LOCATION OF ALL SERVICES MUST BE OBTAINED FROM THE INDIVIDUAL UTILITIES BEFORE PROCEEDING WITH CONSTRUCTION.
	SANITARY/COMBINED SEWER		ELEVATION		DITCH		ELEVATION		
	CATCH BASIN LEAD		ELEVATION		DITCH		ELEVATION		
	WATERMAIN		ELEVATION		DITCH		ELEVATION		
	SUBDRAIN		ELEVATION		DITCH		ELEVATION		
	DITCH		ELEVATION		DITCH		ELEVATION		

**LOCATION APPROVED**  
UNDERGROUND STRUCTURES

SUPR. U/G STRUCTURES COMMITTEE DATE

**NOTE:**  
LOCATION OF UNDERGROUND STRUCTURES AS SHOWN ARE BASED ON THE BEST INFORMATION AVAILABLE BUT NO GUARANTEE IS GIVEN THAT ALL EXISTING UTILITIES ARE SHOWN OR THAT THE GIVEN LOCATIONS ARE EXACT. CONFIRMATION OF EXISTENCE AND EXACT LOCATION OF ALL SERVICES MUST BE OBTAINED FROM THE INDIVIDUAL UTILITIES BEFORE PROCEEDING WITH CONSTRUCTION.

B.M.	26-030	S.E. Cm. Main St. & Redwood Ave. Tblt. In N. side foundation of Bldg. known as Holy Family Nursing Home, 5.8m W. of N.E. cm. of bldg. & 0.2m below btm. of metal doors
ELEV.	231.995m	
NO.	ISSUED FOR CONSTRUCTION	05/07/05
NO.	REVISIONS	DATE BY

**UMA** UMA Engineering Ltd.  
• Consulting • Engineering • Construction • Management Services

DESIGNED BY	JGK	CHECKED BY	RPB
DRAWN BY	DID	APPROVED BY	BuB
HOR. SCALE:	1:250	ACCEPTED BY	
VERTICAL:	1:10	DATE	2005-07-07

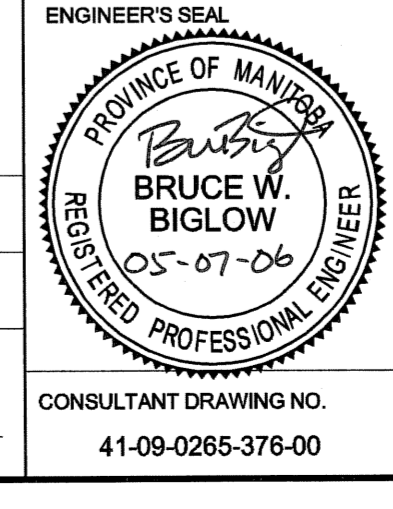

**THE CITY OF WINNIPEG**  
PUBLIC WORKS DEPARTMENT  
ENGINEERING DIVISION

**REDWOOD BRIDGE**  
REHABILITATIVE MAINTENANCE AND RELATED WORKS

EAST APPROACH PAVEMENT RESURFACING REMOVALS, HORIZONTAL & VERTICAL ALIGNMENT EAST EXPANSION JOINT TO 0+500

CITY DRAWING NUMBER B113-05-71  
SHEET 71 OF 74  
REV 71 0

PLOT SCALE = 1:0.25  
AutoCAD 15.05 P:\0265\355-03\ALD\Redwood Bridge.dwg Site.dwg 2005-06-25 1:26pm DID