

NOTE: CHAINAGES SHOWN ARE ALONG E. R. OF LANGSIDE ST.

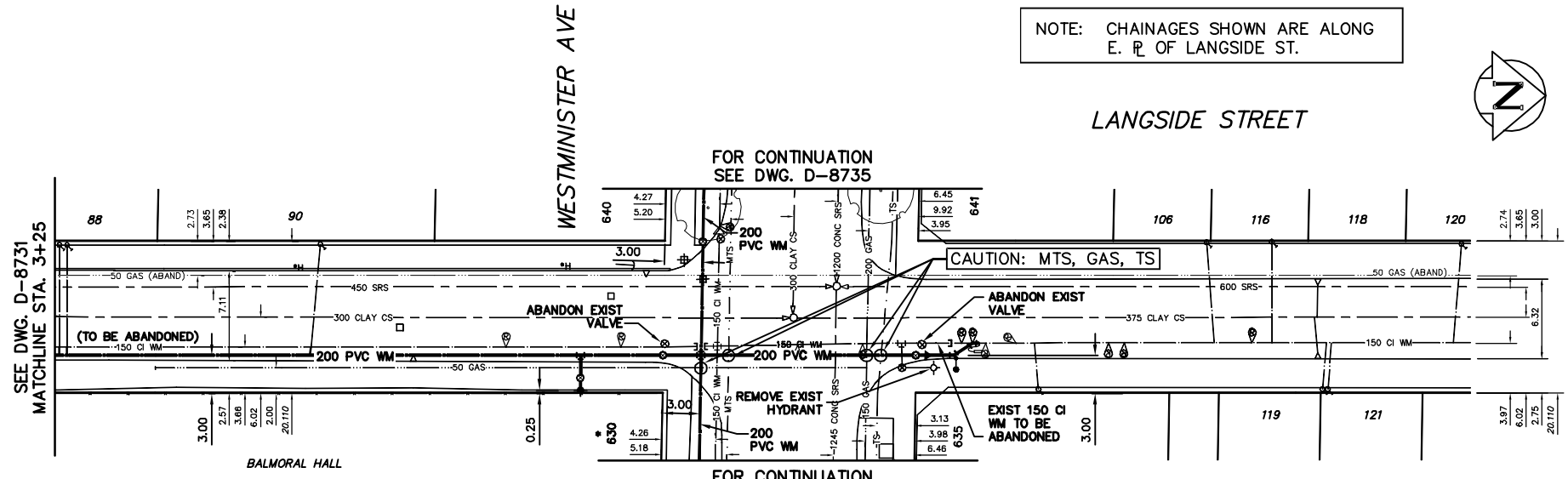

- CONSTRUCTION NOTES**
1. EXPOSE EXISTING WATERMAIN & CONFIRM INVERTS PRIOR TO CONSTRUCTION.
 2. CONFIRM LOCATION OF ALL SERVICES IN THE FIELD.
 3. INSTALL WATERMAIN BY TRENCHLESS METHODS.
 4. TRENCHES AND EXCAVATIONS WITHIN 1 METRE OF A PAVED AREA INCLUDING SIDEWALKS SHALL BE CLASS 3 BACKFILL.
 5. ALL MATERIALS SHALL CONFORM TO THE CITY OF WINNIPEG STANDARD CONSTRUCTION SPECIFICATIONS.
 6. MINIMUM COVER TO TOP OF WATERMAIN SHALL BE 2.4 m.
 7. REPLACE ALL EXISTING LEAD SERVICES FROM PROPOSED WATERMAIN TO R.
 8. NOTIFY ALL AFFECTED RESIDENTS AND BUSINESSES 24 HOURS IN ADVANCE OF ANY WATER SHUTDOWNS OR DISRUPTION OF SERVICE.



WATER SERVICE INFORMATION

ADDRESS	SIZE(mm) & TYPE (STREET)	SIZE(mm) & TYPE (PROP)	SHORT & LONG MEASUREMENT	CORP. LOCATION	REMARKS
88 LANGSIDE ST RESIDENTIAL	20 COPPER	13 LEAD	0.30 SSL HSE	OPP S/C	-
90 LANGSIDE ST RESIDENTIAL	25 COPPER	25 COPPER	7.92 SNL BLDG	0.76 S OF S/C	REV. TAPPED
106 LANGSIDE ST RESIDENTIAL	13 LEAD	20 COPPER	27.73 SSL WESTMINSTER	0.61 N OF S/C	-
116 LANGSIDE ST RESIDENTIAL	13 LEAD	13 COPPER	22.86>NNL WESTMINSTER	OPP S/C	-
118 LANGSIDE ST RESIDENTIAL	20 COPPER	20 COPPER	0.61 S OF S/C	DBL. SERV. W/ #120	-
119 LANGSIDE ST RESIDENTIAL	20 COPPER	13 COPPER	5.39>NNL BLDG	0.61 S OF S/C	-
120 LANGSIDE ST RESIDENTIAL	20 COPPER	20 COPPER	4.39>NN P	0.3 N OF S/C	-
121 LANGSIDE ST RESIDENTIAL	20 COPPER	13 COPPER	0.91>NNL HSE	0.3 N OF S/C	-
122 LANGSIDE ST RESIDENTIAL	20 COPPER	20 COPPER	32.00>NNL WESTMINSTER	0.61 S OF S/C	DBL. SERV. W/ #118
123 LANGSIDE ST RESIDENTIAL	20 COPPER	20 COPPER	3.60>NNL BLDG	0.61 S OF S/C	-
124 LANGSIDE ST RESIDENTIAL	20 COPPER	20 COPPER	4.79>NN P	-	-

*SERVICES TO BE RENEWED TO R ALL OTHERS TO BE RECONNECTED

WATER SERVICE INFORMATION

ADDRESS	SIZE(mm) & TYPE (STREET)	SIZE(mm) & TYPE (PROP)	SHORT & LONG MEASUREMENT	CORP. LOCATION	REMARKS
121 LANGSIDE ST RESIDENTIAL	20 COPPER	13 COPPER	1.52 SSL HSE	0.30 N OF S/C	-
630 WESTMINSTER AVE COMMERCIAL	150 PVC	150 PVC	32.31>NNL WESTMINSTER	OPP VALVE	SERV. OFF LANGSIDE RENEW TO R
630 WESTMINSTER AVE COMMERCIAL	150 PVC	150 PVC	41.15>NNL BLDG	OPP VALVE	SERV. OFF LANGSIDE
630 WESTMINSTER AVE COMMERCIAL	25 COPPER	25 COPPER	115.82>NNL WESTMINSTER	OPP VALVE	SERV. OFF LANGSIDE
630 WESTMINSTER AVE COMMERCIAL	25 COPPER	25 COPPER	38.52>NNL BLDG	OPP VALVE	SERV. OFF LANGSIDE
630 WESTMINSTER AVE COMMERCIAL	25 COPPER	25 COPPER	117.96>NNL WESTMINSTER	OPP VALVE	SERV. OFF LANGSIDE
630 WESTMINSTER AVE COMMERCIAL	25 COPPER	25 COPPER	18.59>NNL BLDG	OPP VALVE	SERV. OFF LANGSIDE
630 WESTMINSTER AVE COMMERCIAL	25 COPPER	25 COPPER	49.38>NNL WESTMINSTER	OPP VALVE	SERV. OFF LANGSIDE
630 WESTMINSTER AVE COMMERCIAL	25 COPPER	25 COPPER	1.83>NNL BLDG	OPP VALVE	SERV. OFF LANGSIDE
630 WESTMINSTER AVE COMMERCIAL	25 COPPER	25 COPPER	9.45>NNL WESTMINSTER	OPP VALVE	SERV. OFF LANGSIDE
640 WESTMINSTER AVE RESIDENTIAL	25 LEAD	25 LEAD	3.66 EW FR. ENTRANCE	OPP S/C	SOUTH SERVICE SERV. OFF WESTMINSTER
641 WESTMINSTER AVE RESIDENTIAL	25 LEAD	25 LEAD	19.51>NNL LANGSIDE	OPP S/C	SOUTH SERVICE SERV. OFF WESTMINSTER
641 WESTMINSTER AVE RESIDENTIAL	25 LEAD	25 LEAD	OPP CNT. E ENTRANCE	OPP S/C	SOUTH SERVICE SERV. OFF WESTMINSTER
641 WESTMINSTER AVE RESIDENTIAL	25 LEAD	25 LEAD	7.92>NNL LANGSIDE	OPP S/C	SOUTH SERVICE SERV. OFF WESTMINSTER

*SERVICES TO BE RENEWED TO R ALL OTHERS TO BE RECONNECTED

METRIC

WHOLE NUMBERS INDICATE MILLIMETRES
DECIMALIZED NUMBERS INDICATE METRES

NOTE: ALL VALVES TO BE INSTALLED COUNTERCLOCKWISE TO CLOSE

WARNING

IF POWER EQUIPMENT OR EXPLOSIVES ARE TO BE USED FOR EXCAVATION ON THIS PROJECT THE CONTRACTOR MUST:
1) NOTIFY THE GAS COMPANY OF THE PROPOSED LOCATION OF EXCAVATION.
2) TAKE PRECAUTION TO AVOID DAMAGE TO GAS COMPANY INSTALLATIONS.
SEE PROVINCIAL REGULATION 210/72 FOR DETAILS

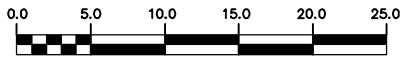

200 WM	WATERMAIN	200 WM	SL, HYDRO	150 WM	WATERMAIN	150 WM
⊕	HYDRANT	⊕	MTS	⊕	HYDRANT	⊕
⊙	VALVE	⊙	TRAFFIC SIGNALS	⊙	VALVE	⊙
525 LDS	LAND DRAINAGE SEWER	525 LDS	GAS	300 LDS	LAND DRAINAGE SEWER	300 LDS
375 WWS	WASTEWATER SEWER	375 WWS	SURVEY BAR	250 WWS	WASTEWATER SEWER	250 WWS
○	MANHOLE	○	FENCE	⊕	PROFILE	⊕
□	CATCH BASIN	□	POLE - HYDRO, MTS	⊕	GROUND ABOVE PIPE	⊕
▽	CURB INLET	▽	CURB STOP	⊕		⊕
∇	REDUCER	∇	GUY ANCHOR	⊕		⊕
X	COUPLING	X	LIGHT STANDARD	⊕		⊕
⊕	ANODE	⊕	TREE	⊕		⊕
EXISTING	LEGEND-PLAN	PROPOSED	EXISTING	LEGEND-PLAN	PROPOSED	EXISTING
EXISTING	LEGEND-PROFILE	PROPOSED	EXISTING	LEGEND-PROFILE	PROPOSED	EXISTING

LOCATION APPROVED UNDERGROUND STRUCTURES

NOTE:
LOCATION OF UNDERGROUND STRUCTURES AS SHOWN ARE BASED ON THE BEST INFORMATION AVAILABLE BUT NO GUARANTEE IS GIVEN THAT ALL EXISTING UTILITIES ARE SHOWN OR THAT THE GIVEN LOCATIONS ARE EXACT. CONFIRMATION OF EXISTENCE AND EXACT LOCATION OF ALL SERVICES MUST BE OBTAINED FROM THE INDIVIDUAL UTILITIES BEFORE PROCEEDING WITH CONSTRUCTION.

NO.	REVISIONS	DATE	BY

CITY OF WINNIPEG WATER AND WASTE ENGINEERING DIVISION

DESIGNED BY: SC
CHECKED BY: TW
DRAWN BY: CJH
APPROVED BY: KZ

HOR. SCALE: 1:250
VERTICAL: 1:50

DATE: 2005 06 09

ENGINEER'S SEAL
ORIGINAL SIGNED BY K.R. ZUREK
05/06/09

THE CITY OF WINNIPEG WATER AND WASTE DEPARTMENT

2005 WATERMAIN RENEWALS

LANGSIDE STREET
225 N OF N R. CORNISH AVENUE TO
25 N OF N R. WESTMINSTER AVENUE

SHEET 11 OF 16
CITY DRAWING NUMBER
D-8732

BID OPPORTUNITY: 244-2005
FILENAME: D-8730_31_32_35.dwg
PLOT DATE: 2005 06 09