

NOTE: CHAINAGES SHOWN ARE ALONG E. R. OF ELLEN ST.

WATER SERVICE INFORMATION					
ADDRESS	SIZE(mm) & TYPE (STREET)	SIZE(mm) & TYPE (PROP)	SHORT & LONG MEASUREMENT	CORP. LOCATION	REMARKS
149 ELLEN ST RESIDENTIAL	20 COPPER	13 LEAD	5.49 SNL BLDG 30.48>NNL WILLIAM	0.61 N OF S/C	SERV. FROM ELLEN
154 ELLEN ST RESIDENTIAL	20 COPPER	20 COPPER	3.69 SNL HSE 31.39 SSL ELGIN	OPP S/C	SERV. FROM ELLEN
387 WILLIAM AVE RESIDENTIAL	13 LEAD	-	3.35 SNL BLDG 15.55>NNL WILLIAM	1.22 N OF S/C	SERV. FROM ELLEN RENEW W/ 20 COPPER
397 WILLIAM AVE COMMERCIAL	20 COPPER	25 COPPER	0.76 WEL HSE 11.89 WML ELLEN	0.61 E OF S/C	SERV. FROM WILLIAM
388 ELGIN AVE RESIDENTIAL	20 COPPER	20 LEAD	0.49 FWL HSE 6.71 EEL ELLEN	OPP S/C	SERV. FROM ELGIN
402 ELGIN AVE RESIDENTIAL	20 COPPER	13 LEAD	28.34 WEL HSE 4.57 WML ELLEN	0.92 E OF S/C	SERV. FROM ELGIN

*SERVICES TO BE RENEWED TO R. ALL OTHERS TO BE RECONNECTED

- CONSTRUCTION NOTES**
1. EXPOSE EXISTING WATERMAIN & CONFIRM INVERTS PRIOR TO CONSTRUCTION.
 2. CONFIRM LOCATION OF ALL SERVICES IN THE FIELD.
 3. INSTALL WATERMAIN BY TRENCHLESS METHODS.
 4. TRENCHES AND EXCAVATIONS WITHIN 1 METRE OF A PAVED AREA INCLUDING SIDEWALKS SHALL BE CLASS 3 BACKFILL.
 5. ALL MATERIALS SHALL CONFORM TO THE CITY OF WINNIPEG STANDARD CONSTRUCTION SPECIFICATIONS.
 6. MINIMUM COVER TO TOP OF WATERMAIN SHALL BE 2.4 m.
 7. REPLACE ALL EXISTING LEAD SERVICES FROM PROPOSED WATERMAIN TO R.
 8. NOTIFY ALL AFFECTED RESIDENTS AND BUSINESSES 24 HOURS IN ADVANCE OF ANY WATER SHUTDOWNS OR DISRUPTION OF SERVICE.

METRIC
WHOLE NUMBERS INDICATE MILLIMETRES
DECIMALIZED NUMBERS INDICATE METRES

NOTE: ALL VALVES TO BE INSTALLED COUNTERCLOCKWISE TO CLOSE

WARNING

IF POWER EQUIPMENT OR EXPLOSIVES ARE TO BE USED FOR EXCAVATION ON THIS PROJECT THE CONTRACTOR MUST:
1) NOTIFY THE GAS COMPANY OF THE PROPOSED LOCATION OF EXCAVATION.
2) TAKE PRECAUTION TO AVOID DAMAGE TO GAS COMPANY INSTALLATIONS.
SEE PROVINCIAL REGULATION 210/72 FOR DETAILS

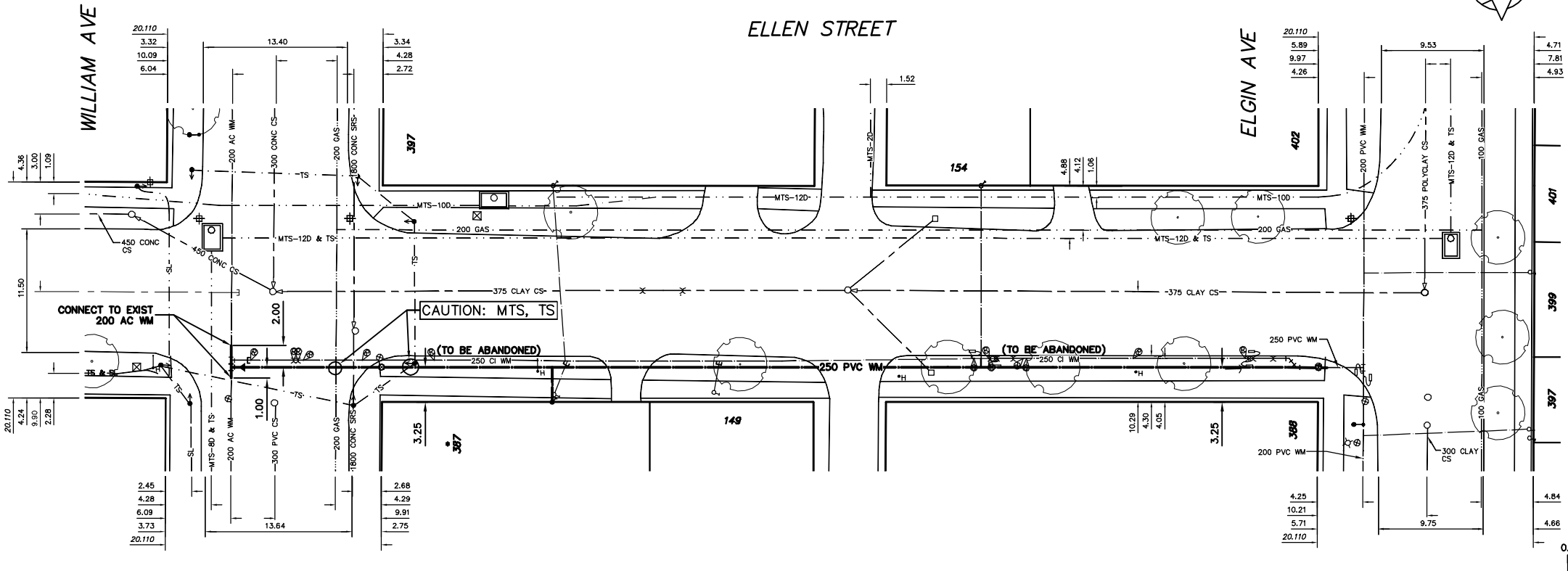

200 WM	WATERMAIN	200 WM	SL, HYDRO	150 WM	WATERMAIN	150 WM
⊕	HYDRANT	⊕	MTS	⊕	HYDRANT	⊕
⊙	VALVE	⊙	TRAFFIC SIGNALS	⊙	VALVE	⊙
525 LDS	LAND DRAINAGE SEWER	525 LDS	GAS	300 LDS	LAND DRAINAGE SEWER	300 LDS
375 WWS	WASTEWATER SEWER	375 WWS	SURVEY BAR	250 WWS	WASTEWATER SEWER	250 WWS
○	MANHOLE	○	FENCE	⊕	PROFILE	⊕
□	CATCH BASIN	□	POLE - HYDRO, MTS	⊕	GROUND ABOVE PIPE	⊕
▽	CURB INLET	▽	CURB STOP	⊕		⊕
◁	REDUCER	◁	GUY ANCHOR			
X	COUPLING	X	LIGHT STANDARD			
⊕	ANODE	⊕	TREE			
EXISTING	LEGEND-PLAN	PROPOSED	EXISTING	LEGEND-PLAN	PROPOSED	EXISTING
				LEGEND-PROFILE		

LOCATION APPROVED UNDERGROUND STRUCTURES

NOTE: LOCATION OF UNDERGROUND STRUCTURES AS SHOWN ARE BASED ON THE BEST INFORMATION AVAILABLE BUT NO GUARANTEE IS GIVEN THAT ALL EXISTING UTILITIES ARE SHOWN OR THAT THE GIVEN LOCATIONS ARE EXACT. CONFIRMATION OF EXISTENCE AND EXACT LOCATION OF ALL SERVICES MUST BE OBTAINED FROM THE INDIVIDUAL UTILITIES BEFORE PROCEEDING WITH CONSTRUCTION.

B.M. ELEV.	FIELD BOOK #:
POSTED TO LBS	
NO. REVISIONS	DATE BY

CITY OF WINNIPEG WATER AND WASTE ENGINEERING DIVISION

DESIGNED BY: SC
CHECKED BY: TW
DRAWN BY: CJH
APPROVED BY: KZ
HOR. SCALE: 1:250
VERTICAL SCALE: 1:50
DATE: 2005 06 09

ENGINEER'S SEAL
ORIGINAL SIGNED BY K.R. ZUREK 05/06/09

THE CITY OF WINNIPEG WATER AND WASTE DEPARTMENT

2005 WATERMAIN RENEWALS

ELLEN STREET WILLIAM AVENUE TO ELGIN AVENUE

SHEET 3 OF 16
CITY DRAWING NUMBER D-8724

BID OPPORTUNITY: 244-2005
FILENAME: D-8724_Ellen.dwg
PLOT DATE: 2005 06 09