

CHAINAGE ALONG CENTER OF ROW

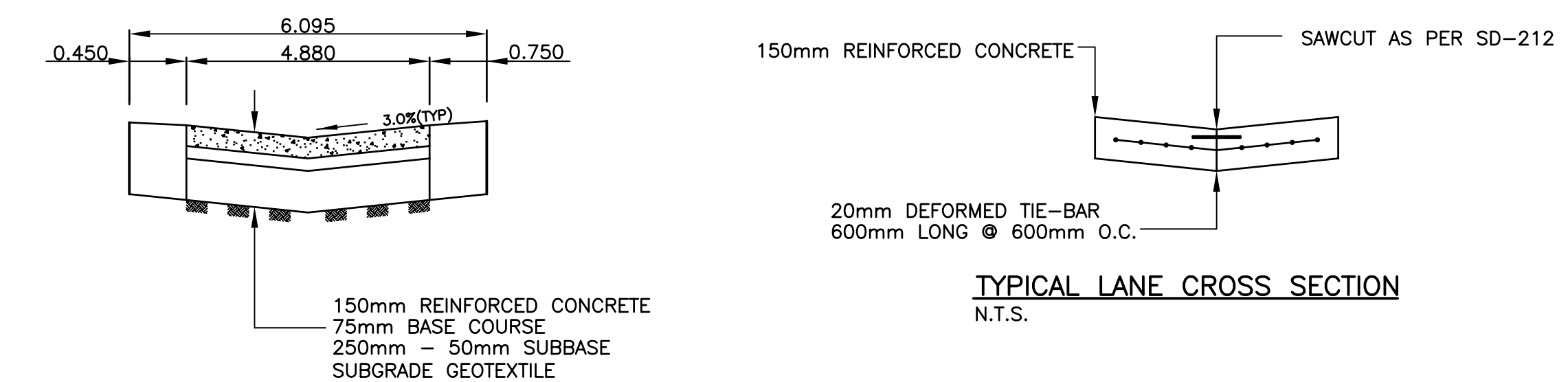
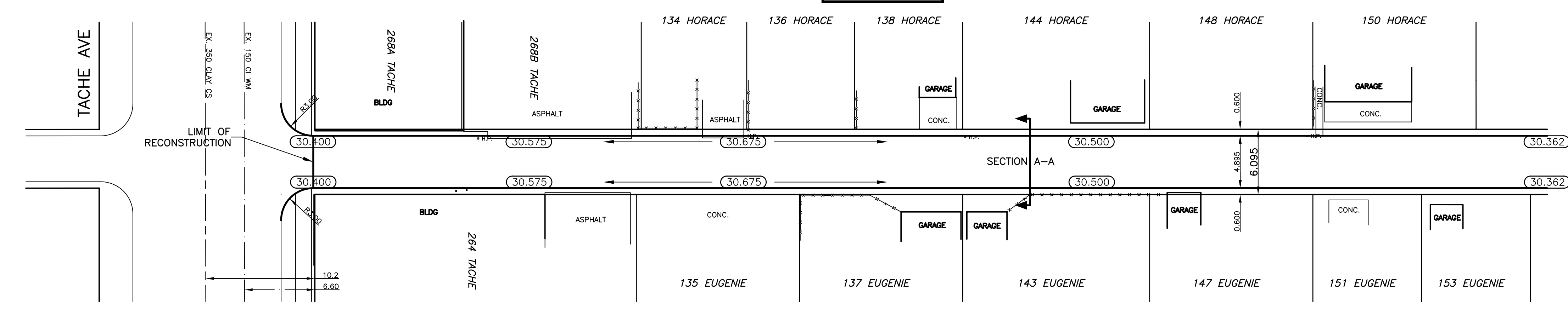

TYPICAL LANE CROSS SECTION N.T.S.

METRIC
WHOLE NUMBERS INDICATE MILLIMETRES
DECIMALIZED NUMBERS INDICATE METRES

- NOTES:**
- RENEW EXISTING APPROACH IF REQUIRED OR AS DIRECTED BY CONTRACT ADMINISTRATOR
 - MODIFIED BARRIER CURB TO BE USED FOR CURB RENEWAL AT RADI.

BENCHMARK:
D.B.M. IN CORONATION PARK E. OF ST MARY'S RD., 7 m S. OF PRODUCTION
OF N.L. OF WALTER ST. (N.CURB), 25 m E. OF E. CURB ON ST. MARY'S RD &
12 m E. OF 1ST LAMP STANDARD E. OF ST MARY'S RD., S. OF PATH



SECTION A-A		SECTION A-A		SECTION A-A		SECTION A-A		SECTION A-A	
EXISTING	LEGEND - PLAN	PROPOSED	EXISTING	LEGEND - PLAN	PROPOSED	EXISTING	LEGEND - PROFILE	PROPOSED	EXISTING
---	WATERMAIN	---	---	---	HYDRO	---	---	---	---
---	HYDRANT	---	---	---	M.T.S.	---	---	---	---
---	VALVE	---	---	---	CONCRETE	---	---	---	---
---	LAND DRAINAGE SEWER	---	---	---	ASPHALT	---	---	---	---
---	WASTE WATER SEWER	---	---	---	PROPERTY LINE	---	---	---	---
---	MANHOLE	---	---	---	SURVEY BAR	---	---	---	---
---	CATCH BASIN	---	---	---	CURB STOP	---	---	---	---
---	CURB INLET	---	---	---	C.B. LEAD	---	---	---	---
---	TRAFFIC SIGNAL	---	---	---	SIDEWALK	---	---	---	---
---	STEAM HT.	---	---	---	SIDEWALK RAMP	---	---	---	---
---	GAS	---	---	---	ELEVATIONS	---	---	---	---
---		---	---	---		---	---	---	---

LOCATION APPROVED UNDERGROUND STRUCTURES		
SUPV. U/G STRUCTURES COMMITTEE	DATE	

NOTE:
LOCATION OF UNDERGROUND STRUCTURES AS SHOWN ARE BASED ON THE BEST INFORMATION AVAILABLE BUT NO GUARANTEE IS GIVEN THAT ALL EXISTING UTILITIES ARE SHOWN OR THAT THE GIVEN LOCATIONS ARE EXACT. CONFIRMATION OF EXISTENCE AND EXACT LOCATION OF ALL SERVICES MUST BE OBTAINED FROM THE INDIVIDUAL UTILITIES BEFORE PROCEEDING WITH CONSTRUCTION.

B.M. ELEV.		CWM: 034-003	
		227.423 m	

SEG ENGINEERING INC.
200 TACHE AVENUE
WINNIPEG, MANITOBA
(204) 233-2113

DESIGNED BY: R.H./S.M. CHECKED BY: S.M.
DRAWN BY: R.H. APPROVED BY: E.P.R.

HOR. SCALE: 1:250
VERT. SCALE: 1:50

ORIG. SIGNED BY: _____
DATE: FEBRUARY 2005



THE CITY OF WINNIPEG
PUBLIC WORKS DEPARTMENT

2005 STREET RENEWALS AND LOCAL IMPROVEMENTS
HORACE/EUGENIE LANE
FROM TACHE AVE. TO STA. 2+15

CONSULTANT DRAWING NO. 063-039-05

CITY DRAWING NO.	
SHEET	1 OF 2
	184-2005

ACAD 2000