

TYPICAL CURB & GUTTER WITH SUB-DRAIN SECTION A N.T.S.

TYPICAL ROAD CROSS SECTION DETAIL B N.T.S.

INSTALL NEW 1800 CATCHBASIN COMPLETE WITH CURB AND GUTTER INLET AS PER SD-024 AND CONNECT TO EX. MANHOLE WITH 250mm PVC CONNECTING PIPE RIM 32.500 BOTTOM INV. 30.880

ABANDON EX. CATCHBASIN AND CURB INLET INSTALL NEW 1800 CATCHBASIN COMPLETE WITH CURB AND GUTTER INLET AS PER SD-024 AND CONNECT TO NEW LEAD WITH 250mm PVC CONNECTING PIPE RIM 32.500 BOTTOM INV. 30.880

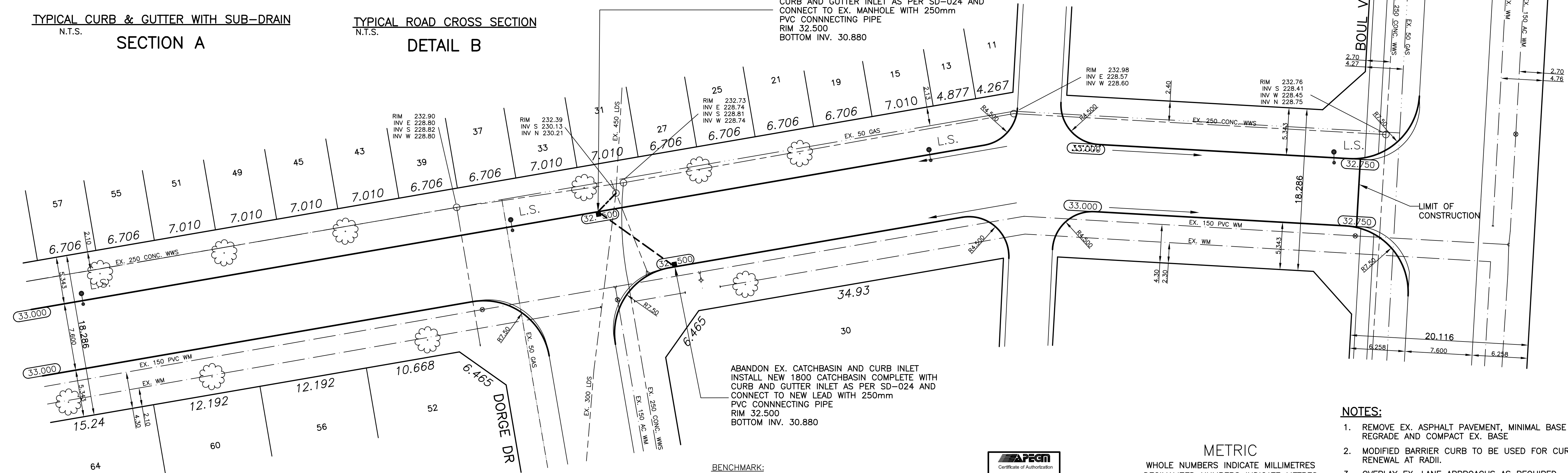

BENCHMARK: S.E. COR. GENDREAU AVE. & DORGE DR., TBLT. IN W. COR. FOUNDATION OF NO. 30 GENDREAU AVE., 3.5m S. & 0.2m BELOW STUCCO FROM N.W. COR. OF DWELLING.



METRIC WHOLE NUMBERS INDICATE MILLIMETRES DECIMALIZED NUMBERS INDICATE METRES

- NOTES:**
- REMOVE EX. ASPHALT PAVEMENT, MINIMAL BASE REPAIR, REGRADE AND COMPACT EX. BASE
 - MODIFIED BARRIER CURB TO BE USED FOR CURB RENEWAL AT RADIUS.
 - OVERLAY EX. LANE APPROACHES AS REQUIRED

EXISTING	LEGEND - PLAN	PROPOSED	EXISTING	LEGEND - PLAN	PROPOSED	EXISTING	LEGEND - PROFILE	PROPOSED
---	WATERMAIN	---	---	HYDRO	---	---	GROUND CENTER LINE	---
+	HYDRANT	+	+	M.T.S.	+	---	NORTH GUTTER LINE	---
o	VALVE	o	o	CONCRETE	o	---	SOUTH GUTTER LINE	---
---	LAND DRAINAGE SEWER	---	---	ASPHALT	---	---	WATERMAIN	---
---	WASTE WATER SEWER	---	---	PROPERTY LINE	---	---	VALVE	---
o	MANHOLE	o	o	SURVEY BAR	o	---	LAND DRAINAGE SEWER	---
□	CATCH BASIN	□	□	CURB STOP	□	---	WASTE WATER SEWER	---
△	CURB INLET	△	△	C.B. LEAD	△	---	JUNCTIONS	---
---	TRAFFIC SIGNAL	---	---	SIDEWALK	---	---	CULVERT	---
---	STEAM HT.	---	---	SIDEWALK RAMP	---	---		
---	GAS	---	---	ELEVATIONS	---	---		
---		---	---		---	---		

LOCATION APPROVED UNDERGROUND STRUCTURES

SUPV. U/G STRUCTURES DATE COMMITTEE

NOTE: LOCATION OF UNDERGROUND STRUCTURES AS SHOWN ARE BASED ON THE BEST INFORMATION AVAILABLE BUT NO GUARANTEE IS GIVEN THAT ALL EXISTING UTILITIES ARE SHOWN OR THAT THE GIVEN LOCATIONS ARE EXACT. CONFIRMATION OF EXISTENCE AND EXACT LOCATION OF ALL SERVICES MUST BE OBTAINED FROM THE INDIVIDUAL UTILITIES BEFORE PROCEEDING WITH CONSTRUCTION.

NO.	REVISIONS	DATE	BY

SEG ENGINEERING INC.
200 TACHE AVENUE
WINNIPEG, MANITOBA
(204) 233-2113

DESIGNED BY: S.M./R.H. CHECKED BY: S.M.
DRAWN BY: R.H. APPROVED BY: E.P.R.

HOR. SCALE: 1:250
VERT. SCALE: 1:50

ORIG. SIGNED BY: DATE: MARCH 2005



THE CITY OF WINNIPEG
PUBLIC WORKS DEPARTMENT

2005 RESIDENTIAL STREET RENEWAL AND LOCAL IMPROVEMENTS
AVE GENDREAU
FROM STA. 3+80 TO BOUL VILLENEUVE

CITY DRAWING NO.
SHEET 3 OF 3
184-2005