

D SIZE 22" x 34" (559mm x 864mm) PLOT: 05/05/26 10:38:07 AM UMA FILE NAME: D265-177-01_02-C-1012_RX.dwg Saved By: atleippi

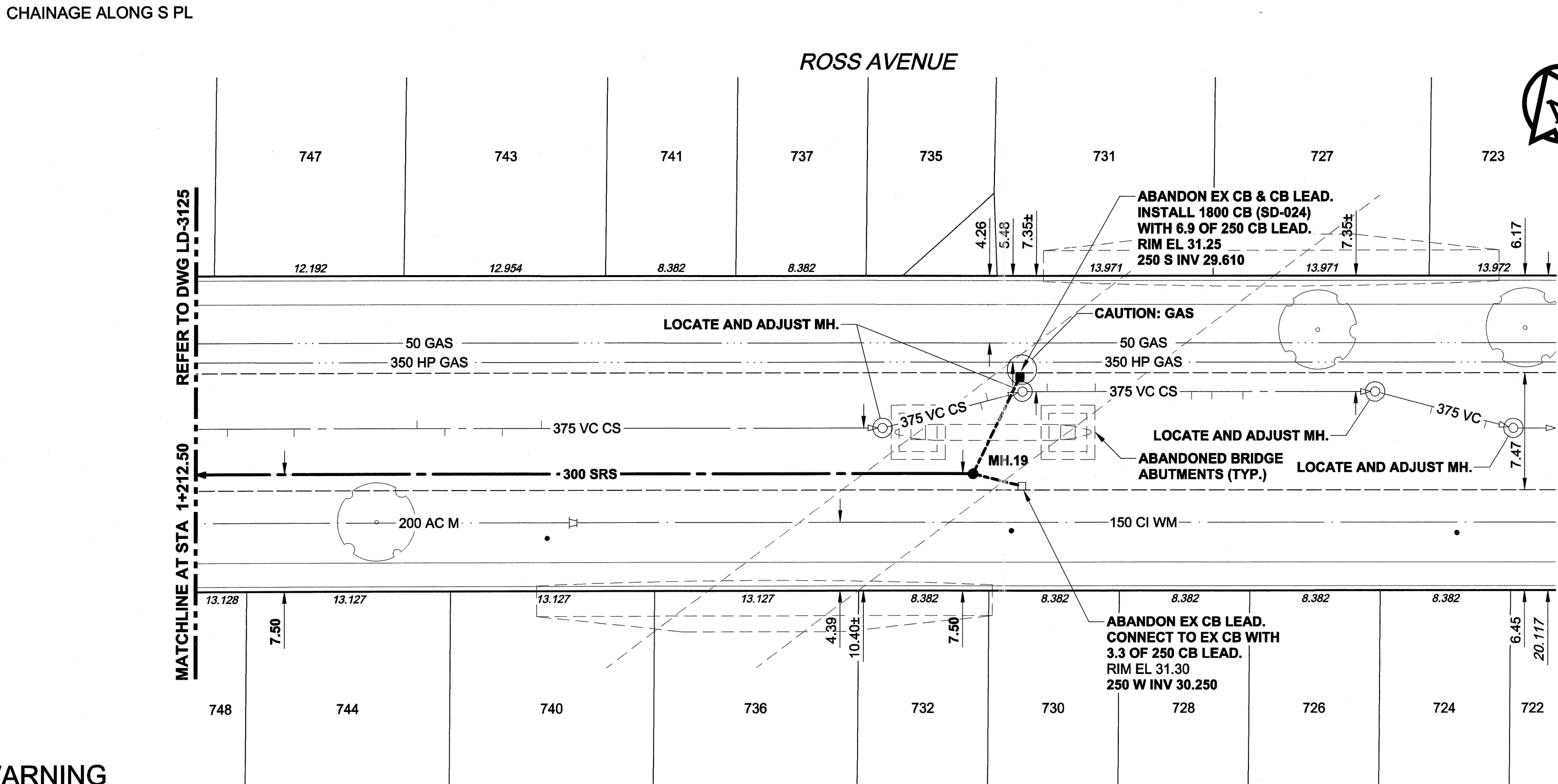
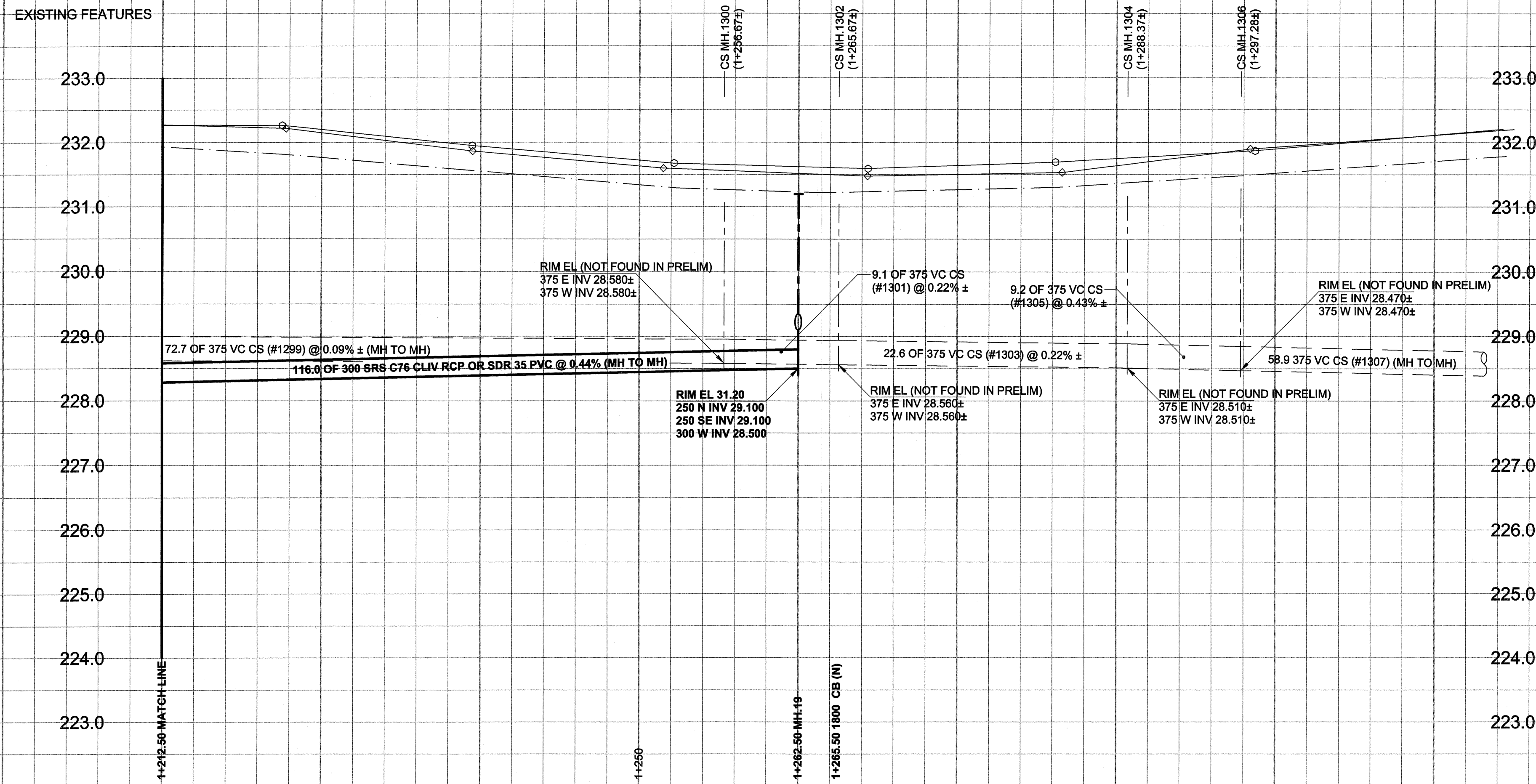

WARNING
 IF POWER EQUIPMENT OR EXPLOSIVES ARE TO BE USED FOR EXCAVATION ON THIS PROJECT, THE CONTRACTOR MUST:
 1) NOTIFY THE GAS COMPANY OF THE PROPOSED LOCATION OF EXCAVATION.
 2) TAKE PRECAUTION TO AVOID DAMAGE TO GAS COMPANY INSTALLATIONS.
 SEE PROVINCIAL REGULATION 140/92 FOR DETAILS

- CONSTRUCTION NOTES:**
- FOR DETAILED TEST HOLE INFORMATION, SEE SPECIFICATION.
 - THE LOCATION OF ALL SERVICES IS TO BE CONFIRMED IN THE FIELD.
 - INSTALL NEW SEWERS AND CATCHBASIN LEADS BY TRENCHLESS METHODS WHEREVER POSSIBLE.
 - RENEW/REHABILITATE CATCHBASINS & RENEW CATCHBASIN LEADS WHERE NOTED.

METRIC
 WHOLE NUMBERS INDICATE MILLIMETRES
 DECIMALIZED NUMBERS INDICATE METRES

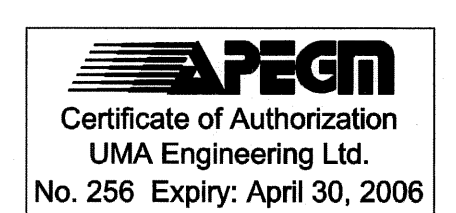

BID OPPORTUNITY NO. 137-2005

150 mm WM		150 mm WM		CURB STOP		150 mm WM		WATERMAIN		150 mm WM	
	HYDRANT		VALVE		REDUCER		HYDRANT		VALVE		HYDRANT
	COUPLING		ANODE		COUPLING		VALVE		COUPLING		VALVE
	LAND DRAINAGE SEWER		HYDRO		MTS		LAND DRAINAGE SEWER		HYDRO		LAND DRAINAGE SEWER
	WASTE WATER SEWER		MTS		WASTE WATER SEWER		PAVEMENT CROWN		NW PROPERTY LINE		NW PROPERTY LINE
	MANHOLE		GAS		NW PROPERTY LINE		S/E PROPERTY LINE		NW GUTTER		S/E GUTTER
	CATCH BASIN		TESTHOLE		NW GUTTER		S/E GUTTER		S/E GUTTER		S/E GUTTER
	CURB INLET		LAMP STANDARD		S/E GUTTER		S/E GUTTER		S/E GUTTER		S/E GUTTER
	CULVERT		TREE		S/E GUTTER		S/E GUTTER		S/E GUTTER		S/E GUTTER
	PIPE ABANDONMENTS										
	SURVEY BAR										
	EXISTING		LEGEND - PLAN		EXISTING		LEGEND - PLAN		EXISTING		LEGEND - PROFILE
	NEW		LEGEND - PROFILE		NEW		LEGEND - PROFILE		NEW		LEGEND - PROFILE

LOCATION APPROVED
 UNDERGROUND STRUCTURES

BM 36-009 Tilt. in W. wall of the City of Winnipeg Public Works Shop, S.E. Cor. of Pacific Ave. & Tecumseh St., 0.6m S. of N.W. Cor. of Bldg.
 ELEV 232.501m

NO. REVISIONS

DESIGNED BY	GEB/MM	CHECKED BY	
DRAWN BY	ADL	APPROVED BY	
HOR. SCALE	1:250	RELEASED FOR CONSTRUCTION	
VERT. SCALE	1:50	DATE	May 27, 2005
DATE	05/05/27		

2005 UMA ENGINEERING LTD. ALL RIGHTS RESERVED.

PROFESSIONAL'S SEAL
 PROVINCE OF MANITOBA
 May 26, 2005
 A. NAGY
 REGISTERED PROFESSIONAL ENGINEER

CONSULTANT DRAWING NO. 12
 D265-177-01-02

THE CITY OF WINNIPEG
 WATER AND WASTE DEPARTMENT

ALEXANDER/BANNATYNE
 COMBINED SEWER RELIEF
 CONTRACT 1B

ROSS AVENUE
 115m E OF TECUMSEH STREET
 TO 200m W OF SHERBROOK STREET

SHEET 12 OF 18
 CITY DRAWING NUMBER
 LD-3126
 REV 0