

P:\PROJECTS\2021\21-0107-006\DWG\MUN\21-0107-006_C-SIGNAGE\DWG01-17

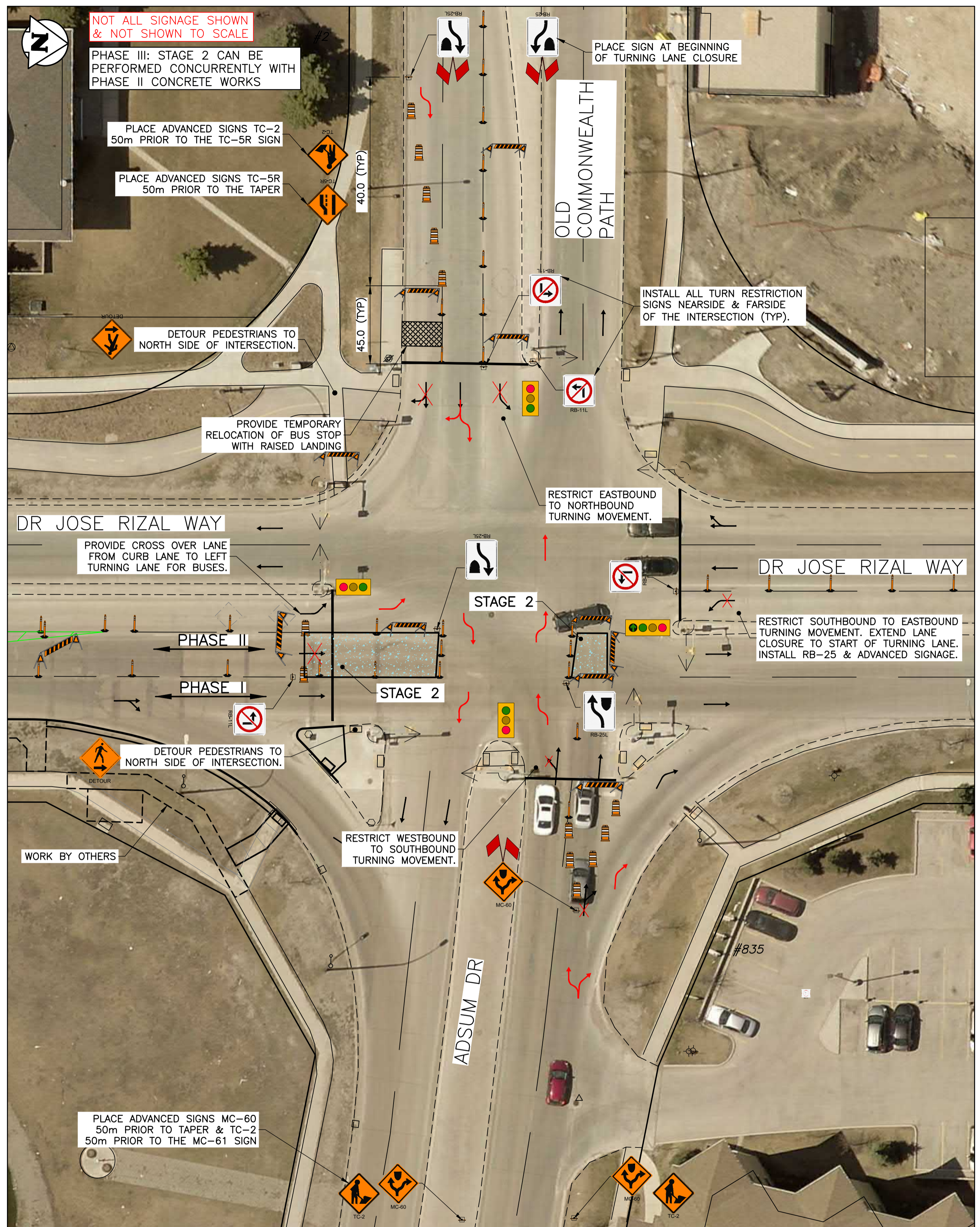

STAGING PLAN: PHASE IIIA – STAGE 2: MEDIAN THROUGH LANE
SCALE: 1:250

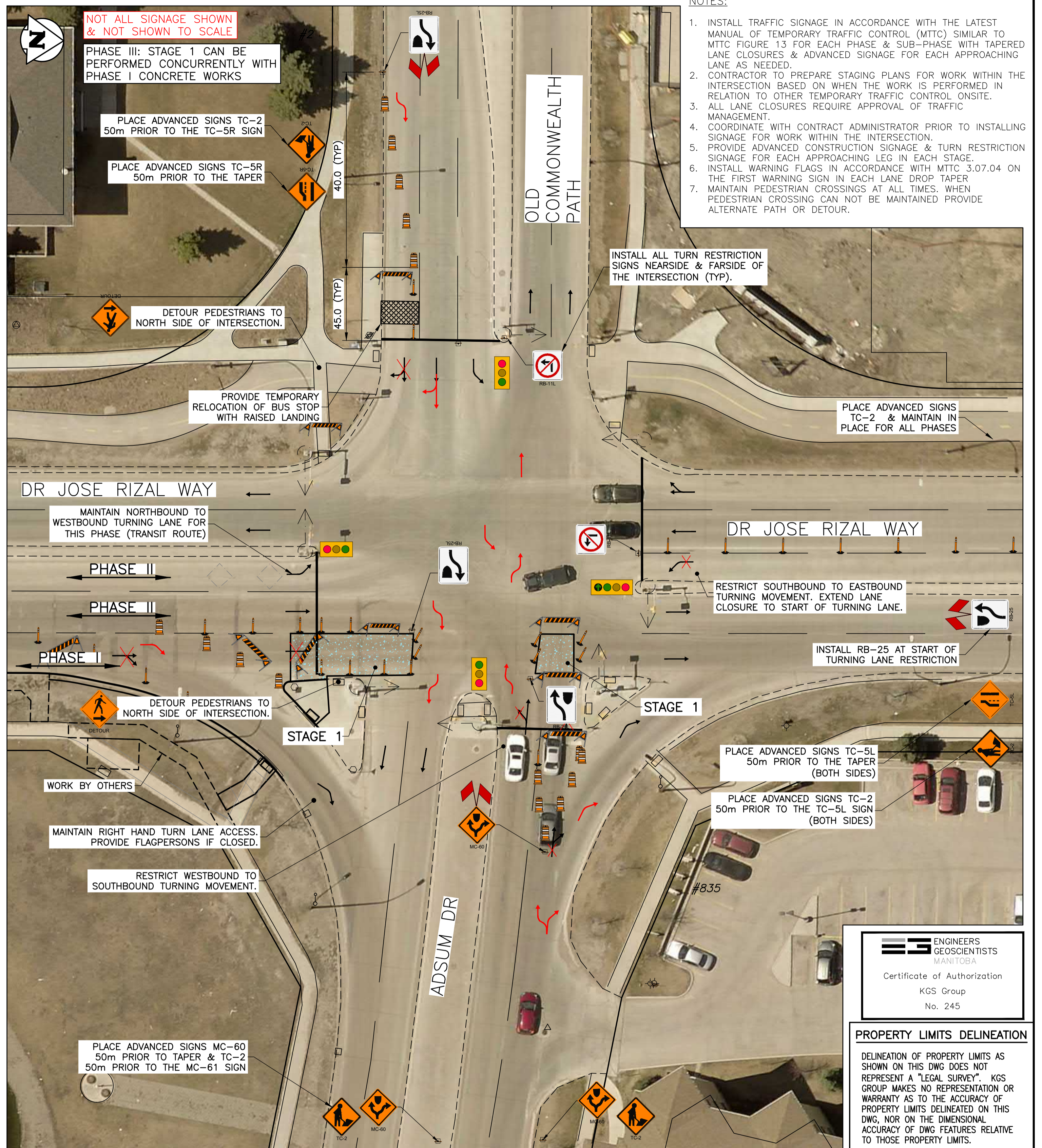

STAGING PLAN: PHASE IIIA – STAGE 1: CURB THROUGH LANE
SCALE: 1:250

- NOTES:**
1. INSTALL TRAFFIC SIGNAGE IN ACCORDANCE WITH THE LATEST MANUAL OF TEMPORARY TRAFFIC CONTROL (M TTC) SIMILAR TO M TTC FIGURE 13 FOR EACH PHASE & SUB-PHASE WITH TAPERED LANE CLOSURES & ADVANCED SIGNAGE FOR EACH APPROACHING LANE AS NEEDED.
 2. CONTRACTOR TO PREPARE STAGING PLANS FOR WORK WITHIN THE INTERSECTION BASED ON WHEN THE WORK IS PERFORMED IN RELATION TO OTHER TEMPORARY TRAFFIC CONTROL ONSITE.
 3. ALL LANE CLOSURES REQUIRE APPROVAL OF TRAFFIC MANAGEMENT.
 4. COORDINATE WITH CONTRACT ADMINISTRATOR PRIOR TO INSTALLING SIGNAGE FOR WORK WITHIN THE INTERSECTION.
 5. PROVIDE ADVANCED CONSTRUCTION SIGNAGE & TURN RESTRICTION SIGNAGE FOR EACH APPROACHING LEG IN EACH STAGE.
 6. INSTALL WARNING FLAGS IN ACCORDANCE WITH M TTC 3.07.04 ON THE FIRST WARNING SIGN IN EACH LANE DROP TAPER.
 7. MAINTAIN PEDESTRIAN CROSSINGS AT ALL TIMES. WHEN PEDESTRIAN CROSSING CAN NOT BE MAINTAINED PROVIDE ALTERNATE PATH OR DETOUR.

300_LDS	LAND DRAINAGE SEWER	300_LDS	TEST HOLE	TEMP. TRAFFIC FLOW
250_WWS	WASTE WATER SEWER	250_WWS	GUY WIRE	TEMP. TRAFFIC SIGN
---	GAS	---	DETECTABLE TILE	TRAFFIC SIGNAL
---	HYDRO	---	BACK OF CURB	LIGHT STANDARD
---	M.T.S.	---	ASPHALT MILL & FILL	LEGEND-PLAN
150_WM	WATERMAIN	150_WM	ASPHALT OVERLAY	PROPOSED
+	HYDRANT	+	CONCRETE	SIDEWALK
⊗	VALVE	⊗	PVMT. REPAIR FABRIC	NORTH OR WEST GUTTER
○	MANHOLE	○	LANDSCAPING	SOUTH OR EAST GUTTER
□	CATCH BASIN	□	PROPERTY LINE	Q. PROFILE
▽	CURB INLET	▽	GEODETIC BENCHMARK	NORTH OR WEST P
•	POLES	•	ELEVATION	SOUTH OR EAST P
EXISTING	LEGEND-PLAN	PROPOSED	EXISTING	LEGEND-PROFILE

LOCATION APPROVED UNDERGROUND STRUCTURES

SUPV. U/G STRUCTURES DATE COMMITTEE

NOTE:
LOCATION OF UNDERGROUND STRUCTURES AS SHOWN ARE BASED ON THE BEST INFORMATION AVAILABLE BUT NO GUARANTEE IS GIVEN THAT ALL EXISTING UTILITIES ARE SHOWN OR THAT THE GIVEN LOCATIONS ARE EXACT. CONFIRMATION OF EXISTENCE AND EXACT LOCATION OF ALL SERVICES MUST BE OBTAINED FROM THE INDIVIDUAL UTILITIES BEFORE PROCEEDING WITH CONSTRUCTION.

B.M.	KGS_BASE	COORDINATE SYSTEM:	CGV28
ELEV.	249.213		
NO.	REVISIONS	DATE	BY
0	ISSUED FOR TENDER	22/01/17	GES

		ENGINEER'S SEAL	
		DESIGNED BY: GES	CHECKED BY: GEL
DRAWN BY: GES		APPROVED BY: CR	
HOR. SCALE: 1:250		RELEASED FOR CONSTRUCTION:	
VERTICAL:		DATE: 2021-05-01	
CONSULTANT DRAWING NO. C505			

ISSUED FOR TENDER
NOT TO BE USED FOR CONSTRUCTION

METRIC
WHOLE NUMBERS INDICATE MILLIMETRES
DECIMALIZED NUMBERS INDICATE METRES

THE CITY OF WINNIPEG
PUBLIC WORKS DEPARTMENT
ENGINEERING DIVISION

PROJECT TITLE: KEEWATIN STREET NORTHBOUND REHABILITATION
INKSTER BOULEVARD TO ADSUM DRIVE

SIGNAGE PLAN PHASE IIIA

SHEET 21 OF 22
COMPUTER FILE NAME: 21-0107-006
CITY DRAWING NUMBER: P-3551-20