

CT-P-McPHILLIPS-SB-BL						
SEGMENT	STATION (START)	STATION (END)	NORTHING (START)	EASTING (START)	NORTHING (END)	EASTING (END)
L1	0+100.000	0+120.601	5530593.577	631338.307	5530614.159	631339.174
L2	0+120.601	0+284.356	5530614.159	631339.174	5530777.782	631345.746
C1	0+284.356	0+323.872	5530777.782	631345.746	5530817.186	631348.631
L3	0+323.872	0+347.985	5530817.186	631348.631	5530841.164	631351.182
C2	0+347.985	0+397.728	5530841.164	631351.182	5530890.758	631354.918
L4	0+397.728	0+583.774	5530890.758	631354.918	5531076.621	631363.169
C3	0+583.774	0+629.535	5531076.621	631363.169	5531122.370	631363.902
L5	0+629.535	0+656.195	5531122.370	631363.902	5531149.028	631363.573
C4	0+656.195	0+689.264	5531149.028	631363.573	5531182.089	631364.076
L6	0+689.264	0+778.938	5531182.089	631364.076	5531271.681	631367.911

CURVE DATA						
#	R.	Dc	Tc	L.	L.C.	
C1	600.000	3°46'25"	19.765	39.517	39.510	
C2	807.000	3°31'54"	24.879	49.743	49.735	
C3	807.000	3°14'56"	22.887	45.761	45.755	
C4	600.000	3°09'28"	16.539	33.069	33.065	

CT-P-McPHILLIPS-NB-BL						
SEGMENT	STATION (START)	STATION (END)	NORTHING (START)	EASTING (START)	NORTHING (END)	EASTING (END)
L7	0+100.000	0+130.507	5530593.400	631342.326	5530623.877	631343.668
L8	0+130.507	0+263.237	5530623.877	631343.668	5530756.501	631348.995
C5	0+263.237	0+305.983	5530756.501	631348.995	5530799.182	631351.319
L9	0+305.983	0+355.929	5530799.182	631351.319	5530849.009	631354.744
C6	0+355.929	0+392.341	5530849.009	631354.744	5530885.363	631356.801
L10	0+392.341	0+584.996	5530885.363	631356.801	5531077.828	631365.345
C7	0+584.996	0+612.243	5531077.828	631365.345	5531105.064	631366.090
L11	0+612.243	0+637.815	5531105.064	631366.090	5531130.635	631366.353
C8	0+637.815	0+664.017	5531130.635	631366.353	5531156.826	631367.049
L12	0+664.017	0+778.815	5531156.826	631367.049	5531271.519	631371.958

CURVE DATA						
#	R.	Dc	Tc	L.	L.C.	
C5	1500.000	1°37'58"	21.374	42.746	42.744	
C6	1500.000	1°23'27"	18.207	36.413	36.412	
C7	800.000	1°57'05"	13.625	27.247	27.246	
C8	807.000	1°51'37"	13.102	26.202	26.201	

CURB LEGEND

- BARRIER CURB (SD-203A OR SD-204) —
- MODIFIED BARRIER CURB (SD-203B) —
- SAFETY CURB OR MEDIAN (SD-206B OR SD-226B) —
- TRAFFIC BARRIER —
- SEPARATE SPLASH STRIP, MEDIAN SLAB OR SIDEWALK
- MONOLITHIC SPLASH STRIP, MEDIAN SLAB OR SIDEWALK
- STRUCTURAL SIDEWALK
- RETAINING WALL OR TRAFFIC BARRIER

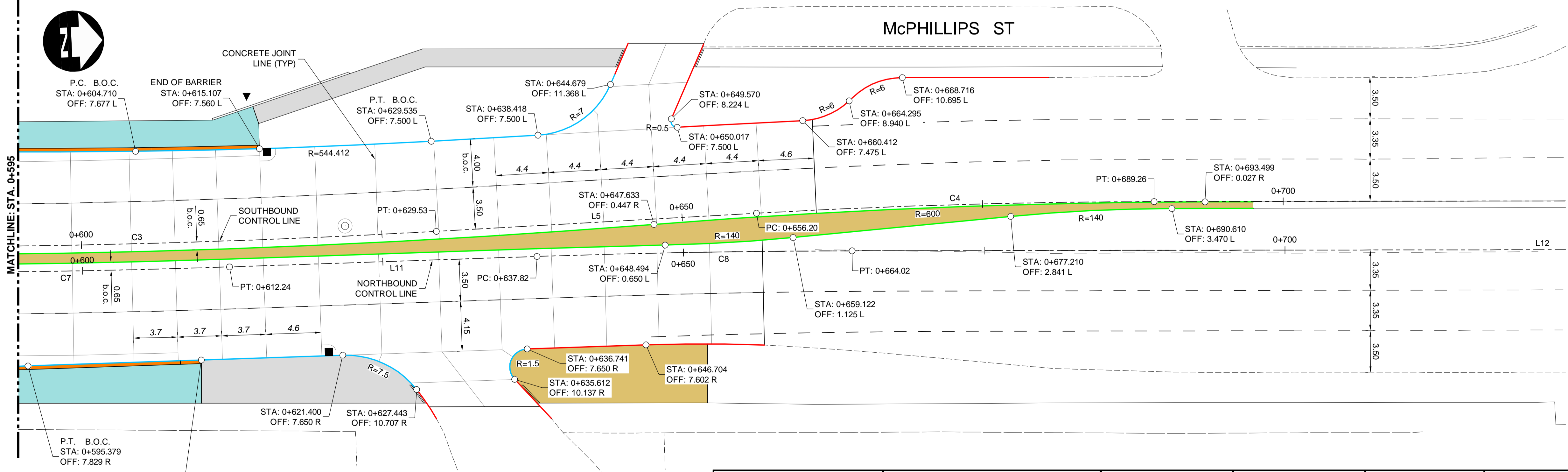

APEGM
 Certificate of Authorization
Dillon Consulting Limited (MB)
 No. 1789 Date: 18/03/16

UNDERGROUND STRUCTURES		B.M. ELEV.
SUPV. U/G STRUCTURES	DATE	

LOCATION OF UNDERGROUND STRUCTURES AS SHOWN ARE BASED ON THE BEST INFORMATION AVAILABLE, BUT NO GUARANTEE IS GIVEN THAT ALL EXISTING UTILITIES ARE SHOWN OR THAT THE GIVEN LOCATIONS ARE EXACT. CONFIRMATION OF EXISTENCE AND EXACT LOCATION OF ALL SERVICES MUST BE OBTAINED FROM THE INDIVIDUAL UTILITIES BEFORE PROCEEDING WITH CONSTRUCTION.

NO.	REVISIONS	DATE	BY
1	ISSUED FOR ADDENDUM 1	18/03/26	TJP
0	ISSUED FOR TENDER	18/03/16	TJP

DESIGNED BY	DRAWN BY	CHECKED BY	APPROVED BY	HOR. SCALE	VERTICAL
RTP	TJH	TS	TJP	1:200	—

DILLON CONSULTING

RELEASED FOR CONSTRUCTION

DATE

ENGINEER'S SEAL
 PROVINCE OF MANITOBA
 ORIGINAL SIGNED BY
T.J. PETERS
 18/03/16
 Member
 22309
 REGISTERED PROFESSIONAL ENGINEER

CONSULTANT PROJECT NUMBER
 17-6152

THE CITY OF WINNIPEG
 PUBLIC WORKS DEPARTMENT

2018 REGIONAL STREET RENEWAL PROJECT
 McPHILLIPS STREET RECONSTRUCTION AND UNDERPASS
 STRUCTURAL IMPROVEMENTS
 LOGAN AVENUE TO JARVIS AVENUE

CITY DRAWING NUMBER
 P-3492-2018-CT-002
 SHEET 002 OF 022
 CONSULTANT DRAWING NUMBER
 CT-002

G:\CAD\176152\Drawings\Roadworks\Contract\176152-CON-CT-GEOMETRY-JOINTS.dwg