

**CONSTRUCTION NOTES:**

- LEGAL PLAN AND UNDERGROUND INFORMATION FROM CITY OF WINNIPEG LBIS. CONTRACTOR TO VERIFY ALL UNDERGROUNDS IN THE FIELD.
- ISOLATE MISCELLANEOUS ITEMS IN NEW CONCRETE WORKS AS PER SD-228C.
- CONTRACTOR TO TAKE PRECAUTIONARY STEPS TO AVOID DAMAGE FROM CONSTRUCTION ACTIVITIES TO TREES WITHIN THE LIMIT OF CONSTRUCTION.
- CONTRACTOR TO TAKE PRECAUTIONARY STEPS TO CONTROL EROSION BY USING STRAW WATTLES, AS REQUIRED.
- LOCATION OF ALL EXISTING SERVICES TO BE CONFIRMED IN THE FIELD BY CONTRACTOR.
- CONTRACTOR SHALL CONFIRM EXISTING LEAD INVERT ELEVATIONS PRIOR TO INSTALLATION.
- ADJUST MH AND CB RIMS TO NEW GRADES.
- REFER TO LAND DRAINAGE DRAWINGS FOR ADDITIONAL UNDERGROUND INFORMATION REGARDING MANHOLES, CATCH BASINS, CULVERT ELEVATIONS, AND OUTLET DETAILS.
- REFER TO LANDSCAPE DRAWINGS FOR DETAILS ON ISLANDS, AND ADDITIONAL SURFACE WORK DETAILS.
- OPEN CUT TRENCH THROUGH PROPOSED PRIMARY DIKE TO BE BACKFILLED UNDER GUIDANCE OF A GEOTECHNICAL ENGINEER.
- NO VIBRATORY COMPACTION WITHIN 1 METRE OF THE PEDESTRIAN UNDERPASS ROOF SLAB. FOR PAVEMENT STRUCTURE DETAILS ABOVE ROOF SLAB, SEE SHEET CS-062.

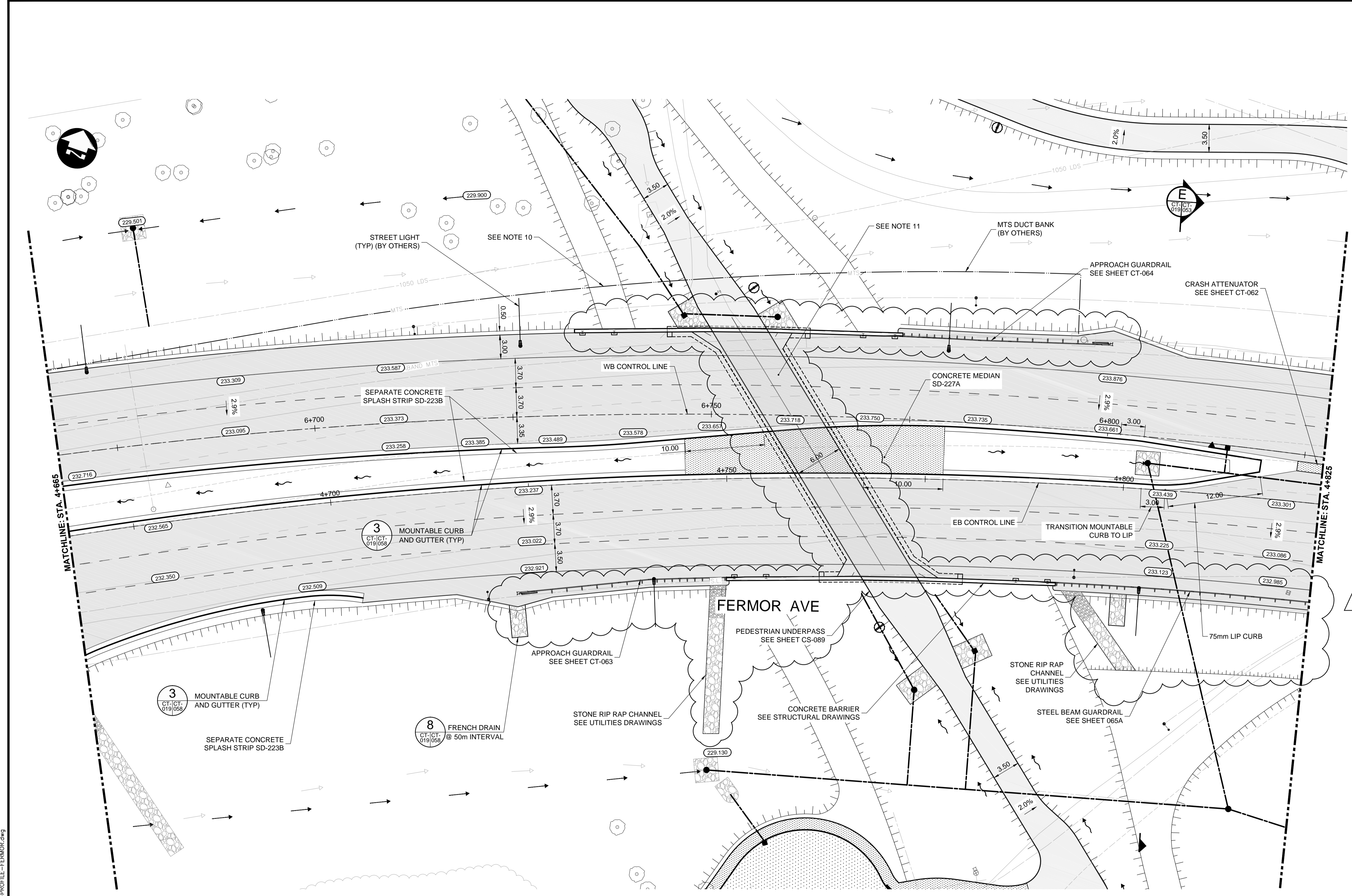

**METRIC**

WHOLE NUMBERS INDICATE MILLIMETRES  
DECIMALIZED NUMBERS INDICATE METRES

**WARNING**

IF POWER EQUIPMENT OR EXPLOSIVES ARE TO BE USED FOR EXCAVATION ON THIS PROJECT THE CONTRACTOR MUST:

- NOTIFY THE GAS COMPANY OF THE PROPOSED LOCATION OF EXCAVATION.
- TAKE PRECAUTION TO AVOID DAMAGE TO GAS COMPANY INSTALLATIONS SEE PROVINCIAL REGULATION 210/72 FOR DETAILS.
- OBTAIN EXCAVATION PERMITS PRIOR TO CONSTRUCTION.

**APEGM**  
Certificate of Authorization  
**Dillon Consulting Limited (MB)**  
No. 1789 Date: 18/02/09

G:\CAD\175932\Drawings\Roadworks\CON-CT-PLAN-PROFILE-FERMOR.dwg

150 WM	WATERMAIN	150 WM	CONCRETE	150 WM	WATERMAIN	150 WM
HYDRANT	ASPHALT	LAND DRAINAGE SEWER	300 LDS	WASTE WATER SEWER	300 LDS	300 LDS
VALVE	PLANING	HYDRANT	250 WWS	VALVE	250 WWS	250 WWS
MANHOLE	SIDEWALK	PROPERTY LINE	DRAINAGE ARROW	CURB RAMP (SD-229C)	DETECTABLE WARNING	SURFACE TILE (SD-229AA)
CATCH BASIN	PAVING STONES	DRAINAGE ARROW	DRAINAGE ARROW	CURB RAMP (SD-229C)	DETECTABLE WARNING	SURFACE TILE (SD-229AA)
CURB INLET	PARTIAL DEPTH REPAIR	DRAINAGE ARROW	DRAINAGE ARROW	CURB RAMP (SD-229C)	DETECTABLE WARNING	SURFACE TILE (SD-229AA)
300 LDS	LAND DRAINAGE SEWER	300 LDS	WASTE WATER SEWER	300 LDS	WASTE WATER SEWER	300 LDS
250 WWS	WASTE WATER SEWER	250 WWS	WASTE WATER SEWER	250 WWS	WASTE WATER SEWER	250 WWS
HYDRO	HYDRO	HYDRO	HYDRO	HYDRO	HYDRO	HYDRO
MTS	M.T.S.	MTS	M.T.S.	MTS	M.T.S.	MTS
100 GAS	GAS	100 GAS	GAS	100 GAS	GAS	100 GAS
EXISTING	LEGEND-PLAN	PROPOSED	EXISTING	LEGEND-PLAN	PROPOSED	EXISTING

**UNDERGROUND STRUCTURES**

SUPPLY, U/G STRUCTURES DATE

LOCATION OF UNDERGROUND STRUCTURES AS SHOWN ARE BASED ON THE BEST INFORMATION AVAILABLE BUT NO GUARANTEE IS GIVEN THAT ALL EXISTING UTILITIES ARE SHOWN OR THAT THE GIVEN LOCATIONS ARE EXACT. CONFIRMATION OF EXISTENCE AND EXACT LOCATION OF ALL SERVICES MUST BE OBTAINED FROM THE INDIVIDUAL UTILITIES BEFORE PROCEEDING WITH CONSTRUCTION.

B.M. ELEV. SEE SHEET CT-001 FOR CONTROL POINT INFORMATION

1	ADDENDUM #5	18/03/16	JNC
0	ISSUED FOR TENDER	18/02/09	JNC
NO.	REVISIONS	DATE	BY

DESIGNED BY JAT

DRAWN BY TJH

CHECKED BY JNC

APPROVED BY JNC

HOR. SCALE 1:250

VERTICAL 1:10

RELEASED FOR CONSTRUCTION

DATE

**DILLON CONSULTING**

ENGINEER'S SEAL  
PROVINCE OF MANITOBA  
REGISTERED PROFESSIONAL ENGINEER  
**J.N. CRANG**  
CONSULTANT PROJECT NUMBER  
17-5932

**THE CITY OF WINNIPEG**  
PUBLIC WORKS DEPARTMENT

**FERMOR AVENUE BRIDGE OVER SEINE RIVER**  
BRIDGE REHABILITATION, PEDESTRIAN-CYCLIST UNDERPASS STRUCTURE AND ROADWORKS FROM ST. ANNE'S ROAD TO ARCHIBALD STREET

CONSULTANT DRAWING NUMBER  
17-5932

FERMOR AVENUE - STA. 4+665 TO 4+825 (PLAN)

CITY DRAWING NUMBER  
P-3489-2017-CT-019  
SHEET 019 OF 067  
CONSULTANT DRAWING NUMBER  
CT-019