

NOTE: CHAINAGES SHOWN ARE ALONG E.P. OF PRINCESS STREET

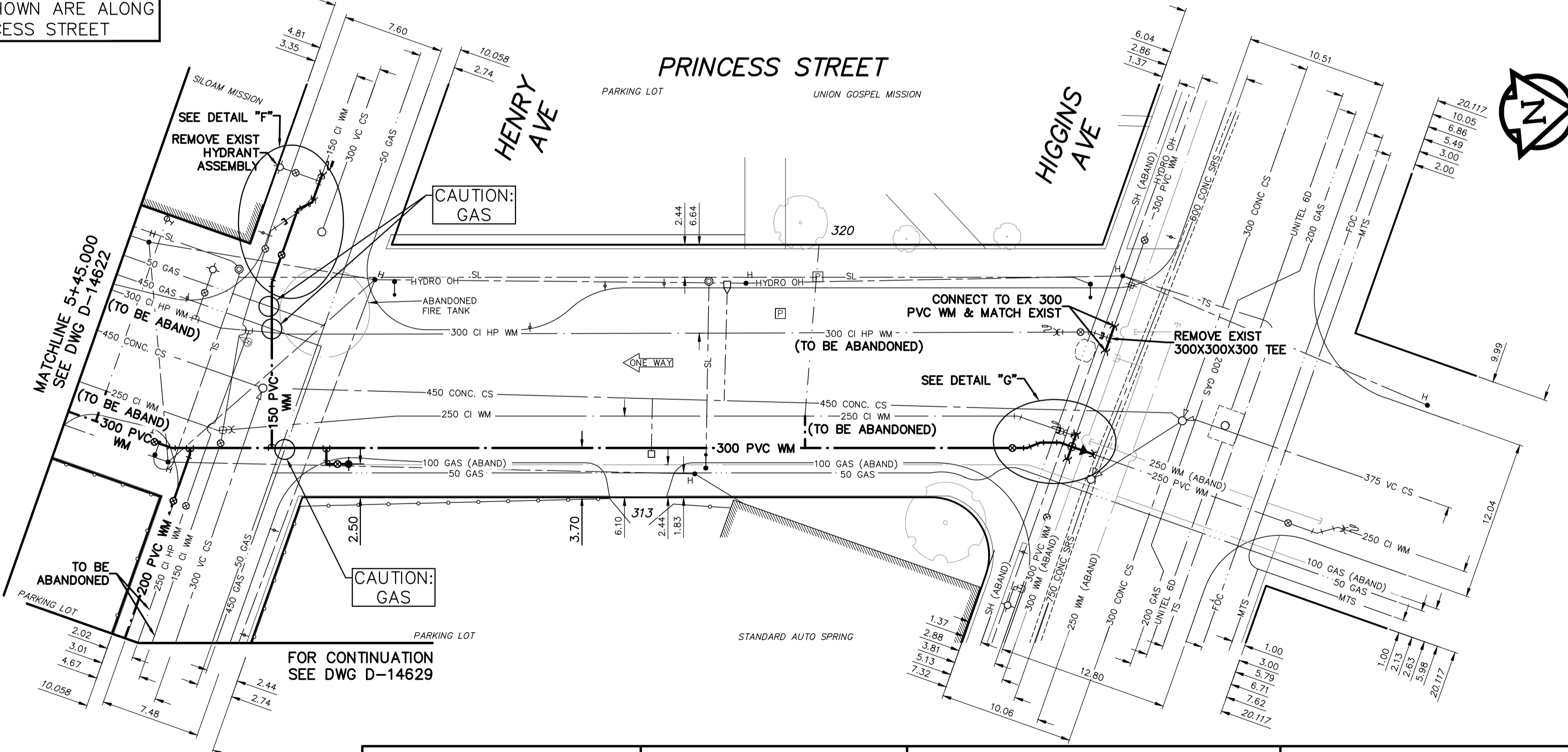

**WATER SERVICE INFORMATION**

ADDRESS	SIZE (mm) MATERIAL (STREET)	SIZE (mm) MATERIAL (PROP.)	SHORT & LONG MEASUREMENT	CORP. LOCATION	REMARKS
313 PRINCESS ST	25	25	18.1 EEL PRINCESS	OPP. S.C.	OUTSIDE RENEWAL LIMITS SERVICED OFF HIGGINS AVE
320 PRINCESS ST	50	50	20.9 SNL BLDG	11 S OF S.C.	RECONNECT SERVICE
340 PRINCESS ST	-	-	-	-	OUTSIDE RENEWAL LIMITS
341 PRINCESS ST	-	-	1.5 WEL BLDG	2.4 E OF S.C.	OUTSIDE RENEWAL LIMITS SERVICED OFF HIGGINS AVE

\* SERVICES TO BE RENEWED TO R.P. ALL OTHERS TO BE RECONNECTED

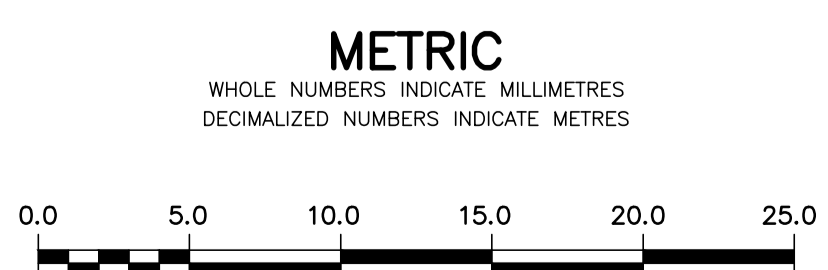

**WARNING**  
IF POWER EQUIPMENT OR EXPLOSIVES ARE TO BE USED FOR EXCAVATION ON THIS PROJECT THE CONTRACTOR MUST:  
1) NOTIFY THE GAS COMPANY OF THE PROPOSED LOCATION OF EXCAVATION.  
2) TAKE PRECAUTION TO AVOID DAMAGE TO GAS COMPANY INSTALLATIONS.  
SEE PROVINCIAL REGULATION 210/72 FOR DETAILS

**LOCATION APPROVED UNDERGROUND STRUCTURES**  
SUPV. U/G STRUCTURES COMMITTEE DATE  
NOTE:  
LOCATION OF UNDERGROUND STRUCTURES AS SHOWN ARE BASED ON THE BEST INFORMATION AVAILABLE BUT NO GUARANTEE IS GIVEN THAT ALL EXISTING UTILITIES ARE SHOWN OR THAT THE GIVEN LOCATIONS ARE EXACT. CONFIRMATION OF EXISTENCE AND EXACT LOCATION OF ALL SERVICES MUST BE OBTAINED FROM THE INDIVIDUAL UTILITIES BEFORE PROCEEDING WITH CONSTRUCTION.

B.M.	35-004	Tbit. in N. wall of City Administration Bldg., 0.6 m E. of W. entrance on James St.
ELEV.	232.156	
NO.	1	ISSUED FOR ADDENDUM 1
NO.		ADDED HYDRANT ASSEMBLY
NO.		REVISIONS

DESIGNED BY	JKH	CHECKED BY	HAK
DRAWN BY	DML	APPROVED BY	BWB
SCALE:	HORIZONTAL 1:250 VERTICAL 1:50		
DATE	2017 03 09	RELEASED FOR CONSTRUCTION	KAS ZUREK
DATE	2017 03 09	DATE	2017 04 20

**ENGINEERS**  
MORRISON HERSHFIELD  
No. 1736

ENGINEER'S SEAL  
ORIGINAL SIGNED BY H.A. KATZ  
2017 04 20

**THE CITY OF WINNIPEG**  
WATER AND WASTE DEPARTMENT  
ENGINEERING DIVISION  
2017 WATER MAIN RENEWALS  
CONTRACT 7  
**PRINCESS STREET**  
9 m S OF HENRY AVENUE TO HIGGINS AVENUE

SHEET 7 OF 14  
CITY DRAWING NUMBER  
**D-14623**

FOR INDEX SEE D-14618

NOTE: ALL VALVES TO BE INSTALLED COUNTERCLOCKWISE TO CLOSE