

LOCATION PLAN
1" = 3000'

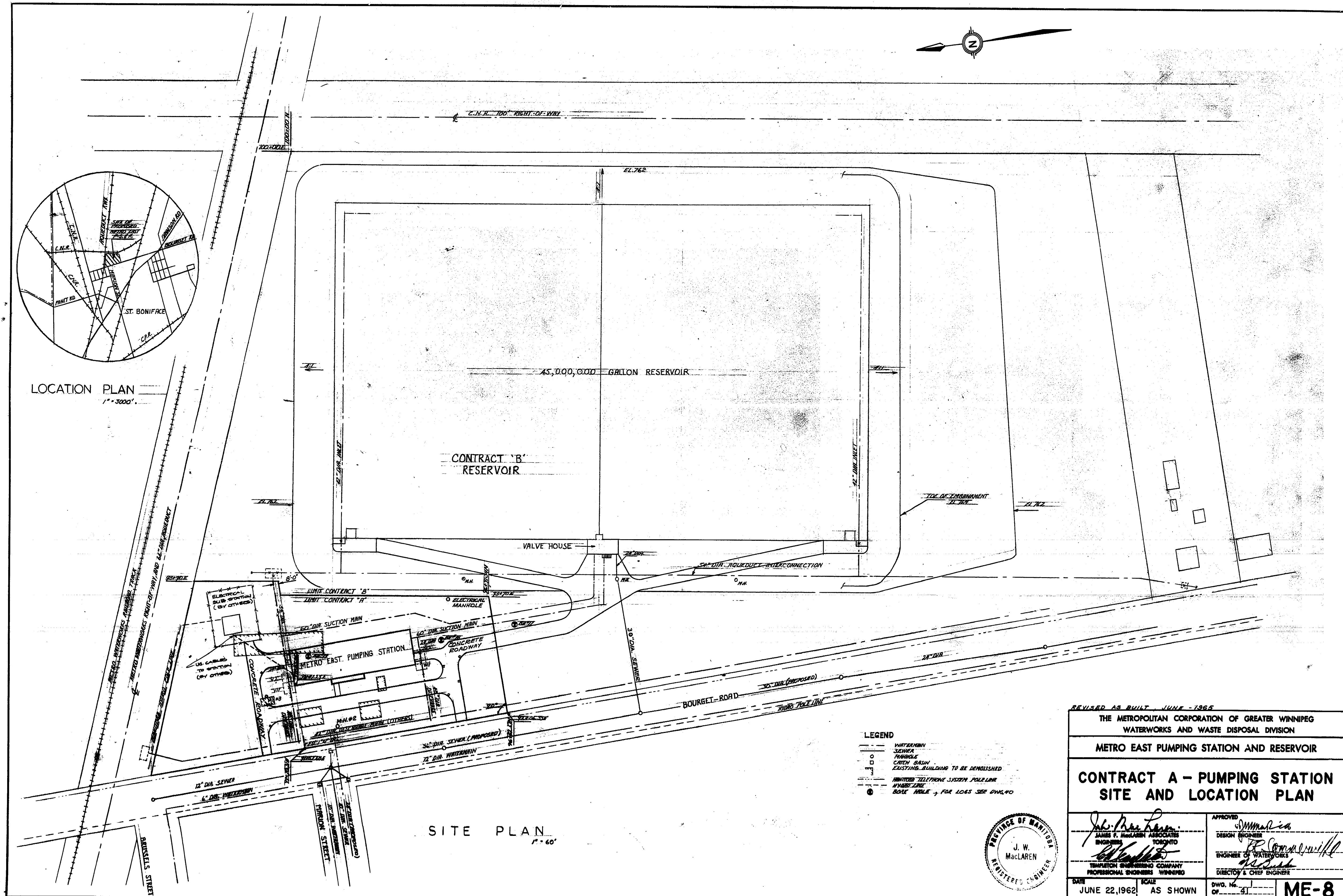

SITE PLAN
1" = 60'

LEGEND

- WATERMAIN
- SEWER
- MANHOLE
- CATCH BASIN
- EXISTING BUILDING TO BE DEMOLISHED
- LIMITED TELEPHONE SYSTEM POLARON
- HYDRO LINE
- BORE HOLE - FOR LOGS SEE DWG. 40



REVISED AS BUILT - JUNE - 1965	
THE METROPOLITAN CORPORATION OF GREATER WINNIPEG WATERWORKS AND WASTE DISPOSAL DIVISION	
METRO EAST PUMPING STATION AND RESERVOIR	
CONTRACT A - PUMPING STATION SITE AND LOCATION PLAN	
Approved <i>J. W. MacLaren</i> J. W. MacLaren ENGINEER TORONTO	Approved <i>R. Campbell</i> R. Campbell ENGINEER OF WATERWORKS DIRECTOR & CHIEF ENGINEER
DATE JUNE 22, 1962	SCALE AS SHOWN
DWG. No. OF 31	ME-8