

KEY PLAN
1:500

- CONSTRUCTION NOTES:**
1. RESTORE ALL DISTURBED GRASS AREAS WITH IMPORTED TOP SOIL AND SOD IN ACCORDANCE WITH CW 3510.
 2. LEAVE SLUICE GATE IN FULL OPEN POSITION AT ALL TIMES EXCEPT WHEN ON-SITE WORKING ON GATE.
 3. PROVIDE TEMPORARY PUMPING OF FLOW IN LDS AS REQUIRED DURING CONSTRUCTION.
 4. PREVENT EXCAVATED MATERIAL, BACKFILL MATERIAL AND SOIL / WATER SLURRY FROM ENTERING LDS OUTFALL TO THE RIVER.
 5. DO NOT REMOVE EXISTING TREES UNLESS NOTED OTHERWISE. PROVIDE TREE PROTECTION IN ACCORDANCE WITH SPECIFICATIONS.
 6. CONFIRM LOCATION AND ELEVATION OF EXISTING LDS BEFORE CONSTRUCTION COMMENCES.

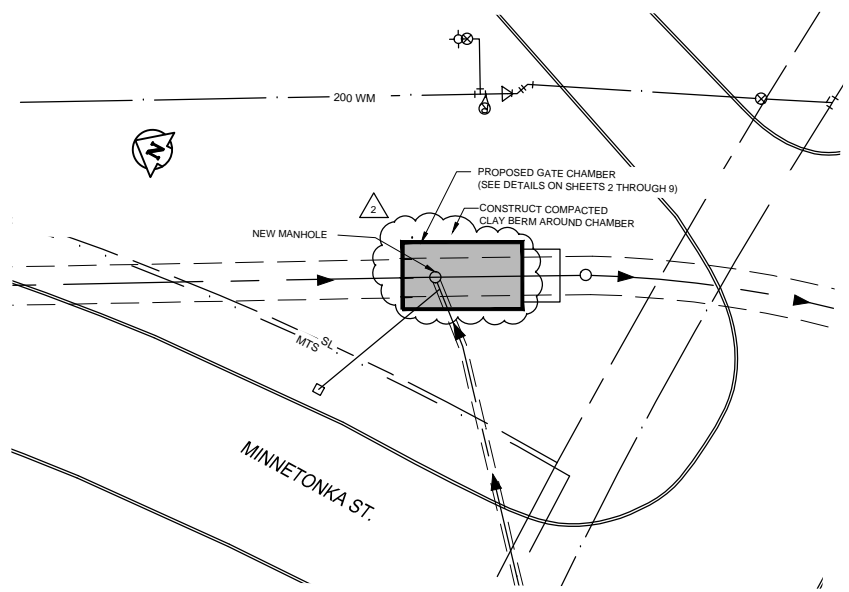

LDS OUTFALL GATE CHAMBER ADDITION
1:200

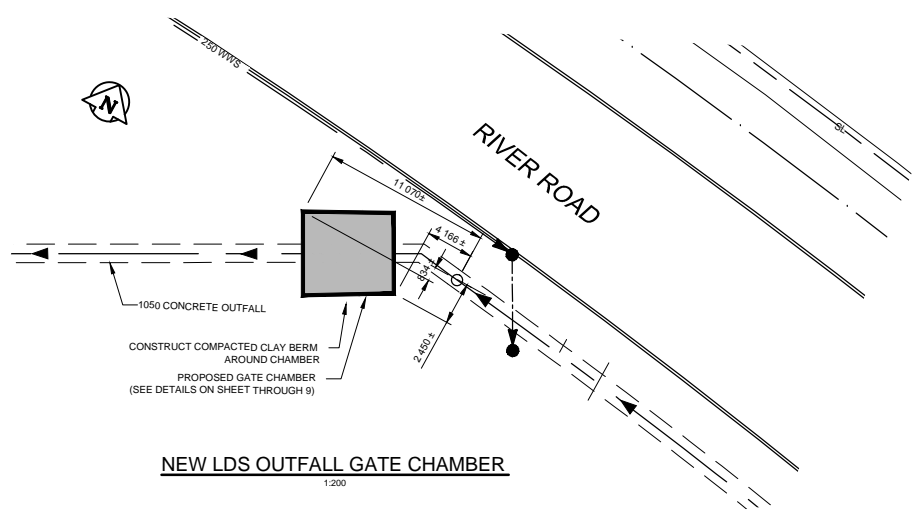

NEW LDS OUTFALL GATE CHAMBER
1:200

APEGN
Certificate of Authorization
MMM Group Limited
No. 4531 Date: 11.11.29

SCALE LEGEND:
0.0 1.0 2.0 3.0m
0.0 1.0 2.0 3.0m
0.0 5.0 10.0 15.0m
1:200

last saved November 29, 2011, 11:23 AM by BEHARADINIK
 2501 150 150 1199201125 Minnetonka Gate Chambers Construction/1125 minnetonka gate chambers_sds plan_111128.dwg

NOTE:
These design documents are prepared solely for the use by the party with whom the design professional has entered into a contract and there are no representations of any kind made by the design professional to any party with whom the design professional has not entered into a contract.

A = DETAIL/SECTION No.
B = DRAWING WHERE SHOWN
C = DRAWING WHERE TAKEN

METRIC
WHOLE NUMBERS INDICATE MILLIMETRES
DECIMALIZED NUMBERS INDICATE METRES

No.	REVISIONS	DATE	BY	DATE
2	ISSUED FOR ADDENDUM 1	11.11.29	DM	
1	REVISIONS	11.11.18	DM	

MMM GROUP
MMM Group Limited
Suite 111 - 93 Lombard Ave.
Winnipeg, MB R3B 3B1
T. 204.943.3178 / F. 204.943.4948
www.mmm.ca

DESIGNED BY: MM	CHECKED BY: DM/CDP
DRAWN BY: KDB	APPROVED BY: DM
HOR. SCALE: 1:200	RELEASED FOR CONSTRUCTION: 2011.11.29
VERT. SCALE: 1:40	

ENGINEER'S SEAL
PROVINCE OF MANITOBA
Muhammad D. Muhrdarevic
Member 31027
REGISTERED PROFESSIONAL ENGINEER
BID OPPORTUNITY: 938-2011
PLOT DATE: 2011.11.29

THE CITY OF WINNIPEG
WASTE AND WATER DEPARTMENT
Winnipeg

OUTFALL GATE CHAMBERS CONSTRUCTION & UPGRADES
MINNETONKA STREET & RIVER ROAD

CONSULTANT DRAWING No.: 5511125-1
SHEET 1 OF 10
CITY DRAWING No.: LD-5707

SITE PLAN