

PLAN

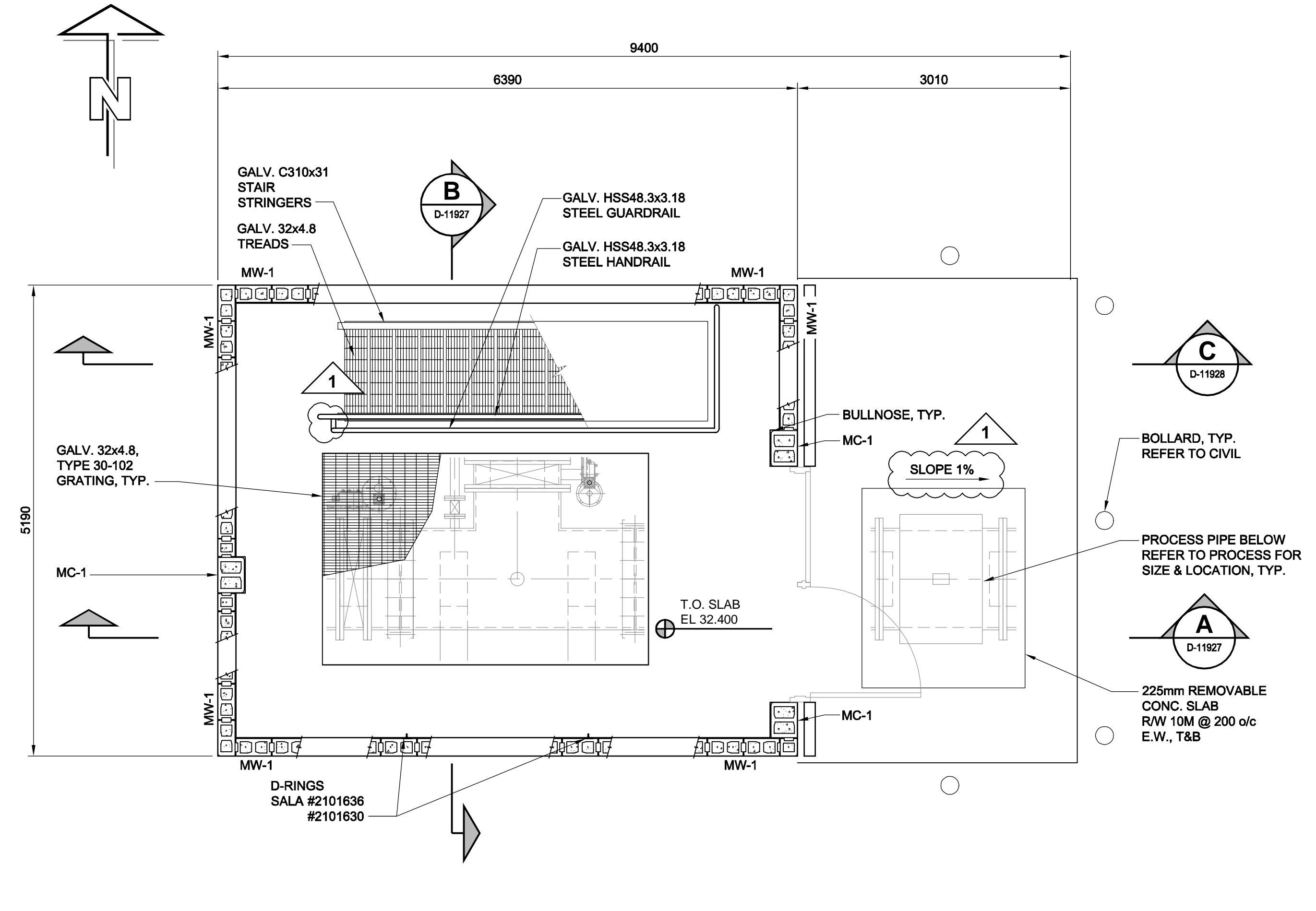

PLAN

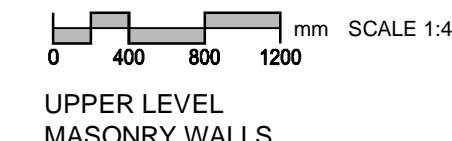

| MASONRY WALL SCHEDULE | | | | |
|-----------------------|------|---------------|--------|-----------------------|
| MARK | SIZE | REINFORCING | TYPE | REMARKS |
| MW-1 | 190 | 15M @ 600 o/c | NORMAL | FULLY GROUT ALL CORES |

- NOTES:
- DOWEL TO CONCRETE SUPERSTRUCTURE c/w LAP LENGTH = 1000mm
 - LAP LENGTH WITHIN WALL = 1000mm
 - PROVIDE JOINT REINFORCING EVERY SECOND COURSE.

| MASONRY COLUMN SCHEDULE | | | | | |
|-------------------------|---------|--------|-------------------------|----------|---------------------|
| MARK | SIZE | TYPE | REINFORCING BAR DETAILS | | REMARKS |
| | | | VERTICALS | TIES | |
| MC-1 | 390x290 | NORMAL | 4-20 M (2ea CORE) | 6M @ 200 | FULLY GROUTED CORES |

- NOTES:
- DOWEL TO CONCRETE SUPERSTRUCTURE c/w LAP LENGTH = 1000mm
 - LAP LENGTH WITHIN COLUMN = 1000mm

| CONCRETE SLAB SCHEDULE | | | | | |
|------------------------|-------|-------------------------|--------------------|-------|------------------------|
| MARK | DEPTH | REINFORCING BAR DETAILS | | | REMARKS |
| | | TOP | BOTTOM | ADD'L | |
| CS-1 | 500 | 25M @ 300 o/c E.W. | 25M @ 300 o/c E.W. | | |
| CS-2 | 300 | 20M @ 300 o/c E.W. | 20M @ 300 o/c E.W. | | |
| CS-3 | 150 | | 15M @ 300 o/c E.W. | | c/w PENETRATING SEALER |

| CONCRETE WALL SCHEDULE | | | | | |
|------------------------|-------|-------------------------|--------------------|--------------------|---|
| MARK | DEPTH | REINFORCING BAR DETAILS | | | REMARKS |
| | | VERTICAL | HORIZONTAL | ADD'L | |
| CW-1 | 400 | 20M @ 300 o/c E.W. | 20M @ 300 o/c E.W. | 20M @ 300 o/c E.W. | ADDITIONAL REINFORCING AS NOTED ON DRAWINGS |

| CONCRETE BEAM SCHEDULE | | | | | | |
|------------------------|-------|-------|-------------------------|-------|-------|---------------|
| MARK | WIDTH | DEPTH | REINFORCING BAR DETAILS | | | REMARKS |
| | | | TOP | MID. | BOT. | |
| CB-1 | 400 | 600 | 4-20M | 1-10M | 4-20M | 10M @ 250 o/c |

| DESIGN LOADS (UNFACTORED) | | |
|---------------------------|--|--------------------------|
| DEAD LOADS | STRUCTURE SELF WEIGHT PLUS PROCESS PIPES AND VALVES, AND STEEL PLATFORMS | |
| | LOWER LEVEL BASE SLAB | 9.6 kPa |
| LIVE LOADS | PLATFORMS & GRATING | 9.6 kPa |
| | STAIRCASE | 4.8 kPa |
| | UPPER LEVEL FLOOR SLAB | 9.6 kPa |
| | PIPE THRUST FORCE ON WEST WALL | 370 kN |
| EARTH LOAD | PIPE THRUST FORCE ON SOUTH WALL | 270 kN |
| | Ko | 0.6 |
| | SOIL UNIT WEIGHT | 20 kN/m ² |
| SNOW LOAD | HEIGHT OF SOIL | 4.4m |
| | BASED ON NBC OF CANADA 2005, POST-DISASTER IMPORTANCE CATEGORY, Is=1.25 | Ss=1.9 kPa Sr=0.2 kPa |
| WIND LOAD | BASED ON NBC OF CANADA 2005, POST-DISASTER IMPORTANCE CATEGORY, Iw=1.25 | q(1/50) =0.45 kPa |

BID OPPORTUNITY NO. 16-2010

LOCATION APPROVED UNDERGROUND STRUCTURES

| SUPR. U/G STRUCTURES | DATE | COMMITTEE |
|----------------------|------|-----------|
| | | |

NOTE: LOCATION OF UNDERGROUND STRUCTURES AS SHOWN ARE BASED ON THE BEST INFORMATION AVAILABLE. BUT NO GUARANTEE IS GIVEN THAT ALL EXISTING UTILITIES ARE SHOWN OR THAT THE GIVEN LOCATIONS ARE EXACT. CONFIRMATION OF EXISTENCE AND EXACT LOCATION OF ALL SERVICES MUST BE OBTAINED FROM THE INDIVIDUAL UTILITIES BEFORE PROCEEDING WITH CONSTRUCTION.

| NO. | REVISIONS | YYMMDD | BY |
|-----|-------------------------|----------|----|
| 1 | ISSUED FOR ADDENDUM 1 | 10/02/08 | KK |
| 0 | ISSUED FOR CONSTRUCTION | 10/02/08 | KK |

| | | | |
|--------------|--------|--|-------------|
| AECOM | | This drawing has been prepared for the use of AECOM's client and may not be used, reproduced or relied upon by third parties, except as agreed by AECOM and its client, as required by law or for use by governmental reviewing agencies. AECOM accepts no responsibility, and denies any liability whatsoever, to any party that modifies this drawing without AECOM's express written consent. Do not scale this document. All measurements must be obtained from stated dimensions. | |
| DESIGNED BY | KK/GGP | CHECKED BY | GGP |
| DRAWN BY | KK | APPROVED BY | Bryan Weber |
| HOR. SCALE | 1:40 | RELEASED FOR CONSTRUCTION | KZ |
| VERT. SCALE | - | DATE | FEB. 9/10 |

| | |
|------------------------|------------------------------|
| PROFESSIONAL'S SEAL | |
| ORIGINAL SIGNED BY | B.F. ABDUL WAHID |
| | 2010/02/08 |
| CONSULTANT DRAWING NO. | D265-250-00_01-S-1002_RX.dwg |

THE CITY OF WINNIPEG
WATER AND WASTE DEPARTMENT

BRANCH I AQUEDUCT VALVE CHAMBER
AT McPHILLIPS STREET
PUMPING STATION

STRUCTURAL
UPPER LEVEL SLABS, CURBS, & UPPER LEVEL WALLS

SHEET 14 OF 28
CITY DRAWING NUMBER
D-11924 REV 1