

SECOND FLOOR PLAN
1:100

- NOTES:**
1. WALLS AND PARTITIONS SHOWN ON THIS DRAWING INDICATE GENERAL WALL LOCATIONS. CONFIRM AND VERIFY EXACT WALL LOCATIONS AS SHOWN ON THE ARCHITECTURAL DRAWINGS.
 2. ALL CURBS AND DOWELS FOR CMU WALLS ARE IN THE SCOPE OF BO 583-2005.
 3. FOR WALL CONTROL JOINTS SEE ARCHITECTURAL DRAWINGS.
 4. SEE DETAIL 2 FOR OPENING REINFORCING.
 5. FOR CMU OPENINGS SEE ARCHITECTURAL, MECHANICAL AND ELECTRICAL DRAWINGS.
 6. USE NO.9 ASWG@400 JOINT REINFORCEMENT.
 7. FOR STAIRS AND HANDRAILS TO PLATFORMS AT ALL LEVELS SEE ARCHITECTURAL DRAWINGS.
 8. COORDINATE ALL FABRICATION WITH BO 742-2005 CONTRACTOR.

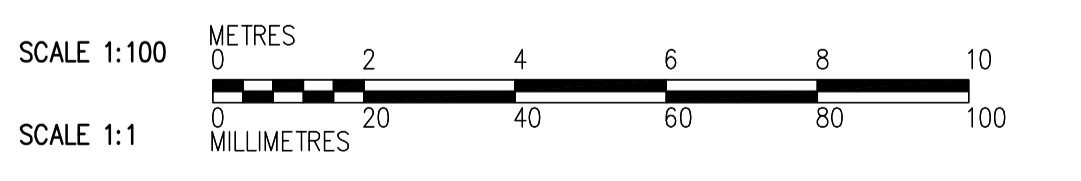
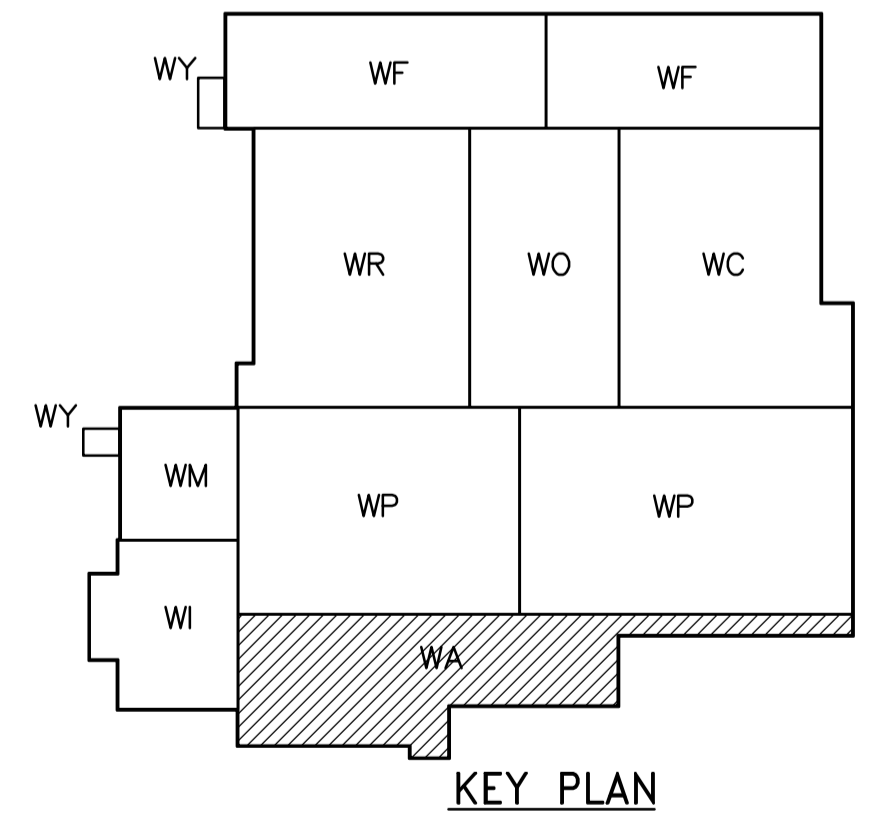

<p>Certificate of Authorization CH2M HILL Canada Ltd. No. 1441 Expiry: April 30, 2008</p>	<p>Frederickson Cooper ARCHITECTS</p>	<p>A Tyco International Ltd. Company</p>		<p>DESIGNED BY: MH CHECKED BY: AP</p>		<p>CONSULTANT DRAWING NO. WA-S4121</p>	<p>THE CITY OF WINNIPEG WATER AND WASTE DEPARTMENT ENGINEERING DIVISION</p>	<p>WATER TREATMENT PLANT ADMINISTRATION OFFICE AND PLANT INTERIOR FINISHES</p>	CITY FILE NUMBER
				<p>DRAWN BY: CR APPROVED BY:</p>					SHEET OF
<p>SCALE: 1:100</p>		<p>RELEASED FOR CONSTRUCTION BY:</p>		<p>DATE: 2007/06/12 DATE:</p>		<p>STRUCTURAL ADMINISTRATION AREA SECOND FLOOR PLAN</p>		CITY DRAWING NUMBER	
<p>01 ADDENDUM 1 07/06/12 MH</p>		<p>00 ISSUED FOR TENDER 07/06/05 MH</p>		<p>NO. REVISIONS DATE BY</p>		<p>1-0601A-A-S4121-001-000</p>			