

**GENERAL NOTES:**  
 A. BASE LINE IS CENTERLINE OF 750 SUPERNATANT LINE  
 B. LOCATION OF UNDERGROUND STRUCTURES AS SHOWN ARE BASED ON THE BEST INFORMATION AVAILABLE. BUT NO GUARANTEE IS GIVEN THAT ALL EXISTING UTILITIES ARE SHOWN OR THAT THE GIVEN LOCATIONS ARE EXACT. CONFIRMATION OF EXISTENCE AND EXACT LOCATION OF ALL SERVICES MUST BE OBTAINED FROM THE INDIVIDUAL UTILITIES BEFORE PROCEEDING WITH CONSTRUCTION.

**BENCHMARK NOTES:**  
 DRAWING COORDINATES ARE UTM NAD83 - SCALE FACTOR 0.99983

B.M. No.	NORTHING	EASTING	ELEVATION
PILE 136	5523873.734	647764.406	236.242
PILE 133	5523256.606	647782.387	236.056

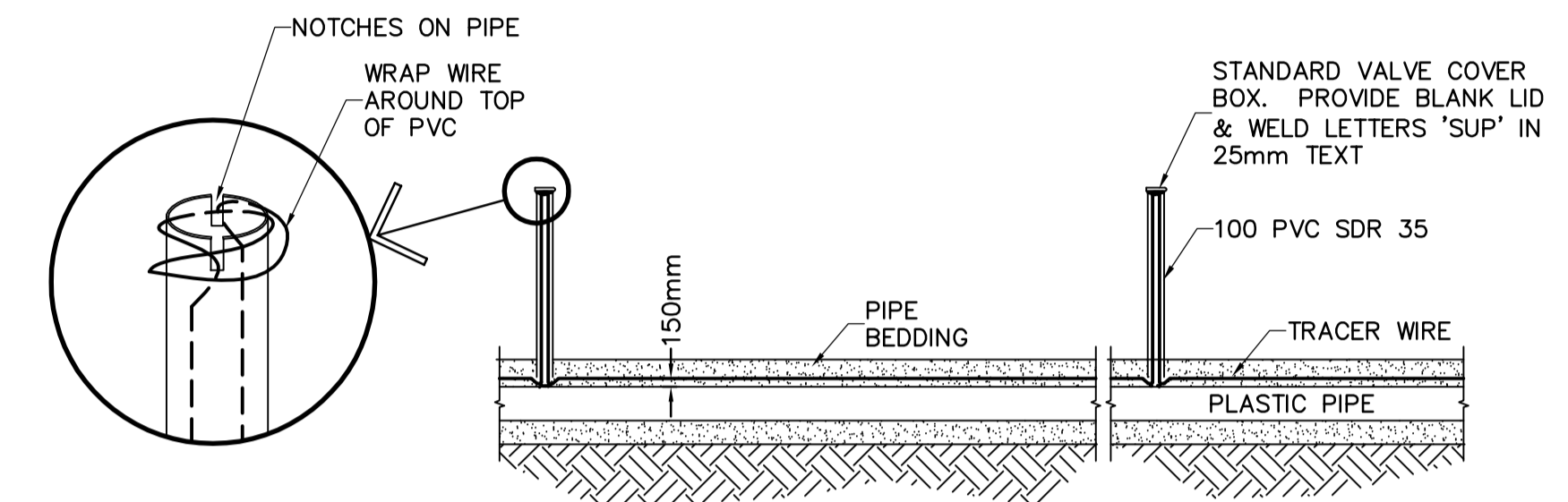

NOTE: LOCATE RISER AT EACH END OF PIPE AND AT 120m INTERVALS.

**1 TRACER WIRE DETAIL**  
 SCALE: NTS

**COORDINATE TABLE**

DESCRIPTION	NORTHING	EASTING
750 CONNECTION STA. 1+02.104	5524054.091	647844.571
750x750x750 TEE STA. 1+08.524	5524057.486	647839.124
750-22.5' BEND STA. 1+39.200	5524031.455	647822.896
750-22.5' BEND STA. 1+69.994	5524001.078	647817.846
750-22.5' VERT. BEND STA. 1+73.676	5523997.613	647816.592
750 CONNECTION STA. 1+94.635	5523977.905	647809.460
750 CONNECTION TO 2100 OVERFLOW	5524061.189	647833.185
150 SLUDGE FM. 45' BEND CONNECTION TO AQUEDUCT	5524005.652	647819.417
	5523979.197	647809.928

**JOINT RESTRAINTS**

ALL JOINTS WITHIN THE FOLLOWING AREAS SHALL BE RESTRAINED WITH JOINTS RESTRAINT HARNESSSES

PIPE	FROM STA.	TO STA.
150 SLUDGE FORCEMAIN	1+06.276	1+15.585
	1+37.041	1+41.041
	1+63.218	1+67.218
750 SUPERNATANT	1+35.200	1+43.200
	1+65.994	1+82.256

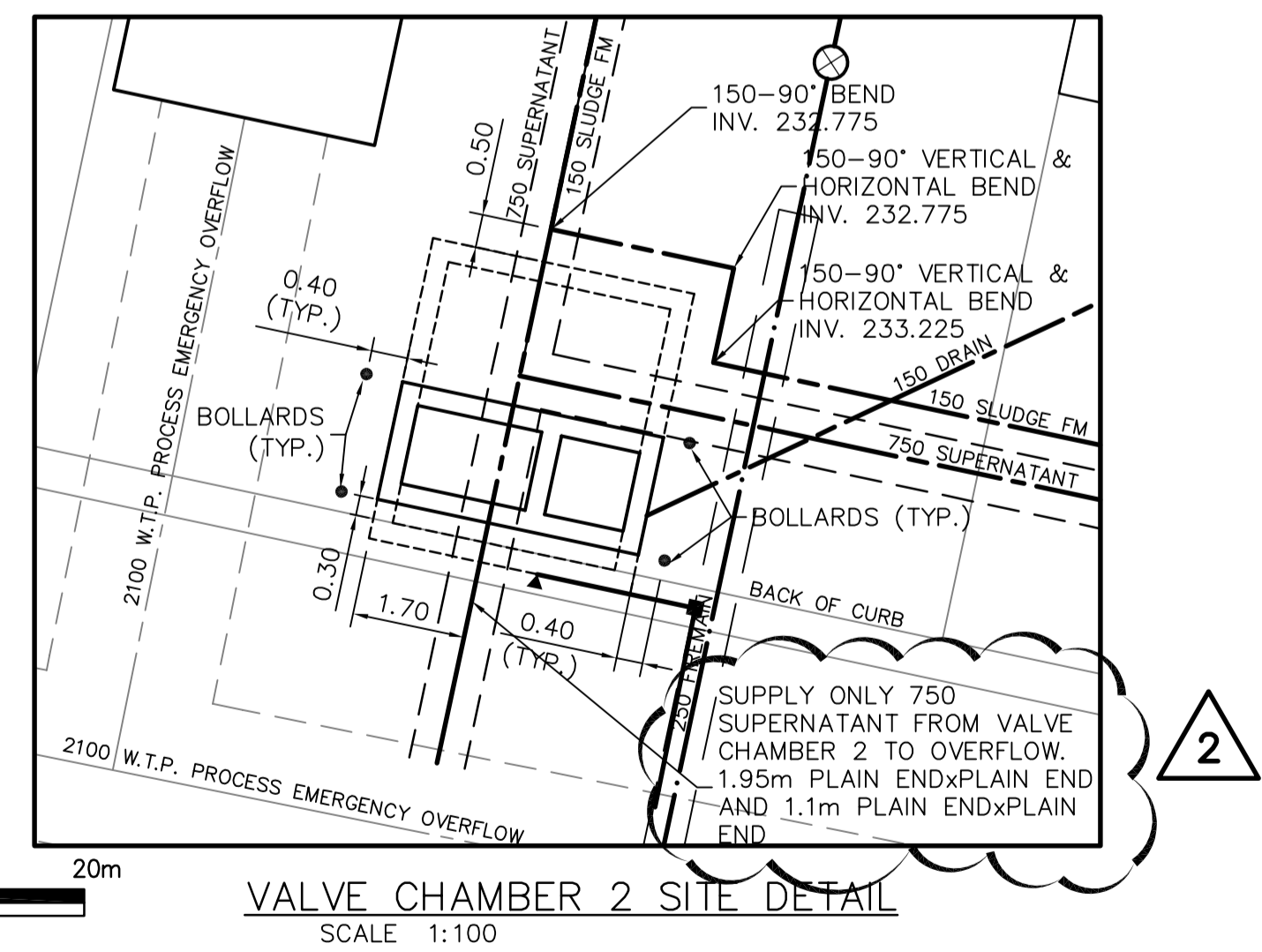
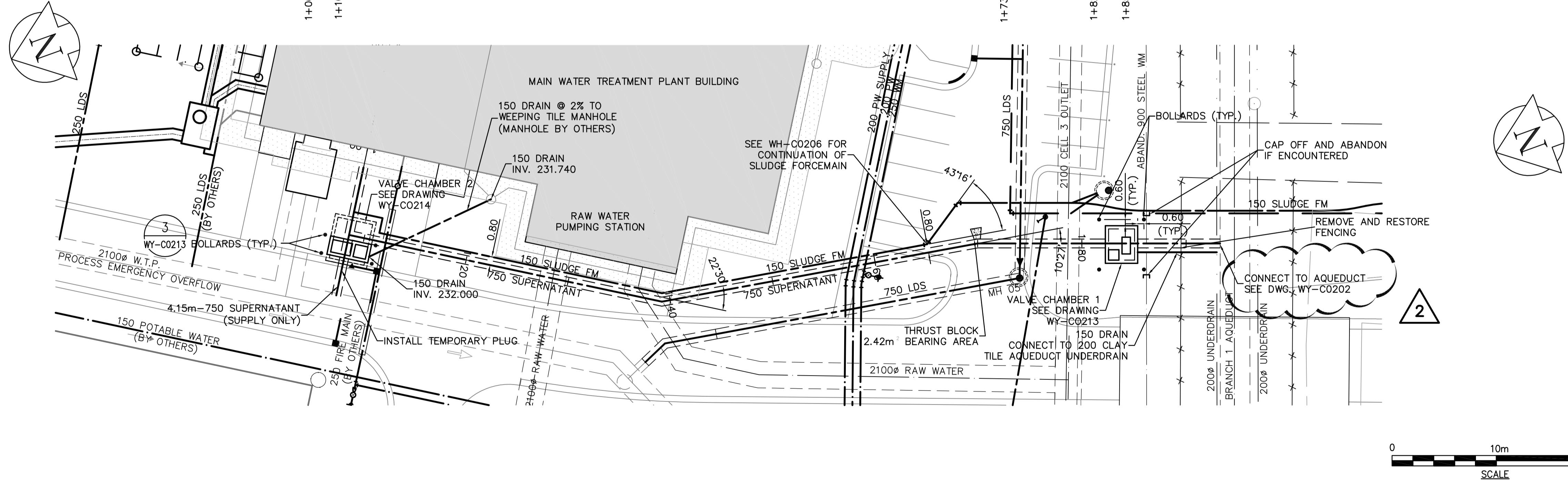

EXISTING	LEGEND - PLAN	PROPOSED	EXISTING	LEGEND - PLAN	PROPOSED	EXISTING	LEGEND - PLAN	PROPOSED
150 mm W.M.	WATERMAIN	150 mm W.M.	HYDRO M.T.S.	---	---	---	LIGHT STANDARD ANCHOR	---
300mm L.D.S.	VALVE	300mm L.D.S.	CONCRETE ASPHALT	---	---	---	POLE CONTOURS	---
250mm W.W.S.	LAND DRAINAGE SEWER	250mm W.W.S.	PROPERTY LINE	---	---	---	RAIL X-ING SIGNAL	---
250mm W.W.S.	WASTEWATER SEWER	250mm W.W.S.	SURVEY BAR	---	---	---	RAILWAY TRACK	---
---	MANHOLE	---	ELEVATION	---	---	---	DITCH	---
---	CATCH BASIN	---	TREE ANODE	---	---	---	---	---
---	CURB INLET	---	CONCRETE SIDEWALK	---	---	---	---	---
---	JUNCTIONS	---	FENCE	---	---	---	---	---
---	CULVERT	---	---	---	---	---	---	---
---	GAS	---	---	---	---	---	---	---

**APEGM**  
 Certificate of Authorization  
 Earth Tech Canada Inc.  
 No. 730 Expiry: April 30, 2007

**CH2MHILL**  
 Frederickson Cooper  
 ARCHITECTS

**EarthTech**  
 A Tyco International Ltd. Company

ENGINEER'S SEAL  
 ORIGINAL SIGNED BY  
 K.W. FITCHETT  
 2007/01/26

WATER TREATMENT PLANT SITE UTILITIES  
 CIVIL  
 SUPERNATANT LINE/ 150 SLUDGE FORCEMAIN  
 WTP MAIN BUILDING TO AQUEDUCT

NO.	REVISIONS	DATE	BY
02	94-2007 ADDENDUM 3	07/06/05	GSK
01	ISSUED FOR TENDER (94-2007)	07/04/05	GSK
00	ISSUED FOR TENDER	07/01/26	GSK

DATE	SCALE	DATE	SCALE
2005/11/21	1:250 HOR 1:50 VER	2006/01/26	RELEASED FOR CONSTRUCTION BY: R. SOROKOWSKI