

- NOTE:**
- STATION CHAINAGE IS BASED ON CENTERLINE OF ALLEY RIGHT OF WAY.
  - ADJUST MH AND CB RIMS TO NEW GRADES.
  - PLUG SUBDRAINS AT TERMINAL ENDS.
  - REGRADE EXISTING PRIVATE SIDEWALKS AS REQUIRED.
  - INSTALLATION OF LIP CURBS AND THEIR EXTENTS TO BE DETERMINED BY THE CONTRACT ADMINISTRATOR.
  - LIGHT STANDARDS, HYDRO POLES AND ANCHORS MAY REQUIRE TEMPORARY SUPPORT/REMOVAL OR REPLACEMENT AT THE CONTRACTOR'S EXPENSE.
  - ISOLATE ALL POLES, BASES AND PILES WITHIN ALLEY RIGHT OF WAY (SD-228C).
  - AVOID DAMAGE TO EXISTING TREES WITHIN THE LIMITS OF CONSTRUCTION.

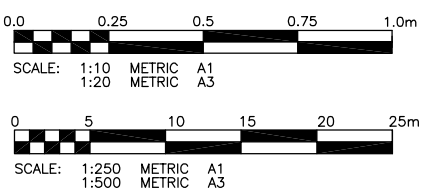
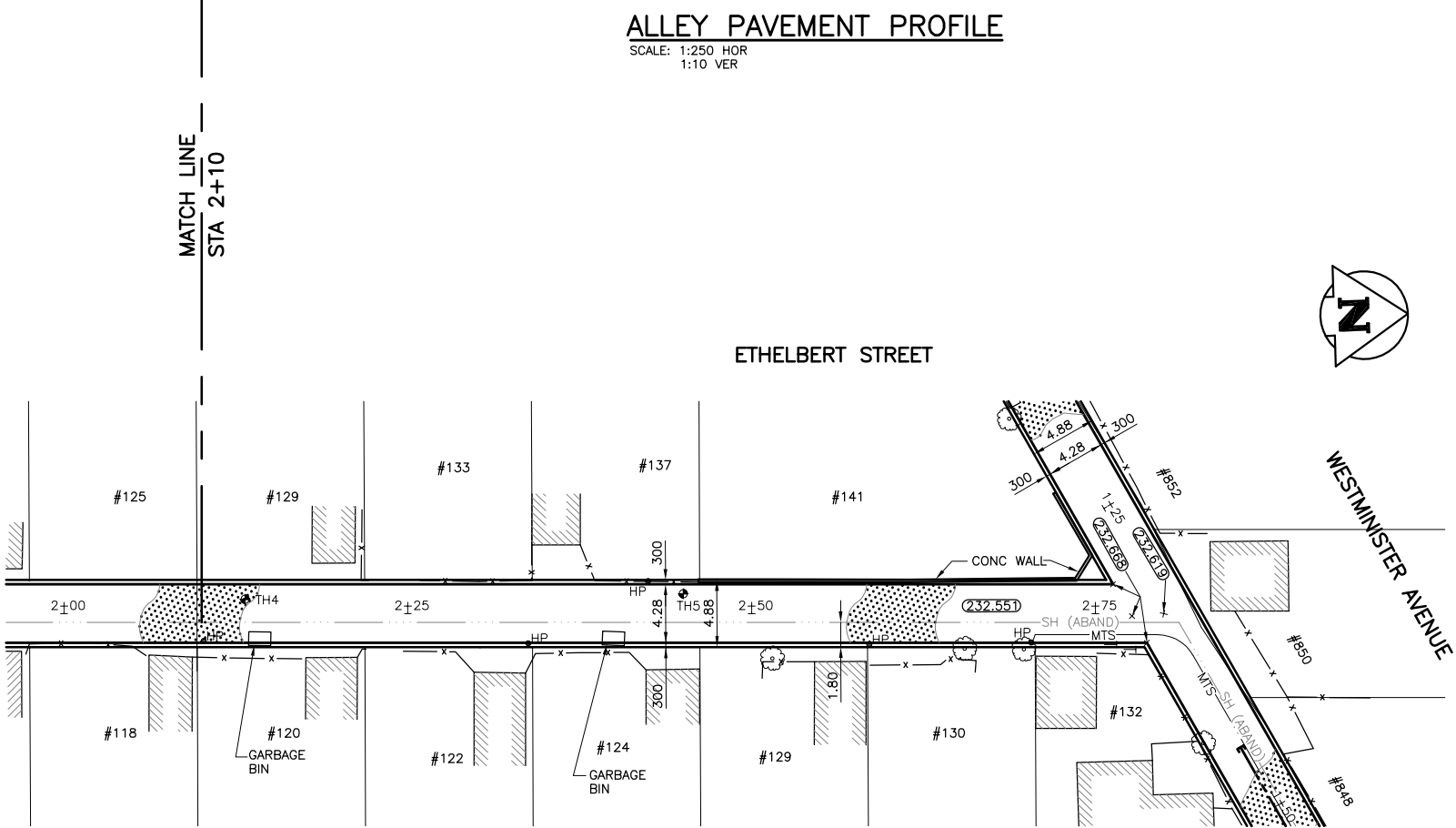

**METRIC**  
WHOLE NUMBERS INDICATE MILLIMETRES  
DECIMALIZED NUMBERS INDICATE METRES

**APEGM**  
Certificate of Authorization  
**KGS Group**  
No. 245 Expiry: April 30, 2007

**WARNING**  
IF POWER EQUIPMENT OR EXPLOSIVES ARE TO BE USED FOR EXCAVATION ON THIS PROJECT THE CONTRACTOR MUST:  
1) NOTIFY THE GAS COMPANY OF THE PROPOSED LOCATION OF EXCAVATION.  
2) TAKE PRECAUTION TO AVOID DAMAGE TO GAS COMPANY INSTALLATIONS.  
SEE PROVINCIAL REGULATION 210/72 FOR DETAILS.

300 LBS	LAND DRAINAGE SEWER	300 LBS		TEST HOLE		
250 WWS	WASTE WATER SEWER	250 WWS		GUY WIRE		
				LIGHT STANDARD		
				BACK OF CURB		
				CONCRETE		
150 WM	WATERMAIN	150 WM		ASPHALT		W. CONC DR/PARK
				VALVE		E. CONC DR/PARK
				MANHOLE		W. BLDG
				CATCH BASIN		E. BLDG
				CURB INLET		Q. PROFILE
				POLES		N/W LANE EDGE
EXISTING	LEGEND-PLAN	PROPOSED	EXISTING	LEGEND-PLAN	PROPOSED	S/E LANE EDGE

**LOCATION APPROVED UNDERGROUND STRUCTURES**

Supv. U/G STRUCTURES DATE COMMITTEE

**NOTE:**  
LOCATION OF UNDERGROUND STRUCTURES AS SHOWN ARE BASED ON THE BEST INFORMATION AVAILABLE BUT NO GUARANTEE IS GIVEN THAT ALL EXISTING UTILITIES ARE SHOWN OR THAT THE GIVEN LOCATIONS ARE EXACT. CONFIRMATION OF EXISTENCE AND EXACT LOCATION OF ALL SERVICES MUST BE OBTAINED FROM THE INDIVIDUAL UTILITIES BEFORE PROCEEDING WITH CONSTRUCTION.

NO.	REVISIONS	DATE	BY
0	ISSUED FOR TENDER	06/02/07	CR
A	ISSUED FOR REVIEW	26/01/07	CR

**KGS CONSULTING ENGINEERS & PROJECT MANAGERS GROUP**

WINNIPEG (204) 896-1209  
THUNDER BAY (807) 345-2233

DESIGNED BY	RO	CHECKED BY	CR
DRAWN BY	DW	APPROVED BY	

HOR. SCALE: 1:250  
VERTICAL: 1:50

DATE: 05/01/07

ENGINEER'S SEAL

ORIGINAL SIGNED BY **M.C. ROWBOTHAM** FEB 07/2007

CONSULTANT DRAWING NO. **06-0107-18**

**THE CITY OF WINNIPEG**  
PUBLIC WORKS DEPARTMENT  
ENGINEERING SERVICES DIVISION

PROJECT TITLE  
**2007 ALLEY RENEWAL PROGRAM**  
**ETHELBERT ST/CANORA ST ALLEY**  
**WOLSELEY AVE NORTH ALLEY**  
**TO WESTMINSTER AVE SOUTH ALLEY**  
**STA. 2+10 TO STA. 2+77.85**

SHEET **03** OF **09**

COMPUTER FILE NAME: **06-0107-18**

CITY DRAWING NUMBER: **0003**