

NOTE: CHAINAGES SHOWN ARE ALONG E. R. OF BOURNAIS DR.

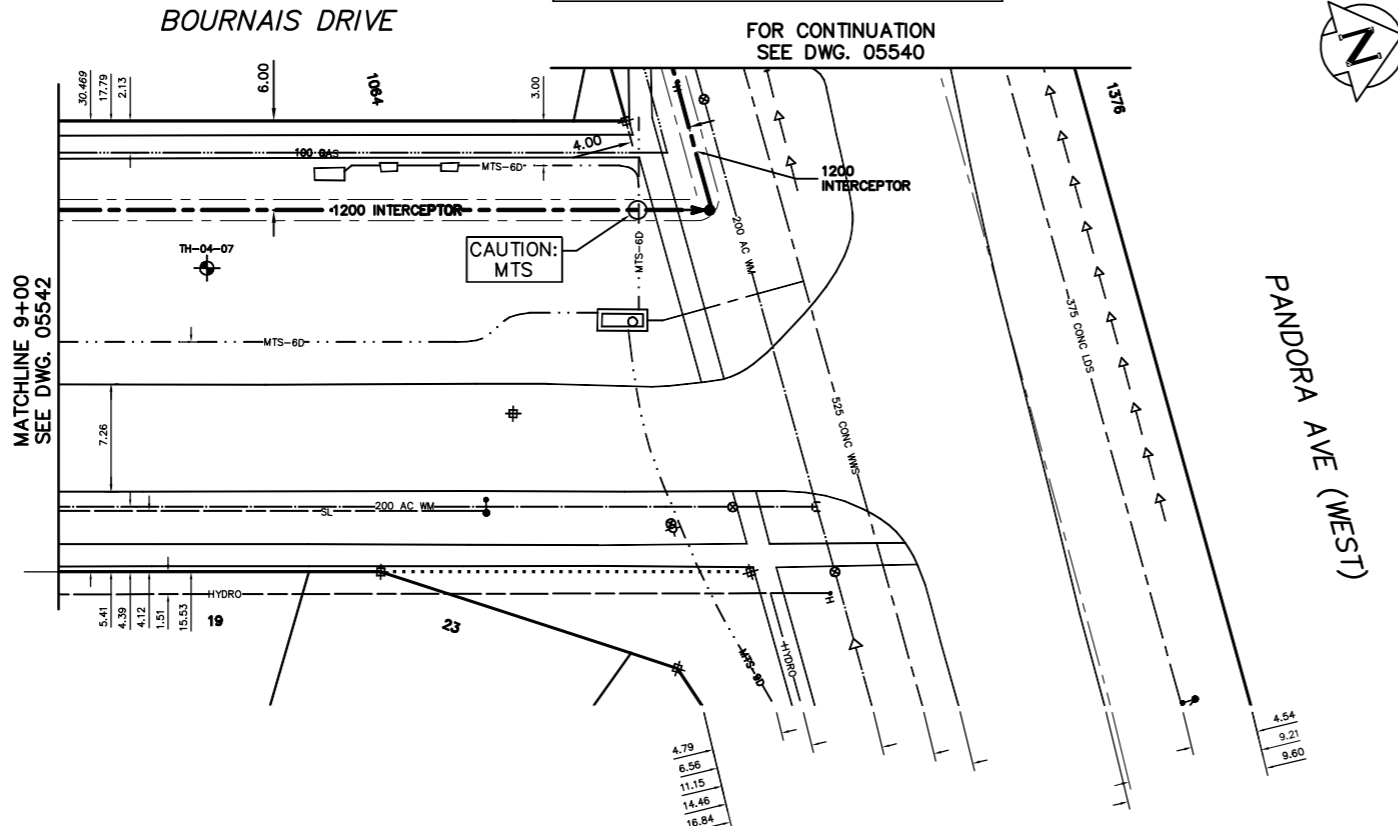

SEWER SERVICE INFORMATION		
ADDRESS	SIZE	R DIST JUNCTION TIE
19 SIMS CR RESIDENTIAL		SERV. OFF SIMS
23 SIMS CR RESIDENTIAL		SERV. OFF SIMS
1064 PANDORA AVE RESIDENTIAL	5.60 WEL HSE	5.60 E MH @ OWENS
1376 REGENT AVE COMMERCIAL		SERV. OFF REGENT

FOR CONSTRUCTION NOTES SEE DRAWING 05533

METRIC
WHOLE NUMBERS INDICATE MILLIMETRES
DECIMALIZED NUMBERS INDICATE METRES

WARNING
IF POWER EQUIPMENT OR EXPLOSIVES ARE TO BE USED FOR EXCAVATION ON THIS PROJECT THE CONTRACTOR
LOCATION OF EXCAVATION.
1) NOTIFY THE GAS COMPANY OF THE PROPOSED
2) TAKE PRECAUTION TO AVOID DAMAGE TO GAS COMPANY INSTALLATIONS.
SEE PROVINCIAL REGULATION 210/72 FOR DETAILS



200 WM	WATERMAIN	200 WM	SL, HYDRO	150 WM	WATERMAIN	150 WM
+	HYDRANT	+	MTS	- - - - -	HYDRANT	+
o	VALVE	o	TRAFFIC SIGNALS	---x---	VALVE	+
525 LDS	LAND DRAINAGE SEWER	525 LDS	GAS	50 GAS	300 LDS	LAND DRAINAGE SEWER
375 WWS	WASTEWATER SEWER	375 WWS	SURVEY BAR	250 WWS	WASTEWATER SEWER	250 WWS
o	MANHOLE	o	FENCE	x	@ PROFILE	
□	CATCH BASIN	□	* H * T	POLE - HYDRO, MTS	@ DITCH (NORTH & WEST)	
▽	CURB INLET	▽	o	CURB STOP	@ DITCH (SOUTH & EAST)	
+	JUNCTIONS	+	o	GUY ANCHOR		
+	CULVERT	+	o	LIGHT STANDARD		
+	ANODE	+	o	TREE		
---	EXISTING	---	---	EXISTING	---	---
---	LEGEND-PLAN	---	---	PROPOSED	---	---
---		---	---	EXISTING	---	---
---		---	---	PROPOSED	---	---

LOCATION APPROVED UNDERGROUND STRUCTURES

SUPV. U/G STRUCTURES COMMITTEE DATE

NOTE:
LOCATION OF UNDERGROUND STRUCTURES AS SHOWN ARE BASED ON THE BEST INFORMATION AVAILABLE BUT NO GUARANTEE IS GIVEN THAT THE GIVEN LOCATIONS ARE EXACT. CONFIRMATION OF EXISTENCE AND EXACT LOCATION OF ALL SERVICES MUST BE OBTAINED FROM THE INDIVIDUAL UTILITIES BEFORE PROCEEDING WITH CONSTRUCTION.

B.M. ELEV. FIELD BOOK #

POSTED TO LIS

1.) REVISION - MH BASE DIAMETER 05.04.11 SC

NO. REVISIONS DATE BY

CITY OF WINNIPEG WATER AND WASTE ENGINEERING DIVISION

DESIGNED BY SC CHECKED BY TW

DRAWN BY CJH APPROVED BY KZ

HOR. SCALE 1:250
VERTICAL 1:50

RELEASED FOR CONSTRUCTION
DATE 2005 03 31

ENGINEER'S SEAL

ORIGINAL SIGNED BY K.R. ZUREK 05/03/31

BID OPPORTUNITY: 93-2005
PLOT DATE: 2005 04 12

THE CITY OF WINNIPEG WATER AND WASTE DEPARTMENT

NORTHEAST INTERCEPTOR
STAGE VII
BOURNAIS DRIVE
PANDORA AVENUE (WEST) TO
38 m S OF SR PANDORA AVENUE

SHEET 9 OF 18
CITY DRAWING NUMBER 05541